

Heatshrinkable Moulded Shapes Bulbous Boots 3-Way Outlet HellermannTyton

DRAWING No.
152040

SHT. 1
OF
1 SHTS.

© THE COPYRIGHT OF THIS DRAWING IS RESERVED BY HELLERMANN TYTON. IT IS ISSUED ON CONDITION THAT IT IS NOT COPIED, REPRODUCED OR DISCLOSED TO A THIRD PARTY EITHER WHOLLY OR IN PART WITHOUT THE CONSENT IN WRITING OF HELLERMANN TYTON.

THIRD ANGLE PROJECTION

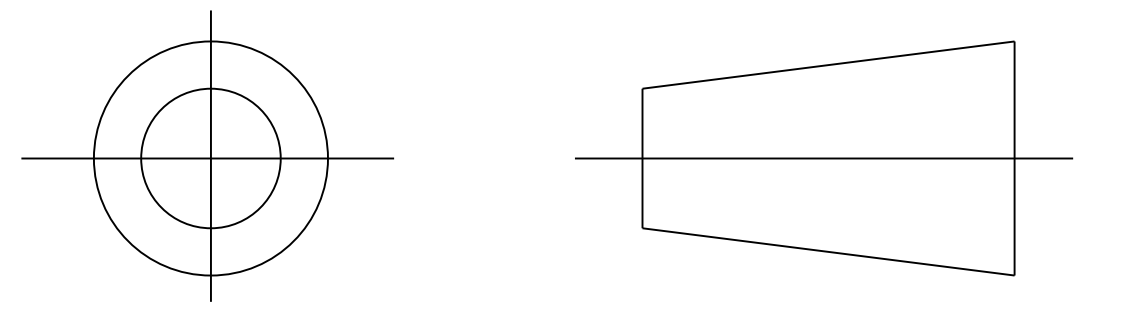

BS 8888

DO NOT SCALE
IF IN DOUBT ASK

| | |
|----------|---------------------|
| Q.A. | H/S SETT |
| H/S Q.A. | REL. INSP. |
| H/S PROD | EXT. ISS. CODE 2/12 |

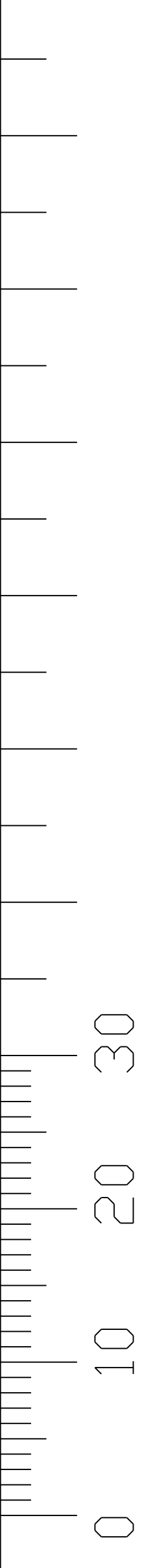

STANDARD PART (AFTER UNRESTRICTED RECOVERY)

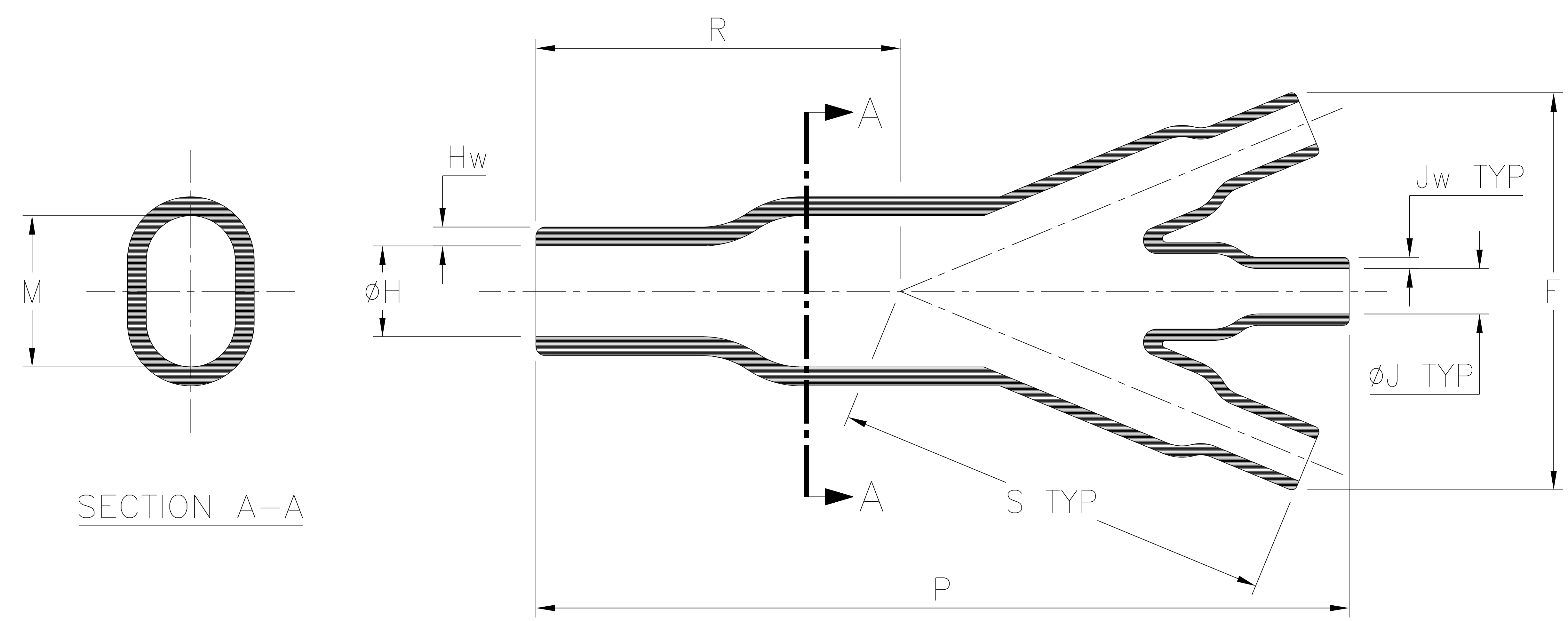

EXPANDED (AS SUPPLIED)

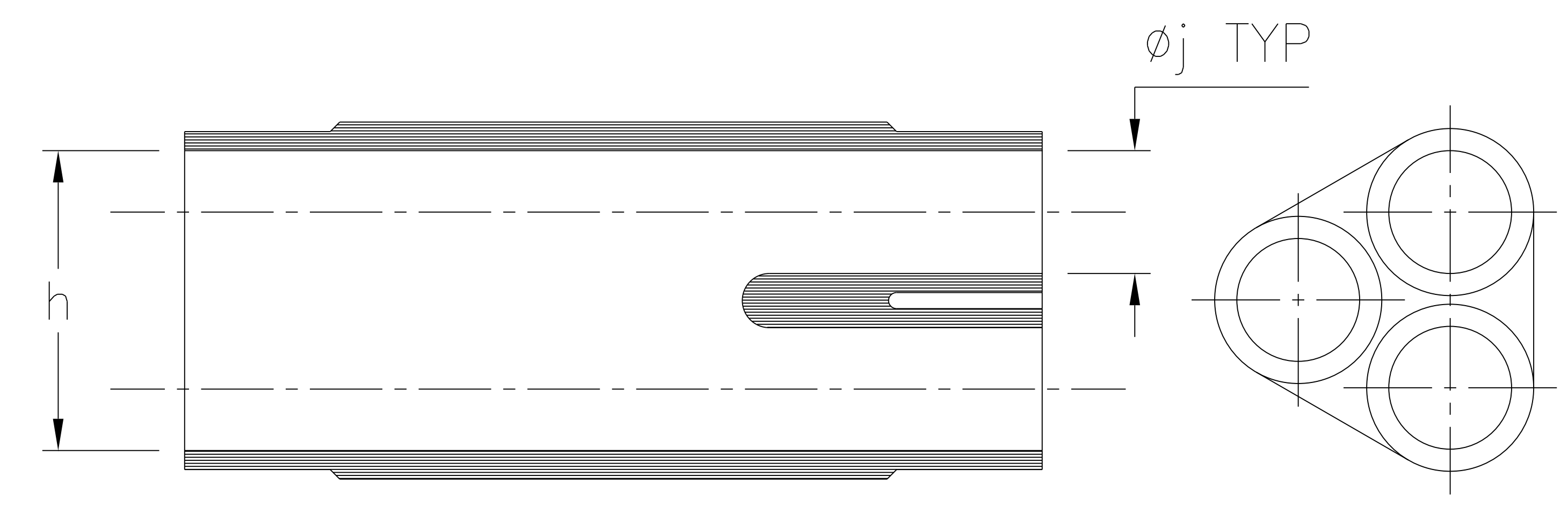

OPTION TO STANDARD PART
FILLER PORT (CODE P)

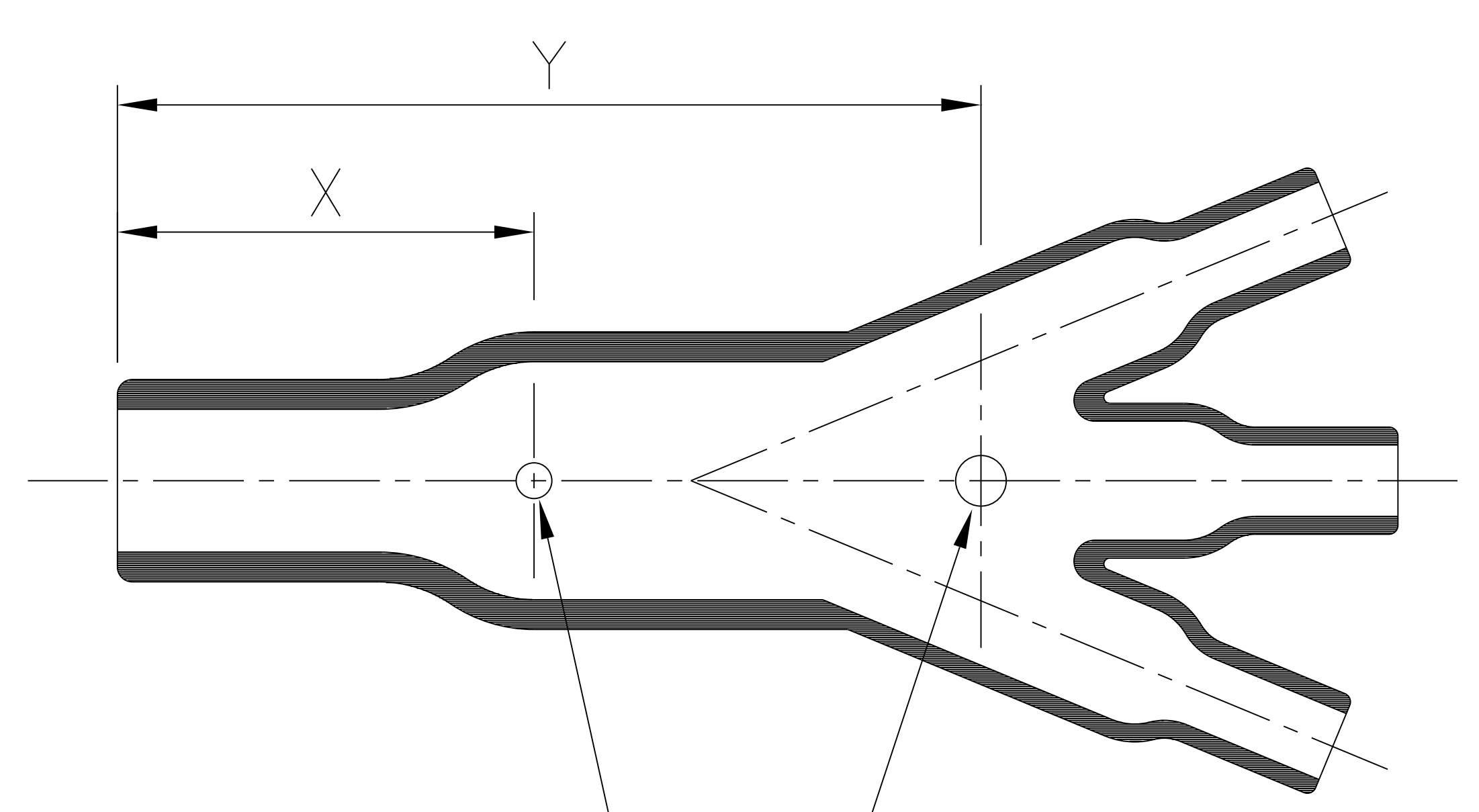

1 DRAIN HOLE
ø3.0 NOM (.12)
1 FILLER PORT
ø4.5 NOM (.18)

| SPEC. | PART NO. | EXPANDED DIMENSIONS (AS SUPPLIED) | | RECOVERED DIAMETERS | | RECOVERED DIMENSIONS | | | | | | |
|----------------------|----------|-----------------------------------|-------------|---------------------|-------------|----------------------|--------------|---------------|--------------|--------------|--------------|--------------|
| | | h | øj | øH | øJ | F | M | P | R | S | Hw | Jw |
| | | MIN | MIN | MAX | MAX | ±15% | MAX | ±10% | ±10% | ±10% | ±30% | ±30% |
| VG 95343 T08D003A | 310-1 | 38.5 (1.52) | 19 (.75) | 19 (.75) | 10 (.39) | 87 (3.43) | 34 (1.34) | 135 (5.31) | 62 (2.44) | 74 (2.91) | 3.0 (.12) | 2.0 (.08) |

| OPTIONAL FILLER PORT DETAIL | | | |
|-----------------------------|----------|----------------------|--------------|
| SPEC. | PART NO. | RECOVERED DIMENSIONS | |
| | | X | Y |
| | | ±10% | ±10% |
| - | 310-1 | 48 (1.89) | 82 (3.23) |

Heatshrinkable Moulded Shapes Bulbous Boots 3-Way Outlet HellermannTyton For information only, not subject to technical changes.

| | | | |
|-------|----------|----------|----------|
| 2 | P1503 | CM | 28/04/15 |
| 1 | P1186 | S.Almond | 27/03/08 |
| ISSUE | NOTE No. | DRAWN | DATE |

HellermannTyton
William Prance Road,
Plymouth International Med. & Tech. Park,
Plymouth, PL6 5WR
Tel ++44 (0) 1752 701261
Fax ++44 (0) 1752 790058

| | | | | | | |
|-------|---------------------|---------|------------|----------|--|-------------------------|
| NAME | S.Almond | SCALE | NTS | ADHESIVE | A3 ORIGINAL SHEET SIZE 420mm x 297mm | SHT. 1 OF 1 SHTS. |
| DATE | 27/03/08 | DIMS IN | mm (in) | | | |
| TITLE | 3 WAY OUTLET SLEEVE | | PART No. | 310 | DRAWING No. 152040 | |