

U.I. Lapp GmbH	PRODUCT INFORMATION	
	EPIC® H-A 3 MTG	05.11.2015

Innovative metal and plastic housing design
Housing in plastic or metal version. For power supply in the smallest possible space



Industrial machinery and plant engineering



Mechanical resistance



Robust



Waterproof



Application range

Machine and equipment manufacturing
Control engineering
Electronic laboratory

Product features

Hood
Bolts for single lever
Straight cable entry
Versions with / without cable gland

Remark

Photographs are not to scale and do not represent detailed images of the respective products.

Technical Data

Material:	Housing: powder-coated zinc die-casting, grey Lever: zinc-plated steel
Protection rating:	IP 65 (latched)
Temperature range:	-40°C to +100°C, short-term up to +125°C
VDE-tested:	Certified production control: VDE-REG. no.: B437 UL-tested: UL File Number: E75770

Product Management	Document: LAPP_PRO125868EN.pdf	1 / 3
--------------------	--------------------------------	-------



Part number	Article description	M	PG	Material	Colour	Cable gland	Cable clamping range	Dimensions incl. cable gland	Pieces / PU
H-A housing: hood (straight cable entry)									
10512100	H-A 3 MTgv		11	Zinc die-casting	grey				10
10426500	H-A 3 MTgv		11	Zinc die-casting	grey	yes	6,5 - 12	57	10
19512100	H-A 3 MTgv M20	20		Zinc die-casting	grey				10
19426500	H-A 3 MTgv M20	20		Zinc die-casting	grey	yes	3 - 13,5	57	10

U.I. Lapp GmbH	PRODUCT INFORMATION	 LAPP GROUP
EPIC® H-A 3 MTG		05.11.2015

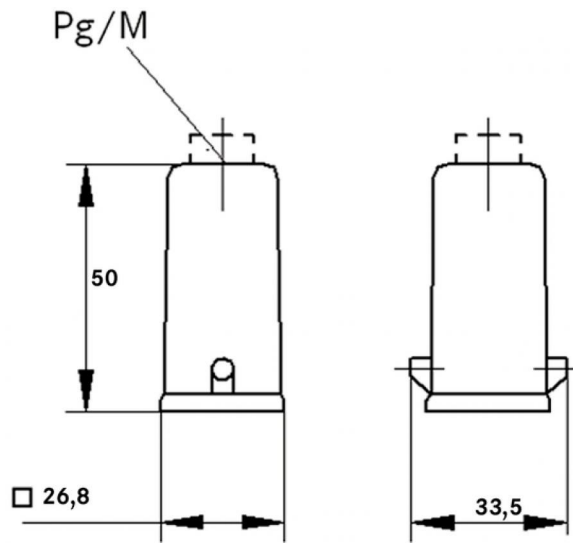

Product Management	Document: LAPP_PRO125868EN.pdf	3 / 3
--------------------	--------------------------------	-------