



DESC: 20/6 AWM 20233 (1 SHIELDED PAIR) 80C 300V

DWG NO: 2006A010.dwg

SCALE: 15x

DATE: 07/15/05

DR. BY: KJ RECTOR

NWI NO: SEE BELOW

ITEM SPECS.

- A. 20 AWG 26X34TC BUNCHED
 - B. 9 MIL MINIMUM AVERAGE HYTREL INSULATION
7 MIL MINIMUM HYTREL INSULATION STYLE #10911
OD .059±.002" 105°C 300V
 - C. SUB ASSEMBLY A
 - D. POLY FILLER
 - E. PTFE TAPE WRAP
 - F. TISSUE PAPER SEPARATOR
 - G. 30 MIL MINIMUM AVERAGE PRESSURED POLYURETHANE JACKET
24 MIL MINIMUM PRESSURED POLYURETHANE JACKET
COLOR BLACK 80°C 300V
- CABLE IS UL AND CSA RECOGNIZED

SUB ASSEMBLY A

- C1. 20 AWG 26X34TC BUNCHED
- C2. 9 MIL MINIMUM AVERAGE HYTREL INSULATION
7 MIL MINIMUM HYTREL INSULATION STYLE #10911
OD .059±.002" 105°C 300V
- C3. 20 AWG 7X.0121"TC DRAIN WIRE
- C4. ALUMINUM MYLAR SHIELD

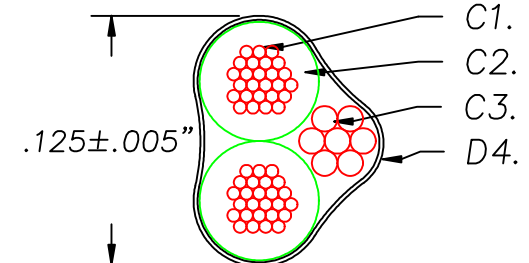

ELECTRICAL REQUIREMENTS:
NONE SPECIFIED

MECHANICAL REQUIREMENTS:
NONE SPECIFIED

OSCEOLA P/N: FAWM206-015
SANTA TERESA P/N: FAWM206-015N

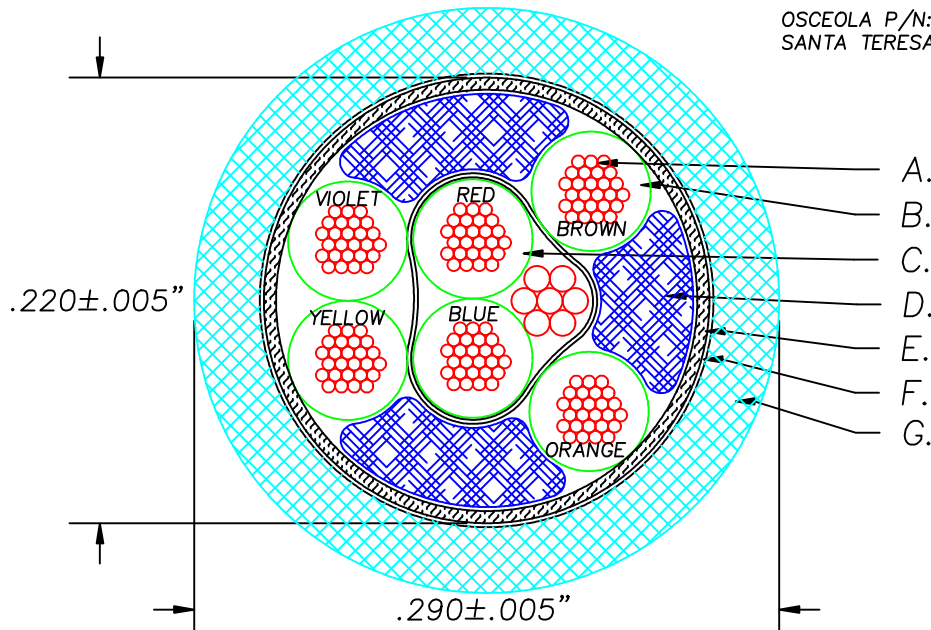

WHITE INK PRINTED LEGEND TO READ:

OSCEOLA: RU AWM E54661 80C 300V CSA AWM LL54185 I/II A/B 80C 300V FT1

SANTA TERESA: RU AWM E54661-02 80C 300V "CSA-C/US" AWM LL54185 (02) I/II A/B 80C 300V FT1

CHG STYLE FR 21002 & TEMP FROM 105C	E	07/01/14	GM	
Added 300V on UL side of ST legend.	D	12/31/13	MK	
REMOVED DEGREE SYMBOL FROM LEGEND	C	10/28/08	KJR	
ADDED LEGEND	B	07/21/05	KJR	
INITIAL RELEASE	A	07/15/05	KJR	
REVISION RECORD	REV	REV DATE	APPROVAL	APPROVAL