

DRAWING No.  
**152167**

SHT. 1  
OF  
1 SHTS.

© THE COPYRIGHT OF THIS DRAWING IS RESERVED BY HELLERMANN TYTON. IT IS ISSUED ON CONDITION THAT IT IS NOT COPIED, REPRODUCED OR DISCLOSED TO A THIRD PARTY EITHER WHOLLY OR IN PART WITHOUT THE CONSENT IN WRITING OF HELLERMANN TYTON.

THIRD ANGLE PROJECTION

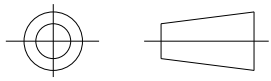

BS 8888

DO NOT SCALE  
IF IN DOUBT ASK

Q.A.	H/S SETT
H/S Q.A.	REL. INSP.
H/S PROD	EXT.ISS.CODE
	4/8

STANDARD PART (AFTER UNRESTRICTED RECOVERY)

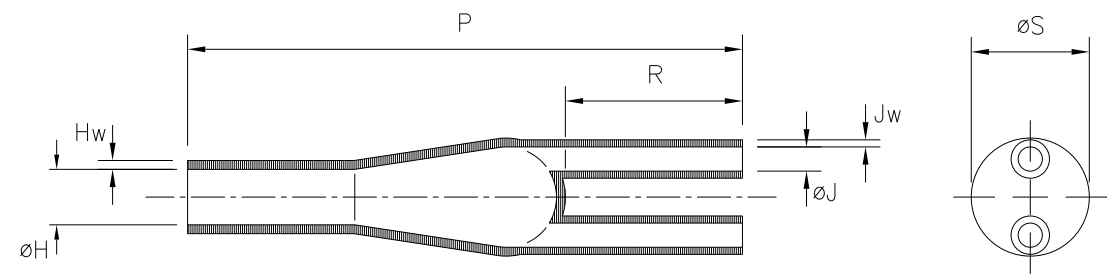

EXPANDED (AS SUPPLIED)

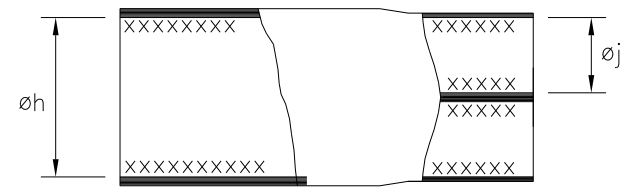

HOT MELT ADHESIVE APPLICATION DETAILS

ADHESIVE REFERENCES:  
W – ALL INTERNAL SURFACES COATED  
W1 – PARALLEL INTERNAL SURFACES COATED ONLY

PART No.	EXPANDED DIAMETERS (AS SUPPLIED)		RECOVERED DIAMETERS		RECOVERED DIMENSIONS				
	øh	øj	øH	øJ	P	R	S	Hw	Jw
	MIN	MIN	MAX	MAX	±10%	±10%	NOM	±20%	±30%
223-2	33.0 (1.30)	17.5 (0.69)	9.4 (0.37)	4.1 (0.16)	94.0 (3.70)	30.0 (1.18)	20.0 (0.79)	1.5 (0.06)	1.2 (0.05)
223-3	33.0 (1.30)	17.5 (0.69)	9.4 (0.37)	4.1 (0.16)	60.0 (2.36)	30.0 (1.18)	20.0 (0.79)	1.5 (0.06)	1.2 (0.05)

2	P1256	L.F.	09/02/09
1	P1236	G.B.	16/09/08
ISSUE	NOTE No.	DRAWN	DATE

**HellermannTyton**

Pennycross Close, Plymouth, Devon, England  
Tel ++44 (0) 1752 701261 Fax ++44 (0) 1752 790058

NAME	G.BASER	SCALE	NTS	ADHESIVE	A3 ORIGINAL SHEET SIZE 420mm x 297mm	SHT. 1 OF 1 SHTS.
DATE	16/09/08	DIMS IN	mm (in)			
TITLE	2 WAY OUT SLEEVE			PART No.	DRAWING No.	
				223	152167	