

2400-308

ON

LTR	ECA NO.	REVISION	ENG	DATE
A	17798	RELEASED	KMG	9/29/95
B	18143	ADDED MASK (2 PLCS.), 3.30 & 156 WERE 3.18 & 157	S.Z.	1/24/96
C	18243	ADDED .06 RAD., 2 PLCS.	S.Z.	2/27/96
D	18655	.250 & .21 WERE BOTH .18	S.Z.	5/1/96
E	18875	DELETED (10) 6-32 HOLES AND THEIR DIMS, ADDED (6) 4-40 HOLES AND DIMS	J.S.	6/24/96
E1	43212	RE-DIMENSIONED PART AND ADDED VIEW FOR CLARITY	P.S.	7-17-07
E2	47987	REVISED MASKING AREA DIM AND TOLERANCE	JAP	11-23-11

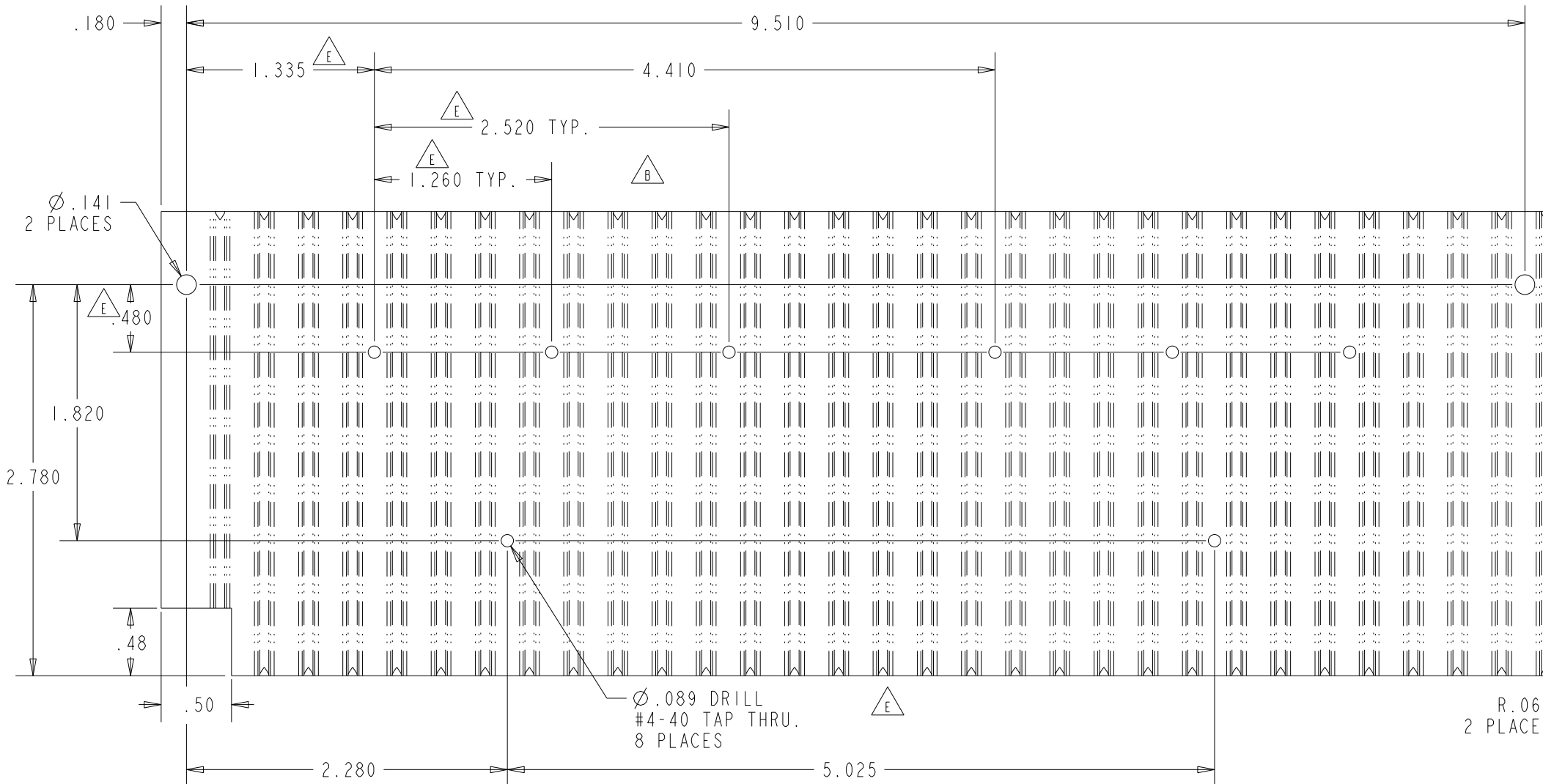
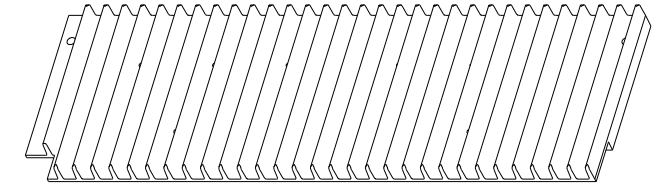
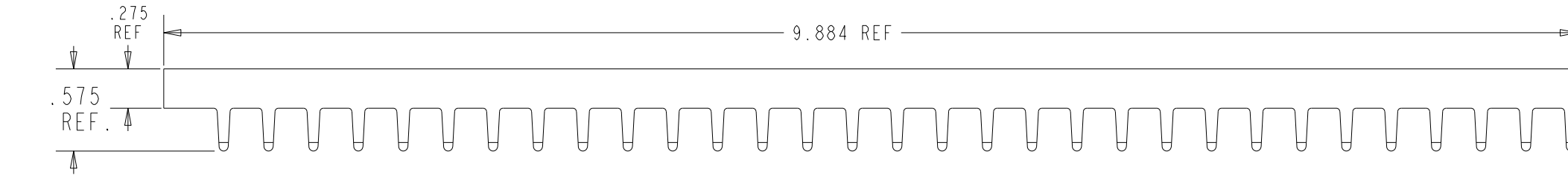

WIDTH: .485 MIN TO .565 MAX  
 HEIGHT: 2.50  
 AREA TO BE FREE OF ANODIZE  
 NEAR SIDE BOTH ENDS OF PART

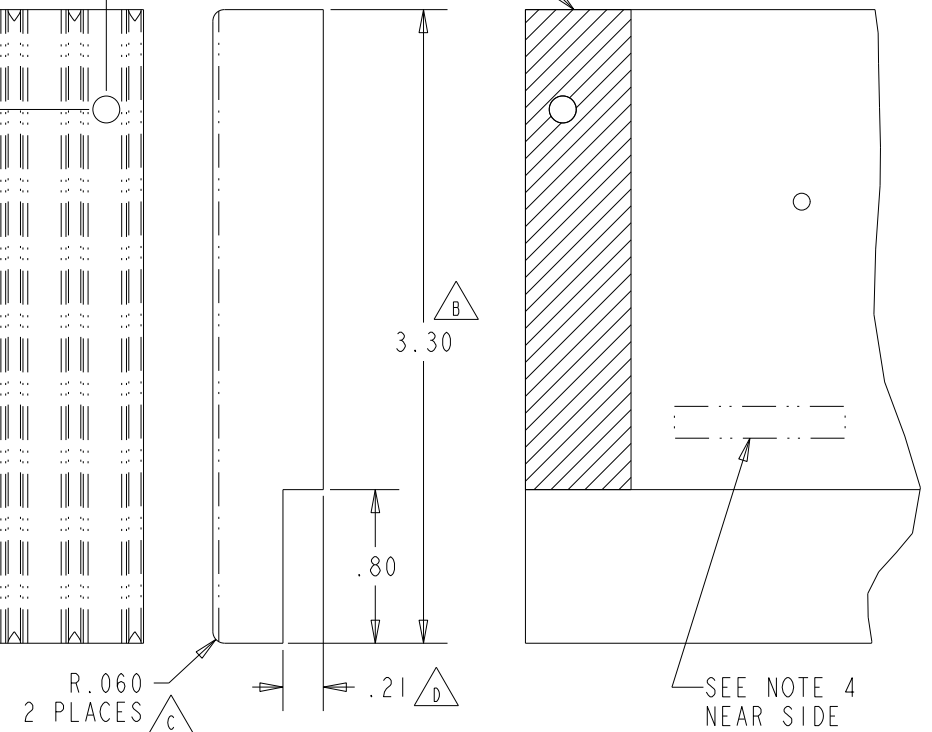

**△E1 PARTIAL REAR VIEW**

NOTES:

- MATERIAL: MAKE FROM AAVID PART #61780
- FINISH: BLACK ANODIZED
- PART TO BE COMPLETELY DEBURRED AND DEGREASED.
- THE KEITHLEY PART NUMBER AND REVISION LETTER SHALL BE PERMANENTLY MARKED IN THE APPROX. LOCATION SHOWN. THE REVISION LETTER SHOULD FOLLOW THE PART NUMBER WITH A SPACE BETWEEN. ALL THE PART NUMBERS SHALL BE .12" TALL.

DO NOT SCALE THIS DRAWING		DIMENSIONAL TOLERANCES UNLESS OTHERWISE SPECIFIED		DATE 9/19/95	SCALE 1:1	TITLE HEAT SINK	
Keithley Instruments Inc. Cleveland, Ohio 44139 <b>CONFIDENTIAL PROPRIETARY</b>	XX = ± .015	ANG. = ± 1°	DRN. P.S.	ENG APPR. KMG	B NO. 2400-308		
	XXX = ± .005	FRAC. = ± 1/64	MATERIAL SEE NOTE 1				
	RoHS COMPLIANT	SURFACE MAX. √63	FINISH SEE NOTE 2				