

NOMINAL DIMENSIONS

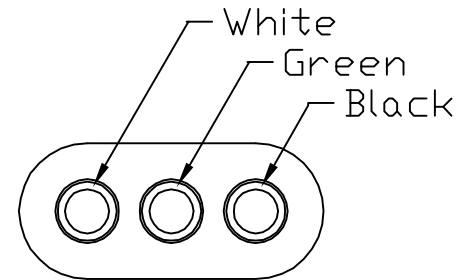
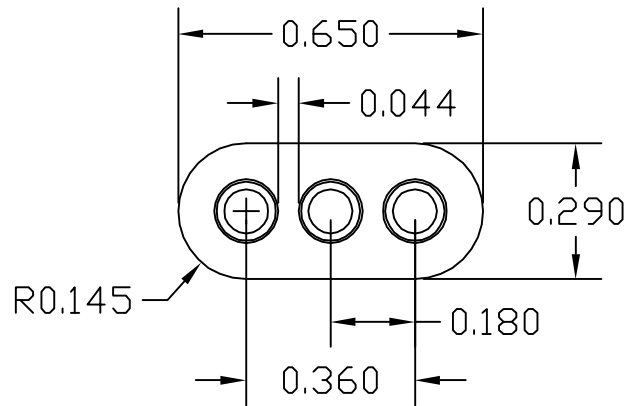

Conductors: 12 AWG, 65/30 stranded BC
 Primary insulation: PVC, 0.016 nom thickness
 Primary jacket: nylon, 0.005 nom thickness
 Cable jacket: TPE, 0.078 nom thickness
 Cable legend: "COLEMAN CABLE 12 AWG 3/C 9U AWM STYLE 21085 600V 105C
 PARALLEL CONVENTION CENTER CABLE FOR TEMPORARY TRADESHOW USE ONLY"
 Cable legend type: indent print

Maximum temperature rating: 105 degC
 Maximum operating voltage: 600VAC

2	2/25/02	ADDED AWM STYLE TO LEGEND
REV	DATE	REVISION
USED ON:		



1586 Lakeside Drive Voice 847.672.2300
 Waukegan, IL 60085 FAX 847.689.9116

CABLE CONSTRUCTION
 12/3 Convention Center

DRAWN BY: RJH	SCALE:
DATE: 9/18/01	DRAWING NUMBER
REVISION: 2	30076