

THE COPYRIGHT OF THIS DRAWING IS RESERVED BY HELLERMANN TYTON. IT IS ISSUED ON CONDITION THAT IT IS NOT COPIED, REPRODUCED OR DISCLOSED TO A THIRD PARTY EITHER WHOLLY OR IN PART WITHOUT THE CONSENT IN WRITING OF HELLERMANN TYTON.

BS 8888 DO NOT SCALE IF IN DOUBT ASK

STANDARD PART (AFTER UNRESTRICTED RECOVERY)

EXPANDED (AS SUPPLIED)

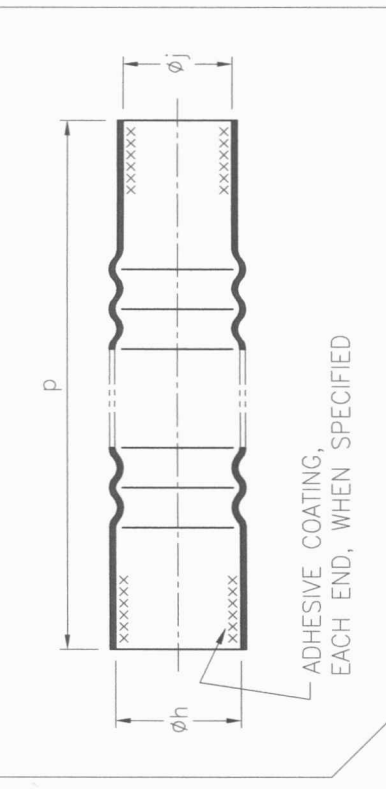
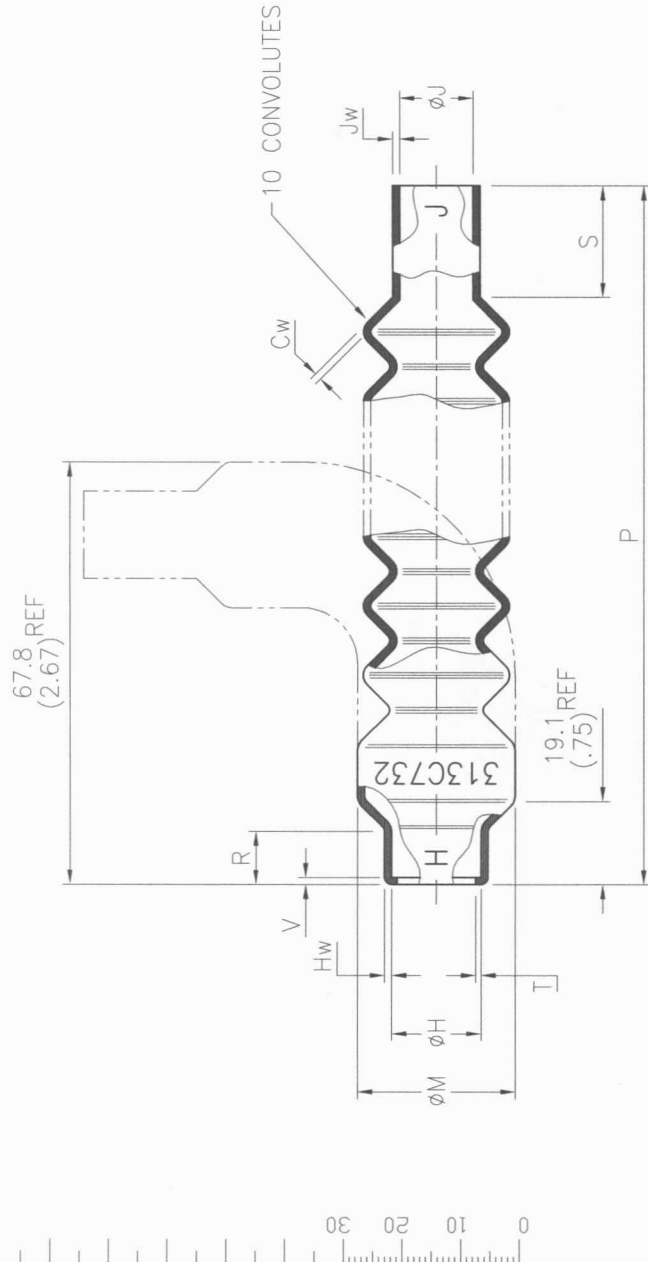

ADHESIVE COATING, EACH END, WHEN SPECIFIED

UNCONTROLLED COPY  
25 OCT 2010

FOR MOULDING PURPOSES ONLY

MOULD SHAPE	øH	øJ	øM	P	R	S	T	V	Cw	Hw,Jw
313C732-*	10.4 (.41)	6.9 (.27)	24.1 (.95)	±6.4 (±.25)	±1.3 (±.05)	±1.8 (±.07)	±0.5 (±.02)	±0.5 (±.02)	±20% (.04)	±20% (.06)

PART NO.	EXPANDED DIMENSIONS (AS SUPPLIED)			RECOVERED DIAMETERS			RECOVERED DIMENSIONS					
	øh	øj	p	øH	øJ	øM	P	R	S	T	V	Cw,Hw,Jw
313C732-*	22.4 (.88)	17.8 (.70)	139.7 ± 19.1 (5.50 ± .75)	11.7 (.46)	8.1 (.32)	26.7 (1.05)	133.4 (5.25)	12.7 (.50)	19.8 (.78)	1.3 (.05)	1.5 (.06)	0.4 (.018)

\* ALL MATERIAL CODES

NAME		S.Almond	SCALE	NTS	ADHESIVE	A3	SHT. 1
DATE	02/04/08	DIMS IN	mm (in)	ORIGINAL SHEET SIZE	420mm x 297mm	DF	1 SHTS.
TITLE		CONVOLUTED BOOT		PART No.	313C732	DRAWING No.	152047
2	P1329	G.B.	11/10/10				
1	P1188	S.Almond	02/04/08				
ISSUE	NOTE No.	DRAWN	DATE				