

1. CONDUCTOR

Material: Heavy Tin Plated Copper
 Construction: 22 AWG 19/34
 Diameter: 0.031"

2. INSULATION

Material: Crosslinked Polyethylene
 Wall thickness: See Table 1
 Diameter: See Table 1
 Color: Black
 Marking: Extruded White Stripe on Center Leg (G)

3. PHYSICAL CHARACTERISTICS

Temperature rating: 135°C
 Voltage rating: 50 V DC
 Weight: 15.3 lbs per 1000 ft

4. PERFORMANCE PROPERTIES

INSULATION

Mechanical – SAE J1128 Type TXL

Tensile Strength
 Unaged 1500 psi, min
 Aged (168 hrs @ 165°C) 80% retention, min
 Elongation
 Unaged 150%, min
 Aged (168 hrs @ 165°C) 50% retention, min
 Crosslinking Core Not Visible

Customer Processing
 Sections must separate without exposing conductor

Electrical - SAE J1128

Dielectric Strength 1000V, 60 Hz, 60 Sec
 Spark Test 3000V_{ac}
 Conductor (ASTM B3)
 DC Resistance 15.0 Ohms per 1000 ft

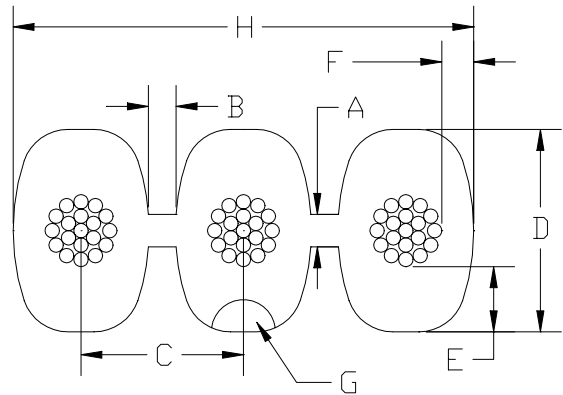

PERFORMANCE PROPERTIES (cont'd)

Thermal - SAE J1128

Flame Resistance 70 Sec Burn, Max

Chemical - SAE J1128

Fluid Compatibility O.D. Change, max
 Engine Oil (IRM 902) 15%
 Gasoline (Ref. Fuel C) 15%
 Ethanol / Ref. Fuel C Mixture 15%
 Diesel Fuel 15%
 Power Steering (IRM 903) 30%
 Auto Trans. (Dexron III) 25%
 Engine Coolant 50/50 15%
 Battery Acid (sp. Gr. ~ 1.26) 5%

Solderability

Mil-Std-202 Method 208 Cat 2 Complies

5. REFERENCE SPECIFICATION

Society Automotive Engineers – J1128

Table 1

Insulation (See Schematic)								
A, nom	B, nom	C	D	E		F		H
				Min	Nom	Min	Nom	Nom
0.014"	0.011"	0.070" ± 0.005"	0.087" ± 0.005"	0.018"	0.028"	0.008"	0.015"	0.197" ± 0.005"

JUDD WIRE INC.
 124 Turnpike Road
 Turners Falls, MA 01376
 (413) 863-4357

Date	Rev	By	Appr'd	ECN
06/23/05	--	GBM	EJK	
06/24/10	A	EJK	ARJP	10-801
08/10/10	B	EJK	ARJP	10-815
Customer Approval:				

Description:
3/C, PARALLEL, 22 AWG, XLPE, TXL

Specification Number:
P02608

Page:
 1 of 1