

DASH NO.	M CODE	MADE FROM
----------	--------	-----------

# GSD

KTH-2119

REVISIONS	
ISSUE	CHANGES
2	CN 27545 C SD 11/06/85

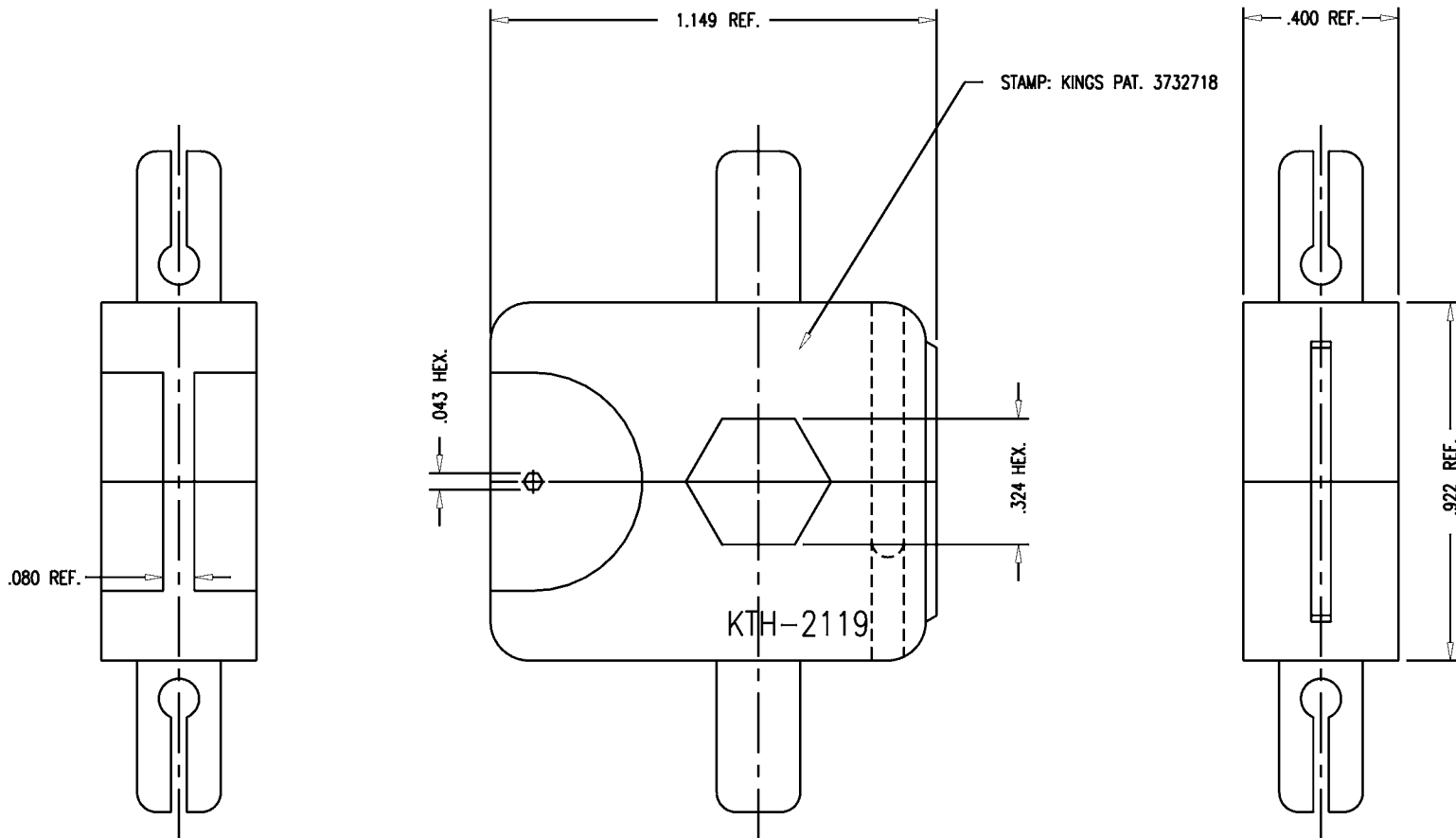

- NOTES:
1. FOR USE WITH BELDEN 8281 & WE 724 CABLE GROUPS.
  2. MATERIAL: ALLOY STEEL
  3. FINISH: BLACK OXIDE

SCALE 3:1	
APPROX SURFACE AREA	
USED ON 2025-7-9	
REF:	
CRIMP DIE	
DRAWN WJM	DATE 10/11/90
DESIGN MJB	DATE 10/15/90
APPR.	DATE

**KINGS**  
ELECTRONICS CO., INC.  
TUCKAHOE, NEW YORK 10707

# GSD

KTH-2119