



This document contains proprietary and confidential information of Northwire, Inc. (and its subsidiary) and shall not be used, disclosed or reproduced, in whole or in part, for any purpose without the prior written consent of Northwire, Inc. (and its subsidiary).

Disclaimer: The technical data that is made part of this document may be subject to the International Traffic in Arms Regulation (ITAR) and the Export Administration Regulations (EAR). Disclosure of technical data to Foreign Persons in the course of employment with U.S. contractors is considered an export and is subject to the ITAR and EAR export licensing requirements/regulations.

DESC: ENDUROFLEX XM PRODUCT LINE

CUSTOMER: NA NWI P/N: ENDUR-XM

CUST. P/N: NA DRAWN: A. SPALDING UNITS: IN SCALE: 24:1 DWG NO: ENDUR-XM DATE: 1/15/2014 REV: H

CORE DIMENSIONS FOR INTERNAL USE ONLY

| ITEM | SPECIFICATIONS |
|------|---|
| A. | 19 STRAND TINNED COPPER |
| B. | 9 MIL PVC INSULATION PER UL AWM 10958 8 MIL MIN. PVC INSULATION |
| C. | FIBRILATED POLYPROPYLENE FILLER IF APPLICABLE |
| D. | PTFE TAPE WRAP |
| E. | 30 MILS GRAY ENDUROFLEX JKT 105 °C 300 OR 600V, AWM STYLE 21002 UL & CSA RECOGNIZED. CABLES OVER .300 O.D. WILL HAVE DIFFERENT JACKET WALL REQUIREMENTS, SEE TABLES |

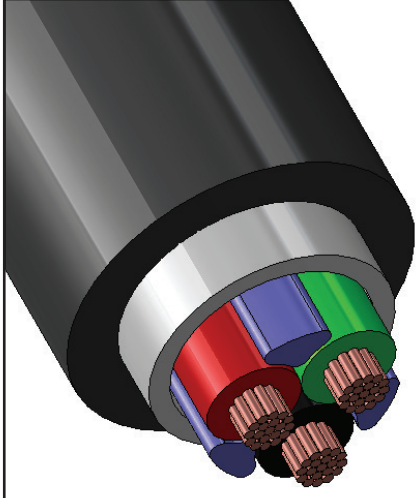
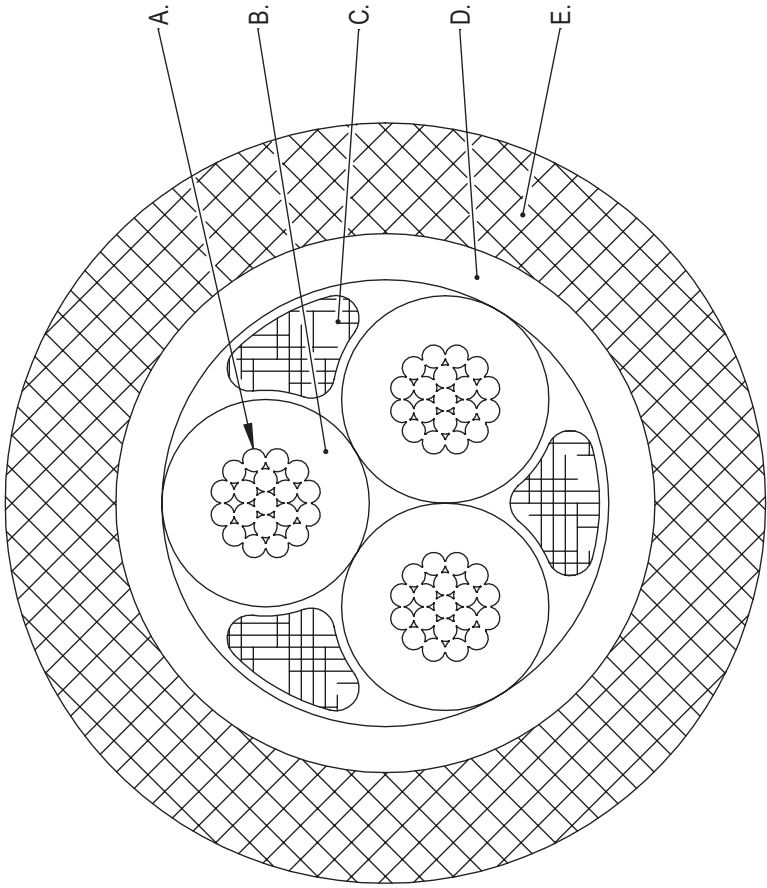

ISOMETRIC VIEW
FOR REFERENCE ONLY

LEGEND SPECIFICATIONS

WI: EnduroFLEX® XM RU AWM E54661 105C 300V or 600V CSA AWM LL54185 I/II A/B 105C 300V or 600V FT1
 NM: EnduroFLEX® XM RU AWM E54661-02 105C 300V or 600V "CSA-C/US" AWM LL54185 (02) III A/B 105C 300V or 600V FT1



This document contains proprietary and confidential information of Northwire, Inc. (and its subsidiary) and shall not be used, disclosed or reproduced, in whole or in part, for any purpose without the prior written consent of Northwire, Inc. (and its subsidiary).

Disclaimer: The technical data that is made part of this document may be subject to the International Traffic in Arms Regulation (ITAR) and the Export Administration Regulations (EAR). Disclosure of technical data to Foreign Persons in the course of employment with U.S. contractors is considered an export and is subject to the ITAR and EAR export licensing requirements/regulations.

| | | |
|---------------|--------------------|------------------|
| DESC: | UNITS: IN | SCALE: 24:1 |
| CUSTOMER: NA | NWI P/N: ENDUR-XM | DWG NO: ENDUR-XM |
| CUST. P/N: NA | DRAWN: A. SPALDING | DATE: 1/15/2014 |
| | | REV: H |

| COLOR CODE CHART | |
|------------------|---|
| 2 POLE | BROWN, BLUE |
| 3 POLE | BROWN, BLUE, BLACK |
| 4 POLE | BROWN, WHITE, BLUE, BLACK |
| 5 POLE | BROWN, WHITE, BLUE, BLACK, GRAY |
| 6 POLE | BROWN, WHITE, BLUE, BLACK, GRAY, PINK |
| 7 POLE | WHITE, BROWN, GREEN, YELLOW, GRAY, PINK, BLUE |
| 8 POLE | WHITE, BROWN, GREEN, YELLOW, GRAY, PINK, BLUE, RED |
| 9 POLE | WHITE, BROWN, GREEN, YELLOW, GRAY, PINK, BLUE, RED, BLACK |
| 10 POLE | WHITE, BROWN, GREEN, YELLOW, GRAY, PINK, BLUE, RED, BLACK, VIOLET |
| 11 POLE | WHITE, BROWN, GREEN, YELLOW, GRAY, PINK, BLUE, RED, BLACK, VIOLET, GRAY/PINK |
| 12 POLE | WHITE, BROWN, GREEN, YELLOW, GRAY, PINK, BLUE, RED, BLACK, VIOLET, GRAY/PINK, RED/BLUE |
| 16 POLE | WHITE, BROWN, GREEN, YELLOW, GRAY, PINK, BLUE, RED, BLACK, VIOLET, GRAY/PINK, RED/BLUE, WHITE/GREEN, BROWN/GREEN, WHITE/YELLOW, YELLOW/BROWN |
| 19 POLE | WHITE, BROWN, GREEN, YELLOW, GRAY, PINK, BLUE, RED, BLACK, VIOLET, GRAY/PINK, RED/BLUE, WHITE/GREEN, BROWN/GREEN, WHITE/YELLOW, YELLOW/BROWN, WHITE/GRAY, GRAY/BROWN, WHITE/PINK |
| 25 POLE | WHITE, BROWN, GREEN, YELLOW, GRAY, PINK, BLUE, RED, BLACK, VIOLET, GRAY/PINK, RED/BLUE, WHITE/GREEN, BROWN/GREEN, WHITE/YELLOW, YELLOW/BROWN, WHITE/GRAY, GRAY/BROWN, WHITE/PINK, PINK/BROWN, WHITE/BLUE, BROWN/BLUE, WHITE/RED, BROWN/RED, WHITE/BLACK |



This document contains proprietary and confidential information of Northwire, Inc. (and its subsidiary) and shall not be used, disclosed or reproduced, in whole or in part, for any purpose without the prior written consent of Northwire, Inc. (and its subsidiary).

Disclaimer: The technical data that is made part of this document may be subject to the International Traffic in Arms Regulation (ITAR) and the Export Administration Regulations (EAR). Disclosure of technical data to Foreign Persons in the course of employment with U.S. contractors is considered an export and is subject to the ITAR and EAR export licensing requirements/regulations.

| DESC: | | UNITS: IN | | SCALE: 24:1 | ITEM | NOTES | | |
|---------------|--------------------|------------------|-----------|--|------------|----------|-----------|-----------------|
| AWG | COND. | FILLER | JACKET WT | CORE O.D. | O.D. | INNER WT | INNER OD | NWI P/N |
| CUSTOMER: NA | NWI P/N: ENDUR-XM | DWG NO: ENDUR-XM | | 30 MILS MIN. AVERAGE JACKET WALL/24 MILS MIN. AT ANY POINT | | | | |
| CUST. P/N: NA | DRAWN: A. SPALDING | DATE: 1/15/2014 | | 35 MILS MIN. AVERAGE JACKET WALL/28 MILS MIN. AT ANY POINT | | | * | |
| | | | | 40 MILS MIN. AVERAGE JACKET WALL/34 MILS MIN. AT ANY POINT | | | + | |
| | | | | 45 MILS MIN. AVERAGE JACKET WALL/38 MILS MIN. AT ANY POINT | | | - | |
| | | | | 50 MILS MIN. AVERAGE JACKET WALL/44 MILS MIN. AT ANY POINT | | | # | |
| 26 | 3 | YES | .030 | .090±.005" | .155±.005" | .009 | .039±.002 | FXM263-001 (N) |
| 26 | 4 | YES | .030 | .100±.005" | .165±.005" | .009 | .039±.002 | FXM264-001 (N) |
| 24 | 3 | YES | .030 | .105±.005" | .170±.005" | .009 | .044±.002 | FXM243-001 (N) |
| 24 | 4 | YES | .030 | .115±.005" | .180±.005" | .009 | .044±.002 | FXM244-001 (N) |
| 24 | 6 | YES | .030 | .140±.005" | .205±.005" | .009 | .044±.002 | FXM246-001 (N) |
| 24 | 8 | YES | .030 | .155±.005" | .220±.005" | .009 | .044±.002 | FXM248-001 (N) |
| 22 | 4 | YES | .030 | .130±.005" | .195±.005" | .009 | .050±.002 | FXM224-001 (N) |
| 22 | 5 | YES | .030 | .145±.005" | .210±.005" | .009 | .050±.002 | FXM225-001 (N) |
| 22 | 6 | YES | .030 | .160±.005" | .225±.005" | .009 | .050±.002 | FXM226-001 (N) |
| 22 | 8 | YES | .030 | .175±.005" | .240±.005" | .009 | .050±.002 | FXM228-001 (N) |
| 20 | 2 | YES | .030 | .124±.005" | .190±.005" | .009 | .057±.002 | FXM202-001 (N) |
| 20 | 3 | YES | .030 | .130±.005" | .195±.005" | .009 | .057±.002 | FXM203-001 (N) |
| 20 | 4 | YES | .030 | .145±.005" | .210±.005" | .009 | .057±.002 | FXM204-001 (N) |
| 20 | 5 | YES | .030 | .160±.005" | .225±.005" | .009 | .057±.002 | FXM205-001 (N) |
| 20 | 6 | YES | .030 | .180±.005" | .245±.005" | .009 | .057±.002 | FXM206-001 (N) |
| 20 | 8 | YES | .030 | .200±.005" | .265±.005" | .009 | .057±.002 | FXM208-001 (N) |
| 20 | 12 | NO | .030 | .245±.005" | .310±.005" | .009 | .057±.002 | FXM2012-001 (N) |
| *20 | 16 | YES | .035 | .275±.005" | .350±.005" | .009 | .057±.002 | FXM2016-001 (N) |
| +20 | 25 | YES | .040 | .350±.010" | .435±.010" | .009 | .057±.002 | FXM2025-001 (N) |
| 18 | 2 | YES | .030 | .150±.005" | .215±.005" | .009 | .070±.002 | FXM182-001 (N) |
| 18 | 3 | YES | .030 | .160±.005" | .220±.005" | .009 | .070±.002 | FXM183-001 (N) |
| 18 | 4 | YES | .030 | .180±.005" | .245±.005" | .009 | .070±.002 | FXM184-001 (N) |
| 18 | 5 | YES | .030 | .200±.005" | .260±.005" | .009 | .070±.002 | FXM185-001 (N) |
| 18 | 6 | YES | .030 | .220±.005" | .285±.005" | .009 | .070±.002 | FXM186-001 (N) |
| *18 | 8 | YES | .035 | .245±.005" | .320±.005" | .009 | .070±.002 | FXM188-001 (N) |
| *18 | 12 | NO | .035 | .300±.007" | .375±.007" | .009 | .070±.002 | FXM1812-001 (N) |
| +18 | 16 | YES | .040 | .340±.010" | .425±.010" | .009 | .070±.002 | FXM1816-001 (N) |
| -18 | 19 | NO | .045 | .360±.010" | .455±.010" | .009 | .070±.002 | FXM1819-001 (N) |
| #18 | 25 | YES | .050 | .430±.010" | .535±.010" | .009 | .070±.002 | FXM1825-001 (N) |



This document contains proprietary and confidential information of Northwire, Inc. (and its subsidiary) and shall not be used, disclosed or reproduced, in whole or in part, for any purpose without the prior written consent of Northwire, Inc. (and its subsidiary).

Disclaimer: The technical data that is made part of this document may be subject to the International Traffic in Arms Regulation (ITAR) and the Export Administration Regulations (EAR). Disclosure of technical data to Foreign Persons in the course of employment with U.S. contractors is considered an export and is subject to the ITAR and EAR export licensing requirements/regulations.

DESC:

CUSTOMER: NA

CUST. P/N: NA

NWI P/N: ENDUR-XM

DRAWN: A. SPALDING

UNITS: IN SCALE: 60:1

DWG NO: ENDUR-XM

DATE: 1/15/2014 REV: H

ELECTRICAL REQUIREMENTS

NONE SPECIFIED

MECHANICAL REQUIREMENTS

10 MILLION TORSIONAL FLEX TEST



| | | | |
|--|------|-----------|-----|
| INSULATION WAS POLYESTER HYTREL; CONDUCTOR O.D. CHANGED ON 26 - 20 AWG; CORE AND FINISHED O.D. CHANGES AS NEEDED | H | 5/27/16 | DPL |
| UPDATED LEGEND TO CURRENT VERSION | G | 6/6/2014 | NAS |
| UPDATED JACKET WALL THICKNESSES | F | 3/14/2014 | NAS |
| REDRAW IN SOLIDWORKS, ADDED TOLERANCES | E | 1/15/2014 | NAS |
| REVISION RECORD | REV. | REV DATE | APR |
| REVISIONS | | | |