

4

3

2

1

TABULATION

PART NO.	A $\pm 1/16$ DIM	B $\pm 1/32$ DIM	C $\pm 1/16$ DIM	COLOR
-1	1-1/4	1/8	5/8	WHITE
-2	1-1/2	1/8	5/8	WHITE
-3	1-3/4	1/8	5/8	WHITE
-4	2	1/8	5/8	WHITE
-5	2-1/4	1/8	5/8	WHITE
-6	2-1/2	1/8	5/8	WHITE
-7	6	1/8	5/8	WHITE
-8	6	1/8	5/8	BLACK
-9	6	1/8	5/8	BROWN
-10	6	1/8	5/8	RED
-11	6	1/8	5/8	ORANGE
-12	6	1/8	5/8	YELLOW
-13	6	1/8	5/8	GREEN
-14	6	1/8	5/8	BLUE
-15	6	1/8	5/8	VIOLET
-16	6	1/8	5/8	GRAY
-17	2-1/4	1/8	5/8	BLACK
-18	2-1/4	1/8	5/8	BROWN
-19	2-1/4	1/8	5/8	RED
-20	2-1/4	1/8	5/8	ORANGE
-21	2-1/4	1/8	5/8	YELLOW
-22	2-1/4	1/8	5/8	GREEN
-23	2-1/4	1/8	5/8	BLUE
-24	2-1/4	1/8	5/8	VIOLET
-25	2-1/4	1/8	5/8	GRAY

REVISIONS				
ZONE	REV	DESCRIPTION	DATE	APPROVED
	A	RELEASE	12/23/83	DARB
	B	7990-2405	3/8/94	RFP
	C	7990-3703	3/10/99	DARB
	D	ADDED -17 THRU -25	3/4/02	RFP
	D1	ECN 1022-SSC	11/18/08	RFP
	D2	ECN 2131-SSC	5/29/09	PDC

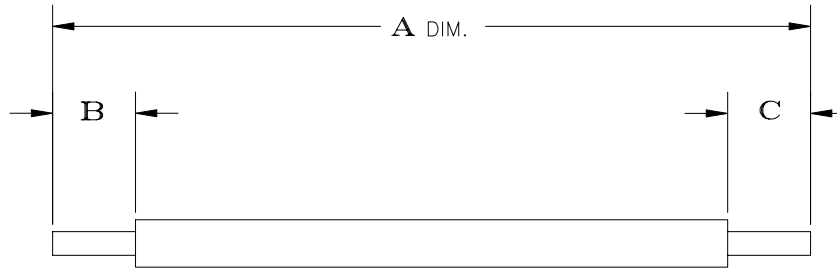

9. PRIOR TO USE, BAKE WIRES FOR 1 HOUR AT $150 \pm 10^\circ\text{C}$ TO PRE-SHRINK INSULATION. THIS CAN BE DONE AT ANY POINT PRIOR TO INSTALLATION.
8. FUTURE REVISIONS OF THIS DRAWING REQUIRE REVIEW OF 7041-5356
7. 7041-5356 REV. A MAY BE SUBSTITUTED FOR THIS PART.
6. NOMINAL INSULATED WALL THICKNESS: .005 INCH
5. NOMINAL O.D.: .019 INCH
4. TEMP. RANGE: -100°C TO $+150^\circ\text{C}$
3. DIELECTRIC CONSTANT: 2.6
2. INSULATION: TEFZEL[®] PER MIL-W-81822/13 (COPOLYMER OF ETHYLENE & TETRA FLUOROETHYLENE)
1. CONDUCTOR: SOLID SINGLE CONDUCTOR SILVER PLATED OFHC COPPER.

NOTES:

UNLESS OTHERWISE SPECIFIED DIMENSIONS ARE IN INCHES TOLERANCES ARE: FRACTIONS DECIMALS ANGLES E .xx E .01 E 2' .xxx E .005		CONTRACT No.		SPECTRUM SENSORS & CONTROLS GRASS VALLEY, CALIFORNIA	
MATERIAL		APPROVALS		DATE	
NOTED		DARB		12/22/83	
FINISH		CHECKED		SIZE CAGE CODE DWG NO.	
NOTED				5W885 7040-5356	
NEXT ASSEMBLY USED ON		SCALE: NONE		SHEET 1 OF 1	
APPLICATION					

4

3

2

1