



This document contains proprietary and confidential information of Northwire, Inc. (and its subsidiary) and shall not be used, disclosed or reproduced, in whole or in part, for any purpose without the prior written consent of Northwire, Inc. (and its subsidiary).

Disclaimer: The technical data that is made part of this document may be subject to the International Traffic in Arms Regulation (ITAR) and the Export Administration Regulations (EAR). Disclosure of technical data to Foreign Persons in the course of employment with U.S. contractors is considered an export and is subject to the ITAR and EAR export licensing requirements/regulations.

DESC: ENDUROFLEX XM PRODUCT LINE

CUSTOMER: NA NWI P/N: ENDUR-XM

CUST. P/N: NA DRAWN: A. SPALDING

UNITS: IN SCALE: 24:1 DWG NO: ENDUR-XM REV: H

DATE: 1/15/2014

REV: H

CORE DIMENSIONS FOR INTERNAL USE ONLY

ITEM SPECIFICATIONS

A. 19 STRAND TINNED COPPER

B. 9 MIL PVC INSULATION PER UL AWM 10958
8 MIL MIN. PVC INSULATION

C. FIBRILATED POLYPROPYLENE FILLER IF APPLICABLE

D. PTFE TAPE WRAP

E. 30 MILS GRAY ENDUROFLEX JKT 105 °C 300 OR 600V, AWM STYLE 21002

UL & CSA RECOGNIZED.

CABLES OVER .300 O.D. WILL HAVE DIFFERENT JACKET WALL REQUIREMENTS, SEE TABLES

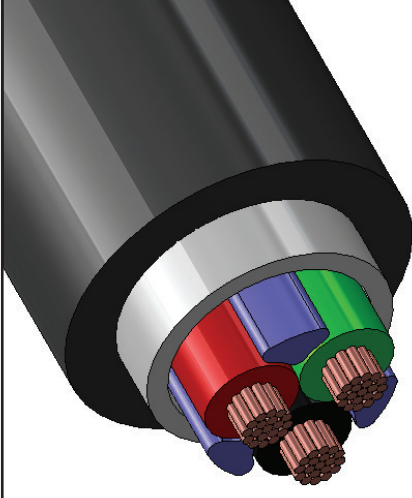
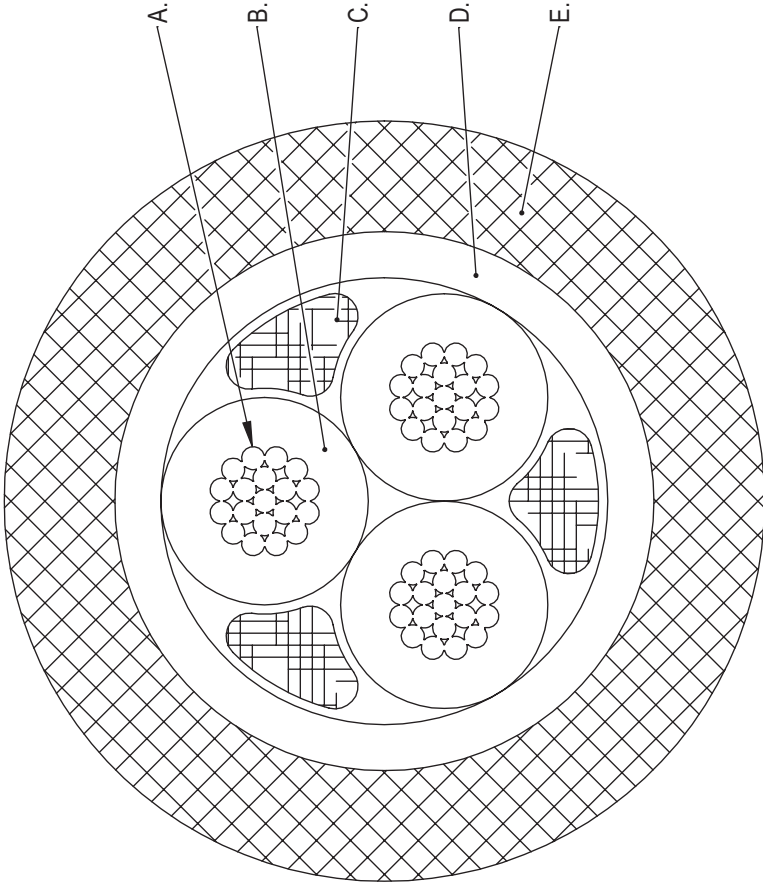

ISOMETRIC VIEW FOR REFERENCE ONLY

LEGEND SPECIFICATIONS

WI: EnduroFLEX® XM RU AWM E54661 105C 300V or 600V CSA AWM LL54185 I/II A/B 105C 300V or 600V FT1
 NM: EnduroFLEX® XM RU AWM E54661-02 105C 300V or 600V "CSA-C/US" AWM LL54185 (02) III A/B 105C 300V or 600V FT1



This document contains proprietary and confidential information of Northwire, Inc. (and its subsidiary) and shall not be used, disclosed or reproduced, in whole or in part, for any purpose without the prior written consent of Northwire, Inc. (and its subsidiary).

Disclaimer: The technical data that is made part of this document may be subject to the International Traffic in Arms Regulation (ITAR) and the Export Administration Regulations (EAR). Disclosure of technical data to Foreign Persons in the course of employment with U.S. contractors is considered an export and is subject to the ITAR and EAR export licensing requirements/regulations.

DESC:	UNITS: IN	SCALE: 24:1
CUSTOMER: NA	NWI P/N: ENDUR-XM	DWG NO: ENDUR-XM
CUST. P/N: NA	DRAWN: A. SPALDING	DATE: 1/15/2014
		REV: H

COLOR CODE CHART	
2 POLE	BROWN, BLUE
3 POLE	BROWN, BLUE, BLACK
4 POLE	BROWN, WHITE, BLUE, BLACK
5 POLE	BROWN, WHITE, BLUE, BLACK, GRAY
6 POLE	BROWN, WHITE, BLUE, BLACK, GRAY, PINK
7 POLE	WHITE, BROWN, GREEN, YELLOW, GRAY, PINK, BLUE
8 POLE	WHITE, BROWN, GREEN, YELLOW, GRAY, PINK, BLUE, RED
9 POLE	WHITE, BROWN, GREEN, YELLOW, GRAY, PINK, BLUE, RED, BLACK
10 POLE	WHITE, BROWN, GREEN, YELLOW, GRAY, PINK, BLUE, RED, BLACK, VIOLET
11 POLE	WHITE, BROWN, GREEN, YELLOW, GRAY, PINK, BLUE, RED, BLACK, VIOLET, GRAY/PINK
12 POLE	WHITE, BROWN, GREEN, YELLOW, GRAY, PINK, BLUE, RED, BLACK, VIOLET, GRAY/PINK, RED/BLUE
16 POLE	WHITE, BROWN, GREEN, YELLOW, GRAY, PINK, BLUE, RED, BLACK, VIOLET, GRAY/PINK, RED/BLUE, WHITE/GREEN, BROWN/GREEN, WHITE/YELLOW, YELLOW/BROWN
19 POLE	WHITE, BROWN, GREEN, YELLOW, GRAY, PINK, BLUE, RED, BLACK, VIOLET, GRAY/PINK, RED/BLUE, WHITE/GREEN, BROWN/GREEN, WHITE/YELLOW, YELLOW/BROWN, WHITE/GRAY, GRAY/BROWN, WHITE/PINK
25 POLE	WHITE, BROWN, GREEN, YELLOW, GRAY, PINK, BLUE, RED, BLACK, VIOLET, GRAY/PINK, RED/BLUE, WHITE/GREEN, BROWN/GREEN, WHITE/YELLOW, YELLOW/BROWN, WHITE/GRAY, GRAY/BROWN, WHITE/PINK, PINK/BROWN, WHITE/BLUE, BROWN/BLUE, WHITE/RED, BROWN/RED, WHITE/BLACK



This document contains proprietary and confidential information of Northwire, Inc. (and its subsidiary) and shall not be used, disclosed or reproduced, in whole or in part, for any purpose without the prior written consent of Northwire, Inc. (and its subsidiary).

Disclaimer: The technical data that is made part of this document may be subject to the International Traffic in Arms Regulation (ITAR) and the Export Administration Regulations (EAR). Disclosure of technical data to Foreign Persons in the course of employment with U.S. contractors is considered an export and is subject to the ITAR and EAR export licensing requirements/regulations.

DESC:		UNITS: IN		SCALE: 24:1		ITEM		NOTES	
CUSTOMER: NA		DWG NO: ENDUR-XM		DWG NO: ENDUR-XM				30 MILS MIN. AVERAGE JACKET WALL/24 MILS MIN. AT ANY POINT	
CUST. P/N: NA		DATE: 1/15/2014		DATE: 1/15/2014		REV: H		35 MILS MIN. AVERAGE JACKET WALL/28 MILS MIN. AT ANY POINT	
		DRAWN: A. SPALDING						40 MILS MIN. AVERAGE JACKET WALL/34 MILS MIN. AT ANY POINT	
								45 MILS MIN. AVERAGE JACKET WALL/38 MILS MIN. AT ANY POINT	
								50 MILS MIN. AVERAGE JACKET WALL/44 MILS MIN. AT ANY POINT	
AWG	COND.	FILLER	JACKET WT	CORE O.D.	O.D.	INNER WT	INNER OD	NWI P/N	
26	3	YES	.030	.090±.005"	.155±.005"	.009	.039±.002	FXM263-001 (N)	
26	4	YES	.030	.100±.005"	.165±.005"	.009	.039±.002	FXM264-001 (N)	
24	3	YES	.030	.105±.005"	.170±.005"	.009	.044±.002	FXM243-001 (N)	
24	4	YES	.030	.115±.005"	.180±.005"	.009	.044±.002	FXM244-001 (N)	
24	6	YES	.030	.140±.005"	.205±.005"	.009	.044±.002	FXM246-001 (N)	
24	8	YES	.030	.155±.005"	.220±.005"	.009	.044±.002	FXM248-001 (N)	
22	4	YES	.030	.130±.005"	.195±.005"	.009	.050±.002	FXM224-001 (N)	
22	5	YES	.030	.145±.005"	.210±.005"	.009	.050±.002	FXM225-001 (N)	
22	6	YES	.030	.160±.005"	.225±.005"	.009	.050±.002	FXM226-001 (N)	
22	8	YES	.030	.175±.005"	.240±.005"	.009	.050±.002	FXM228-001 (N)	
20	2	YES	.030	.124±.005"	.190±.005"	.009	.057±.002	FXM202-001 (N)	
20	3	YES	.030	.130±.005"	.195±.005"	.009	.057±.002	FXM203-001 (N)	
20	4	YES	.030	.145±.005"	.210±.005"	.009	.057±.002	FXM204-001 (N)	
20	5	YES	.030	.160±.005"	.225±.005"	.009	.057±.002	FXM205-001 (N)	
20	6	YES	.030	.180±.005"	.245±.005"	.009	.057±.002	FXM206-001 (N)	
20	8	YES	.030	.200±.005"	.265±.005"	.009	.057±.002	FXM208-001 (N)	
20	12	NO	.030	.245±.005"	.310±.005"	.009	.057±.002	FXM2012-001 (N)	
*20	16	YES	.035	.275±.005"	.350±.005"	.009	.057±.002	FXM2016-001 (N)	
+20	25	YES	.040	.350±.010"	.435±.010"	.009	.057±.002	FXM2025-001 (N)	
18	2	YES	.030	.150±.005"	.215±.005"	.009	.070±.002	FXM182-001 (N)	
18	3	YES	.030	.160±.005"	.220±.005"	.009	.070±.002	FXM183-001 (N)	
18	4	YES	.030	.180±.005"	.245±.005"	.009	.070±.002	FXM184-001 (N)	
18	5	YES	.030	.200±.005"	.260±.005"	.009	.070±.002	FXM185-001 (N)	
18	6	YES	.030	.220±.005"	.285±.005"	.009	.070±.002	FXM186-001 (N)	
*18	8	YES	.035	.245±.005"	.320±.005"	.009	.070±.002	FXM188-001 (N)	
*18	12	NO	.035	.300±.007"	.375±.007"	.009	.070±.002	FXM1812-001 (N)	
+18	16	YES	.040	.340±.010"	.425±.010"	.009	.070±.002	FXM1816-001 (N)	
-18	19	NO	.045	.360±.010"	.455±.010"	.009	.070±.002	FXM1819-001 (N)	
#18	25	YES	.050	.430±.010"	.535±.010"	.009	.070±.002	FXM1825-001 (N)	



This document contains proprietary and confidential information of Northwire, Inc. (and its subsidiary) and shall not be used, disclosed or reproduced, in whole or in part, for any purpose without the prior written consent of Northwire, Inc. (and its subsidiary).

Disclaimer: The technical data that is made part of this document may be subject to the International Traffic in Arms Regulation (ITAR) and the Export Administration Regulations (EAR). Disclosure of technical data to Foreign Persons in the course of employment with U.S. contractors is considered an export and is subject to the ITAR and EAR export licensing requirements/regulations.

DESC:

CUSTOMER: NA

CUST. P/N: NA

NWI P/N: ENDUR-XM

DRAWN: A. SPALDING

UNITS: IN SCALE: 60:1

DWG NO: ENDUR-XM

DATE: 1/15/2014 REV: H

ELECTRICAL REQUIREMENTS

NONE SPECIFIED

MECHANICAL REQUIREMENTS

10 MILLION TORSIONAL FLEX TEST



INSULATION WAS POLYESTER HYTREL; CONDUCTOR O.D. CHANGED ON 26 - 20 AWG; CORE AND FINISHED O.D. CHANGES AS NEEDED	H	5/27/16	DPL
UPDATED LEGEND TO CURRENT VERSION	G	6/6/2014	NAS
UPDATED JACKET WALL THICKNESSES	F	3/14/2014	NAS
REDRAW IN SOLIDWORKS, ADDED TOLERANCES	E	1/15/2014	NAS
REVISION RECORD	REV.	REV DATE	APR
REVISIONS			