

THIS DRAWING CONTAINS INFORMATION PROPRIETARY TO TEKTRONIX, INC., AND WHEN DISTRIBUTED OUTSIDE TEKTRONIX, INC., IS SUPPLIED FOR IDENTIFICATION, ENGINEERING EVALUATION AND/OR INSPECTION PURPOSES ONLY AND MAY NOT BE USED AS A BASIS FOR MANUFACTURE OR SALES OF PRODUCTS WITHOUT WRITTEN PERMISSION FROM TEKTRONIX, INC. IF THIS DRAWING IS FURNISHED UNDER ANY UNITED STATES GOVERNMENT CONTRACT, IT IS FURNISHED AS LIMITED RIGHTS DATA AND SHALL NOT BE EITHER RELEASED OUTSIDE THE GOVERNMENT, OR USED, DUPLICATED, OR DISCLOSED IN WHOLE OR IN PART FOR MANUFACTURE OR PROCUREMENT, WITHOUT THE WRITTEN PERMISSION OF TEKTRONIX, INC., EXCEPT FOR: (1) EMERGENCY REPAIR OR OVERHAUL WORK BY OR FOR THE GOVERNMENT, WHERE THE ITEM OR PROCESS CONCERNED IS NOT OTHERWISE REASONABLY AVAILABLE TO ENABLE TIMELY PERFORMANCE OF THE WORK; OR (2) RELEASE TO A FOREIGN GOVERNMENT AS THE INTERESTS OF THE UNITED STATES MAY REQUIRE; PROVIDED THAT IN EITHER CASE THE RELEASE, USE, DUPLICATION OR DISCLOSURE HEREOF SHALL BE SUBJECT TO THE FOREGOING LIMITATIONS. THE LIMITED RIGHTS CLAIMED HEREIN ARE NOT SUBJECT TO AN EXPIRATION DATE. IF THIS DRAWING IS REPRODUCED IN WHOLE OR IN A PART, THIS ENTIRE LEGEND BLOCK MUST APPEAR ON ALL REPRODUCED COPIES.

REV	REF	DESCRIPTION OF CHANGE	CHK BY	DATE
B	31719	ADDED ROHS NOTE, REDRAWN	DES	14FEB08

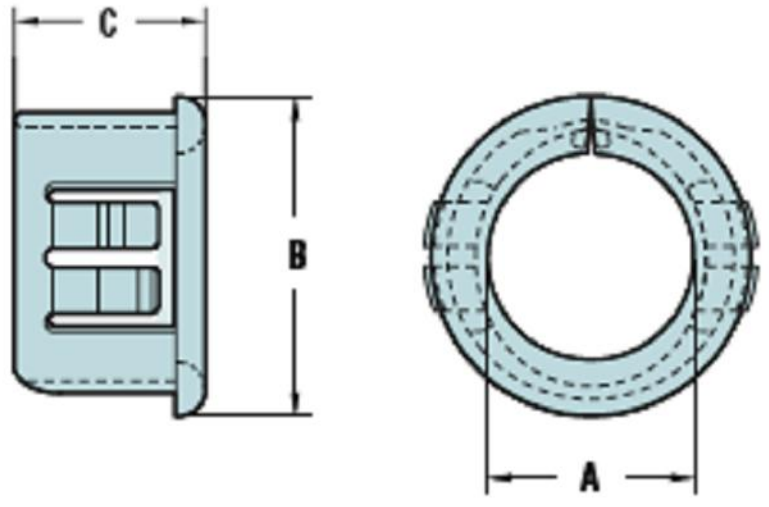

2. ALL MATERIALS TO BE COMPLIANT, PER RESTRICTION ON HAZARDOUS SUBSTANCES, (ROHS) DIRECTIVE 2002/95/EC AND ITS PUBLISHED EXEMPTIONS

1. DIMENSIONING AND TOLERANCING PER ASME Y14.5M - 1994

DIMENSION A: $\varnothing 0.453$
 DIMENSION B: $\varnothing 0.687$
 DIMENSION C: 0.406
 MOUNTING HOLE: $\varnothing 0.625$
 MAXIMUM MATERIAL THICKNESS: 0.125

		TEKTRONIX, INC. P.O. BOX 500 BEAVERTON, OR 97077-0001 USA		
		RELEASED FOR PRODUCTION TOOLING	SIGNATURE	DATE 4MAR02
DWN D. SNYDER	DIMENSIONS ARE IN INCHES TOLERANCES: UNLESS OTHERWISE SPECIFIED		DEC	ANLR
ENGR D. SNYDER			SCALE	FIRST USED ON
CHKR D. SNYDER	PROD	NONE		
MATERIAL 6/6 NYLON				
FINISH NONE				
TITLE GROMMET, PLASTIC BLACK, ROUND, 0.625 DIAMETER				
CODE IDENT NO 80009	SIZE B	PART NUMBER 348-0966-00	SH I OF I	REV B

DO NOT SCALE DRAWING
PTC