

34826 ✓ ACTIVE

PLASTI-GRIP

TE Internal #: 34826

Closed Ring Tongue Terminal, 16 – 14 AWG, 3/8 Stud Size, 9.91 mm [.39 in] Stud Diameter, Closed Barrel, Straight, Tin, PLASTI-GRIP

[View on TE.com >](#)



Terminals & Splices > Ring Terminals

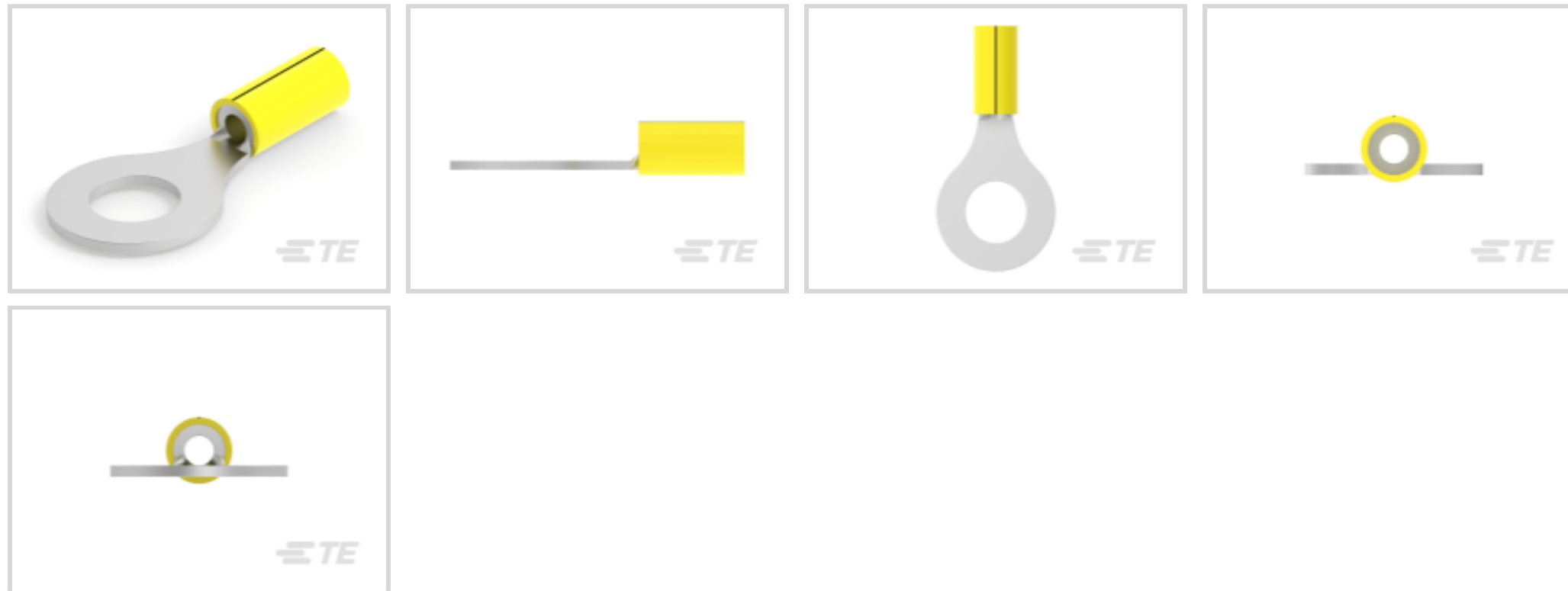

Ring Terminal Product Type: Closed Ring Tongue Terminal

Wire Size: 2050 – 5180 CMA

Stud Size: 3/8

Features

Configuration Features

Number of Holes	1
-----------------	---

Mechanical Attachment

Wire Insulation Support	With
-------------------------	------

Electrical Characteristics

Voltage Rating	600 V
----------------	-------

Industry Standards

Government Qualified Terminal	No
-------------------------------	----

Body Features

Product Weight	.399 g
----------------	--------

Stripe Color	Black
--------------	-------

Packaging Features

Packaging Quantity	500
--------------------	-----

Packaging Method	Loose Piece
------------------	-------------

Product Type Features

Terminal Features	Heavy Duty
-------------------	------------



Ring Terminal Product Type	Closed Ring Tongue Terminal
Stud Size	3/8
Sealable	No
Wire Insulation Support Retention Type	Insulation Support

Contact Features

Barrel Type	Closed
Terminal Orientation	Straight
Terminal Plating Material	Tin

Dimensions

Wire Size	2050 – 5180 CMA
Stud Diameter	9.91 mm [.39 in]
Tongue Thickness	1.22 mm [.05 in]
Product Length	40.49 mm [1.59 in]
Compatible Insulation Diameter (Max)	5.08 mm [.2 in]
Compatible Insulation Diameter Range	2.67 – 5.08 mm [.105 – .2 in]

Usage Conditions

Insulation Option	Partially Insulated
Operating Temperature Range	105 °C [221 °F]

Operation/Application

Compatible With Wire Base Material	Copper
Compatible With Wire Plating Material	Tin

Other

EU RoHS Compliance	Compliant
EU ELV Compliance	Compliant

Product Compliance

[For compliance documentation, visit the product page on TE.com>](#)

EU RoHS Directive 2011/65/EU	Compliant
EU ELV Directive 2000/53/EC	Compliant
China RoHS 2 Directive MIIT Order No 32, 2016	No Restricted Materials Above Threshold
EU REACH Regulation (EC) No. 1907/2006	Current ECHA Candidate List: JUNE 2024 (241)



Candidate List Declared Against: JUNE 2024 (241)
Does not contain REACH SVHC

Halogen Content	Not Low Halogen - contains Br or Cl > 900 ppm.
Solder Process Capability	Not applicable for solder process capability

Product Compliance Disclaimer

This information is provided based on reasonable inquiry of our suppliers and represents our current actual knowledge based on the information they provided. This information is subject to change. The part numbers that TE has identified as EU RoHS compliant have a maximum concentration of 0.1% by weight in homogenous materials for lead, hexavalent chromium, mercury, PBB, PBDE, DBP, BBP, DEHP, DIBP, and 0.01% for cadmium, or qualify for an exemption to these limits as defined in the Annexes of Directive 2011/65/EU (RoHS2). Finished electrical and electronic equipment products will be CE marked as required by Directive 2011/65/EU. Components may not be CE marked. Additionally, the part numbers that TE has identified as EU ELV compliant have a maximum concentration of 0.1% by weight in homogenous materials for lead, hexavalent chromium, and mercury, and 0.01% for cadmium, or qualify for an exemption to these limits as defined in the Annexes of Directive 2000/53/EC (ELV). Regarding the REACH Regulation, the information TE provides on SVHC in articles for this part number is based on the latest European Chemicals Agency (ECHA) 'Guidance on requirements for substances in articles' posted at this URL: <https://echa.europa.eu/guidance-documents/guidance-on-reach>

Compatible Parts

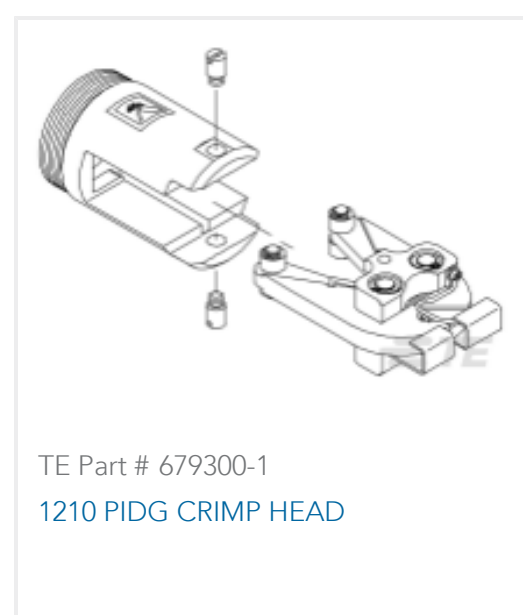

Also in the Series | **PLASTI-GRIP**



Compression Connectors(3)



Crimp Wire Pins, Tabs & Ferrules(18)

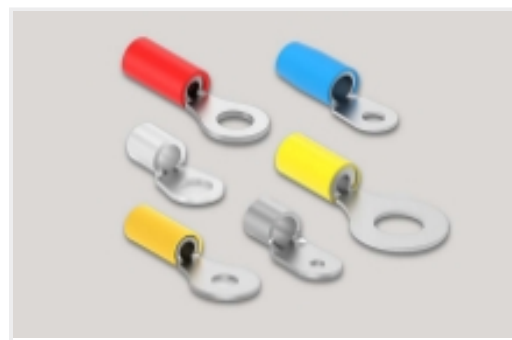

Ring Terminals(297)

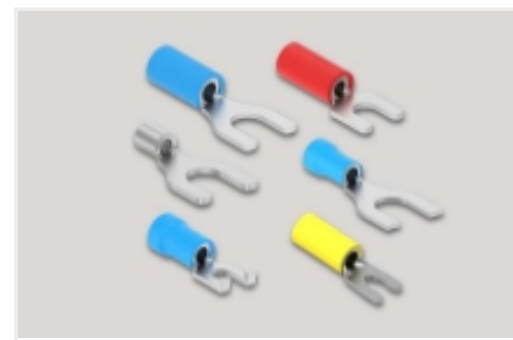

Spade Terminals(157)



Splices(44)

Customers Also Bought



TE Part #211825-2
CPC RECPT ASSEMBLY SIZE 23-13



TE Part #206207-1
17-3 RECEPT. FREE-HANGING

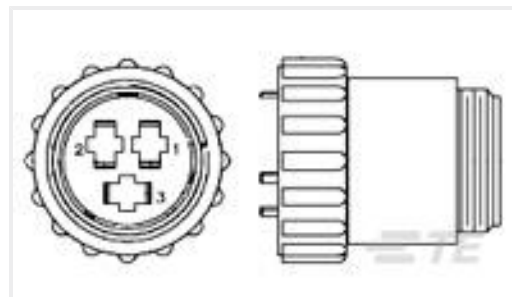

TE Part #206037-2
CPC PLUG ASSEMBLY SIZE 17-3



TE Part #2-35451-1
PG R 22-16 COMM 22-18 MIL 10



TE Part #1SNL340011R0000
DBL400-PV

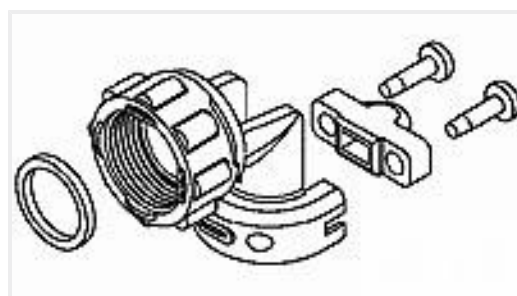

TE Part #796382-2
R/A STRN RELIEF KIT, SZ 23, CPC



TE Part #206137-5
23-7 RECEPT STD SEX

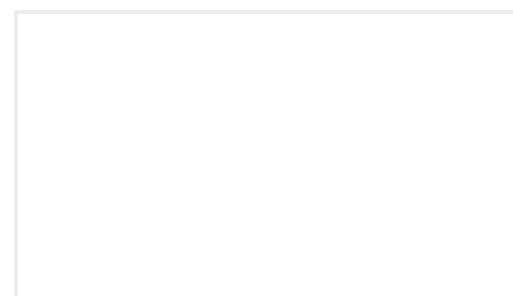

TE Part #3-1423712-5
W28-X1095-5=CKTBKR,THERM,ROCK, QC.250,FUS

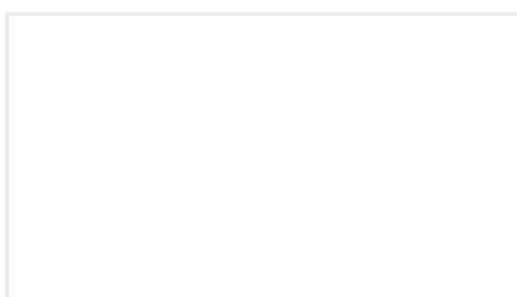

TE Part #308161-1
LEFT SIDE GUARD

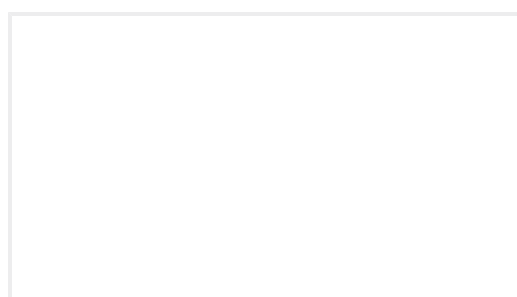

TE Part #PF0001822
P011NT_5K1% 4.7X_68 ____ 2N

Documents



Product Drawings

[TERMINAL,PG R 16-14HD 3/8](#)

English

CAD Files

3D PDF

3D

Customer View Model

[ENG_CVM_CVM_34826_J.2d_dxf.zip](#)

English

Customer View Model

[ENG_CVM_CVM_34826_J.3d_igs.zip](#)

English

Customer View Model

[ENG_CVM_CVM_34826_J.3d_stp.zip](#)

English

Customer View Model

[ENG_CVM_34826_E.3d_igs.zip](#)

English

Customer View Model

[ENG_CVM_34826_E.3d_stp.zip](#)

English

Customer View Model

[ENG_CVM_34826_E.2d_dxf.zip](#)

English

3D PDF

English

By downloading the CAD file I accept and agree to the [Terms and Conditions](#) of use.

Product Specifications

[Application Specification](#)

English

Agency Approvals

UL Report

English

UL Report

English