

16 | 15 | 14 | 13 | 12 | 11 | 10 | 9 | 8 | 7 | 6 | 5 | 4 | 3 | 2 | 1

NOTES:
 1. RAWSTOCK: 1313-129600
 3/0 CU WIRE - 19 STRANDS.
 2. [] INSP - INDICATES AN IN
 PROCESS INSPECTION
 CHARACTERISTIC.
 3. TOLERANCE FOR ALL TRIMMED
 DIMENSIONS IS $\pm .05$.
 TOLERANCE FOR ALL FORMED
 DIMENSIONS IS $\pm .12$.
 UNLESS OTHERWISE NOTED.
 4. FORMED VIEW DIMENSIONS
 SUPERSEDE BLANK VIEW DIMENSIONS.

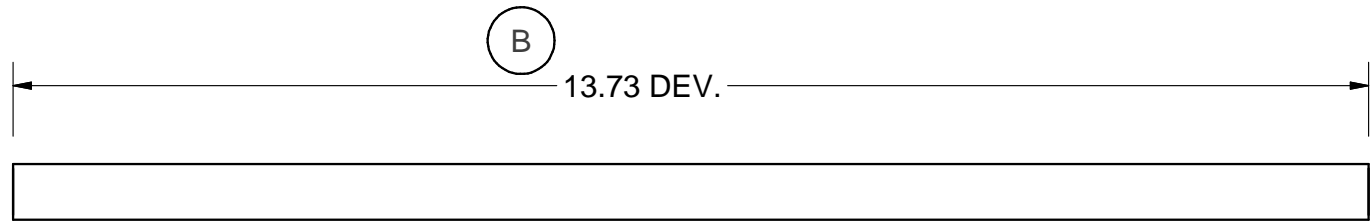

BLANK VIEW

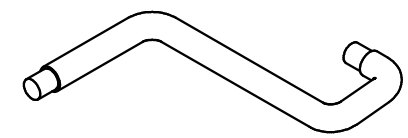

ISOMETRIC VIEW
 SCALE 1 / 4:1

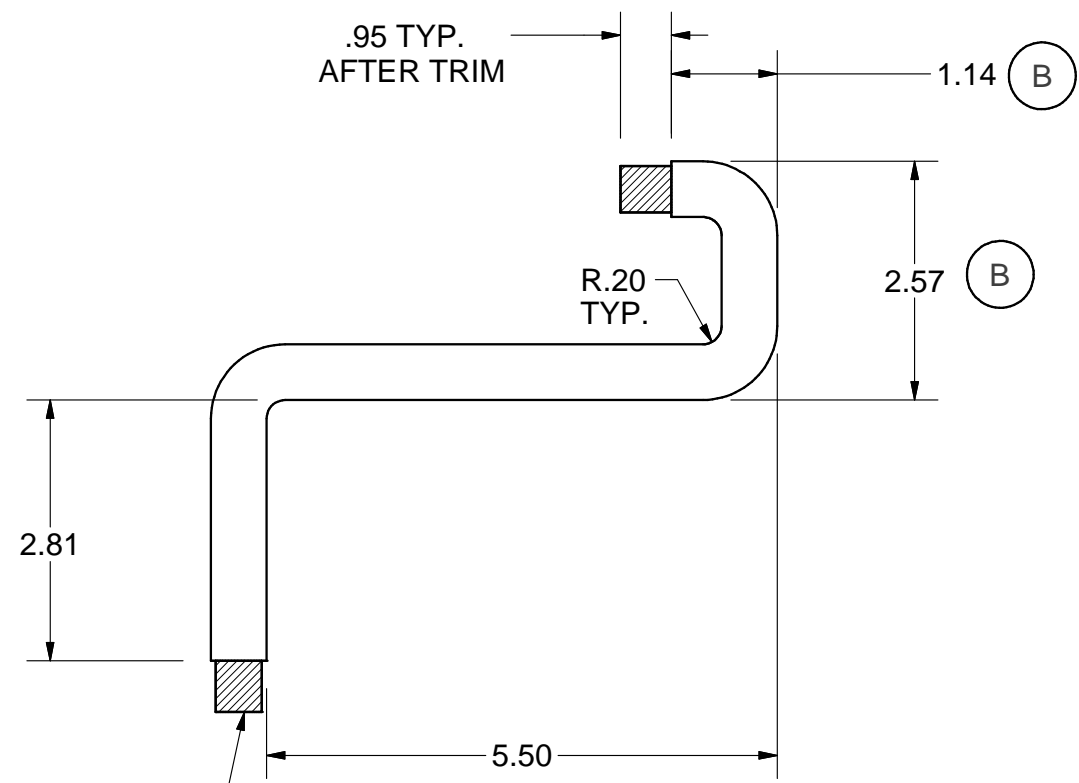

WIRE ENDS TO BE
 CUT OFF STRAIGHT
 AFTER WIRE IS FORMED.

SIMILAR TO: 40561-320-01

THIRD ANGLE		GENERAL TOLERANCES SPEC. XXXXX-XXX-XX CATEGORY # NORMAL CLASS TOLERANCE		SQUARE D Schneider Electric	
DIMENSIONS ARE IN INCHES UNLESS OTHERWISE NOTED * DENOTES CRITICAL CHARACTERISTIC				BREAKER LOAD WIRE (L)	
<small>THIS DOCUMENT CONTAINS CONFIDENTIAL INFORMATION OF SCHNEIDER ELECTRIC OR A RELATED COMPANY. IT IS NOT TO BE REPRODUCED BY ANY MEANS OR USED TO FURNISH INFORMATION TO OTHERS WITHOUT THE EXPRESS CONSENT OF OWNER. THE INFORMATION SHALL BE USED BY ANY RECIPIENTS ONLY AS EXPRESSLY APPROVED BY OWNER AND THIS DOCUMENT SHALL BE RETURNED TO OWNER UPON REQUEST. © 2002, SCHNEIDER ELECTRIC, ALL RIGHTS RESERVED.</small>					
DRW	MRR	CHK	JAD	SCALE	1:2
DATE	19SEP2003		ECO	MT00028	
SIZE	B	DWG NO	40562-311-01		SHEET
					1 OF 1

B	MC00588	30DEC2003	MRR	ADJUSTED DIMENSIONS.
REV.	ECO	DATE	BY	REVISION DESCRIPTION

16 | 15 | 14 | 13 | 12 | 11 | 10 | 9 | 8 | 7 | 6 | 5 | 4 | 3 | 2 | 1