



RAF ELECTRONIC
HARDWARE
a Division of MW Industries, Inc.



ABOUT US WHAT'S NEW CONTACT US SERVICES QUALITY SITE MAP

- HOME
- PRODUCTS
- ONLINE CATALOG
- REQUEST QUOTE
- ORDER ONLINE
- CHECK STOCK
- REQUEST PRINT CATALOG
- REQUEST SAMPLES
- ENGINEERING DATA
- DISTRIBUTORS
- CAPABILITIES BROCHURE

CALL NOW:
203 888-2133



PART NO. SEARCH - ENTER 3-4 CHARS:

ENTER

Catalogs: [ASE](#) | [Metric](#) | [Handles & Ferrules](#)

3/16 Hex Male-Female Standoffs

[Home](#) [Previous](#) [Next](#)
[Related Metric](#)

Ordering Code			
xxxx	xxx	x	x
Length	Thread	Material	Finish

PART: 4517-632-SS

Enter desired quantities:
Qty 1 Qty 2 Qty 3

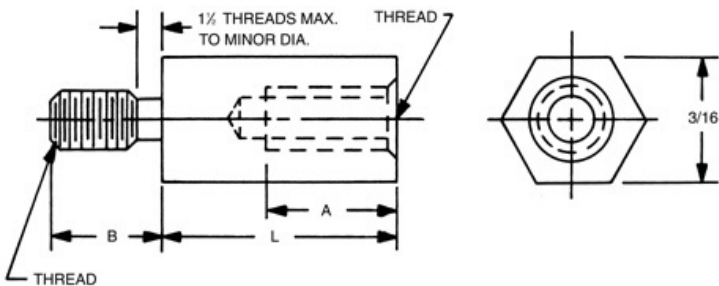

Check Stock

Request Drawing

Select	Part No.	Length
<input type="checkbox"/>	4500A	5/32
<input type="checkbox"/>	4500	3/16
<input type="checkbox"/>	4500T	7/32
<input type="checkbox"/>	4501	1/4
<input type="checkbox"/>	4501T	9/32
<input type="checkbox"/>	4502	5/16
<input type="checkbox"/>	4502T	11/32
<input type="checkbox"/>	4503	3/8
<input type="checkbox"/>	4503T	13/32
<input type="checkbox"/>	4504	7/16
<input type="checkbox"/>	4504T	15/32
<input type="checkbox"/>	4505	1/2
<input type="checkbox"/>	4505T	17/32
<input type="checkbox"/>	4506	9/16
<input type="checkbox"/>	4506T	19/32
<input type="checkbox"/>	4507	5/8
<input type="checkbox"/>	4507T	21/32
<input type="checkbox"/>	4508	11/16
<input type="checkbox"/>	4508T	23/32

Select	Part No.	Length
<input type="checkbox"/>	4509	3/4
<input type="checkbox"/>	4509T	25/32
<input type="checkbox"/>	4510	13/16
<input type="checkbox"/>	4510T	27/32
<input type="checkbox"/>	4511	7/8
<input type="checkbox"/>	4511T	29/32
<input type="checkbox"/>	4512	15/16
<input type="checkbox"/>	4512T	31/32
<input type="checkbox"/>	4513	1"
<input type="checkbox"/>	4514	1-1/16

Select	Part No.	Length
<input type="checkbox"/>	4515	1-1/8
<input type="checkbox"/>	4516	1-3/16
<input type="checkbox"/>	4517	1-1/4
<input type="checkbox"/>	4518	1-5/16
<input type="checkbox"/>	4519	1-3/8
<input type="checkbox"/>	4520	1-7/16
<input type="checkbox"/>	4521	1-1/2
<input type="checkbox"/>	4522	1-9/16
<input type="checkbox"/>	4523	1-5/8
<input type="checkbox"/>	4524	1-11/16
<input type="checkbox"/>	4525	1-3/4
<input type="checkbox"/>	4526	1-13/16
<input type="checkbox"/>	4527	1-7/8
<input type="checkbox"/>	4528	1-15/16
<input type="checkbox"/>	4529	2"

Select	Code	Thread
<input type="checkbox"/>	256	2-56
<input type="checkbox"/>	440	4-40
<input type="checkbox"/>	632	6-32

Thread Length Code		
Thread	A	B
2-56	3/16	5/32
4-40	1/4	3/16
6-32	3/8	1/4

Select	Code	Material	RoHS
<input type="checkbox"/>	AL	Aluminum	YES
<input type="checkbox"/>	B	Brass	YES
<input type="checkbox"/>	SS	Stainless Steel	YES
<input type="checkbox"/>	S	Steel	YES
<input type="checkbox"/>	N	Nylon	YES

Material Specifications

SELECT FINISH:

Plain Finish

* Finishes ending with an asterisk are **not** RoHS Compliant

[Ordering non-standard items](#)

In short lengths, 'A' will be tapped to maximum depth

[HOME](#) | [PRODUCTS](#) | [ONLINE CATALOG](#) | [REQUEST QUOTE](#) | [ORDER ONLINE](#) | [CHECK STOCK](#) | [CONTACT US](#) | [SITE MAP](#)

© RAF Electronic Hardware, a Division of MW Industries | 95 Silvermine Rd., Seymour CT 06483 | Tel 203-888-2133 | Fax 203-888-9860