

64-010 C

REVISIONS			
LTR	DESCRIPTION	DATE	APPROVED
C	SEE E.C.O. 27008	9/17/97	<i>HP</i>

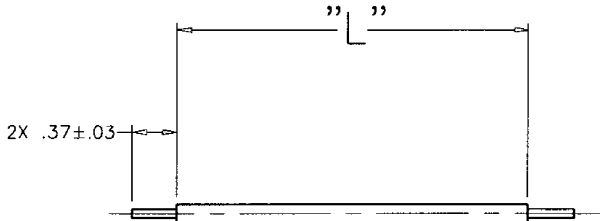

DASH NO.	LENGTH "A" ±.03	INSUL. COLOR
-1	5.50	RED
-2	5.50	BLACK
-3	6.50	VIOLET
-4	6.25	ORANGE
-5	7.00	BLUE
-6	6.75	YELLOW
-7	6.00	GREEN
-8	5.75	WHITE
-9	7.25	GREY

CURRENT DESIGN ACTIVITY CAGE CODE 99564  
**AMETEK**<sup>®</sup>  
 AEROSPACE • GULFON-STATHAM™ PRODUCTS

2. WIRES TO BE STRIPPED AND PRE-TINNED, BOTH ENDS, USING SN60, SN62 OR SN63 SOLDER AND WRP OR WRMA FLUX ONLY

1. MATERIAL: 30AWG, TFE TEFLON INSULATED, SILVER PLATED, STRANDED COPPER PER MIL-W-17878, TYPE E. (I.E. ALPHA WIRE, P/N 2851)

NOTES: UNLESS OTHERWISE SPECIFIED

		UNLESS OTHERWISE SPECIFIED DIMENSIONS ARE IN INCHES	APPROVALS		DATE	<b>PATRIOT</b> Sensors & Controls Corporation			
		TOLERANCES ARE: FRACTIONAL DECIMALS FINISH ±1/64 .X ±.015 125 ✓ .XX ±.010 .XXX ±.005	DRAWN H.COHEN		7/28/98	TITLE SPECIFICATION CONTROL DWG WIRE, INSULATED			
		ANGLES ±1/2° DO NOT SCALE DRAWING -	CHECKED T.TRAN		8/5/98	SIZE CODE IDENT DRAWING NO. REV			
		MATERIAL	APPROVED A.TIRMIZI		8/7/98	B	65998	64-010	C
MULTIPLE MULTIPLE		SEE NOTE 1	APPROVED C.ANDERSON		8/13/98	SCALE N/A		WEIGHT	SHEET 1 OF 1
USED ON NEXT ASSY			RELEASED B.MERKEL		5-15-89				
APPLICATION									

(ACAD) 64-010C