

Heyco® Snub Bushings

Multiple Locking Steps for Panel Thickness up to .125" (3,2 mm)
 Mounting Hole Diameter Range: .375" (9,5 mm) to .875" (22,2 mm)

MOUNTING HOLE DIAMETER		APPROXIMATE CABLE DIAMETER* ACCOMMODATED		PART NO. Black	DESCRIPTION	PART DIMENSIONS			
in.	mm.	in.	mm.			A Head Diameter		B Overall Height	
.375	9,5	1/8	3,2	2034	K 375-125	.46	11,7	.42	10,7
.437	11,1	3/16	4,8	2047	K 437-187	.47	11,9	.44	11,2
.500	12,7	1/4	6,4	2057	K 500-250	.56	14,2		
.625	15,9	3/8	9,5	2068	K 625-375	.73	18,5		
.750	19,1	1/2	12,7	2088	K 750-500	.91	23,0		
.875	22,2	5/8	15,9	2109	K 875-625	1.02	25,8	.48	12,3

Standard color black. Consult Heyco for white and other colors.

*Consult Heyco for other Mounting Hole and Inside Diameter configurations. Our Axcell Rapid Response Team is ready to meet your requirements.

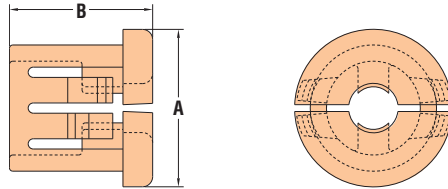

Heyco® Sealing Washers

WILL FIT THESE ELECTRICAL FITTING NPT TRADE SIZES	PART NO. Black	DESCRIPTION	PART DIMENSIONS					
			A Inside Diameter		B Outside Diameter		C Thickness	
			in.	mm.	in.	mm.	in.	mm.
1/4	3258	SW 1/4	.54	13,7	.80	20,2	.13	3,2
3/8	3259	SW 3/8	.67	17,0	1.01	25,5		
1/2	3260	SW 1/2	.85	21,6	1.24	31,5		
3/4	3261	SW 3/4	1.03	26,2	1.50	38,1	.14	3,4
1	3262	SW 1	1.28	32,5	1.77	45,0	.18	4,4
1-1/4	3264	SW 1-1/4	1.66	42,2	2.16	54,8	.16	4,1
1-1/2	3265	SW 1-1/2	1.86	47,2	2.44	62,0		
2	3257	SW 2	2.32	58,9	2.93	74,4	.18	4,6

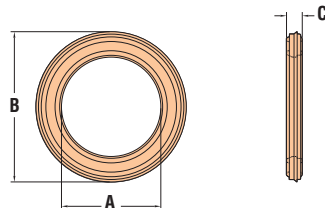

Snub Bushing		Sealing Washers	
Material	Nylon 6/6	Material	Thermoplastic Elastomer
Certifications	Recognized under the Component Program of Underwriters' Laboratories, File E15331 (Snub Bushings only) Certified by Canadian Standards Association, File 8919 (Snub Bushings only)		
Flammability Rating	94V-2		94-V0
Temperature Range	-4°F (-18°C) to 221°F (105°C)		



- The ID opens to accept the cable then closes firmly when installed into the mounting hole.
- Provide insulation plus light strain relief.
- Suitable for 1/8" (3,2 mm) to 5/8" (15,9 mm) diameter cable, tubing or hose.



- Make fittings and connectors liquid tight, dust tight, and oil tight at enclosure.
- Suitable for wet locations requiring a separate gasket between the box and fitting.
- Also suitable for other panel sealing applications.
- Easy to install since washers seal off on the perimeter, not on the connector threads.
- Special double sealing ridges compensate for minor unevenness at enclosure.
- Quick Specs below do not apply.

Quick Specs