

Heyco® Quick Connect Terminals

Male Terminal Tabs - .032 gauge – Schematic Drawings

Solder Connection Tabs

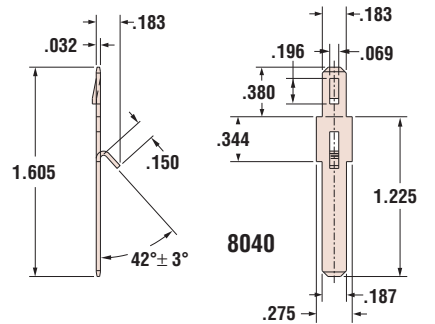
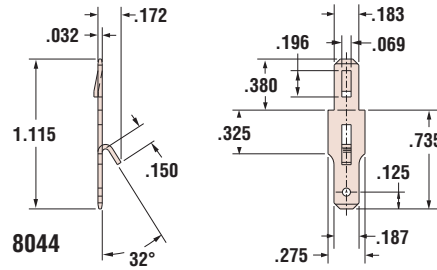
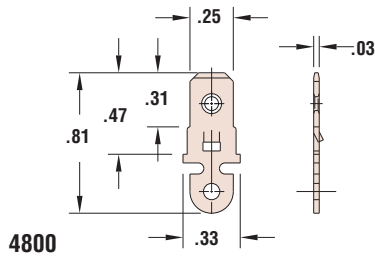
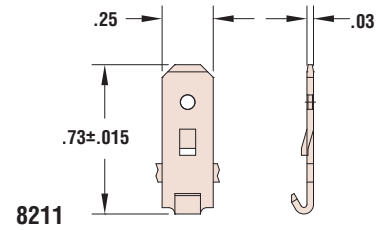
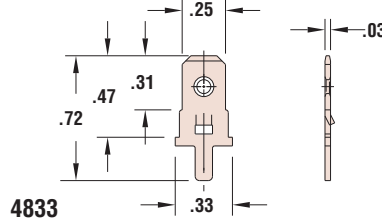
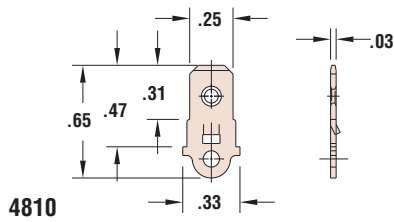

Crimp Connection Tabs

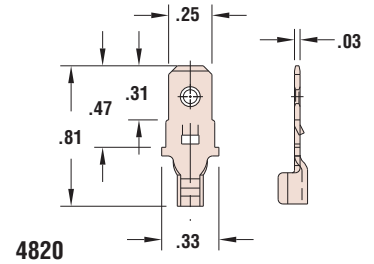
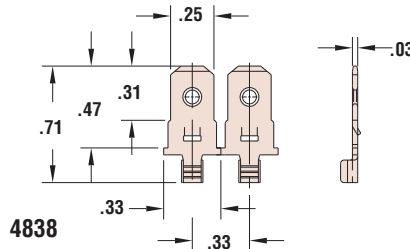
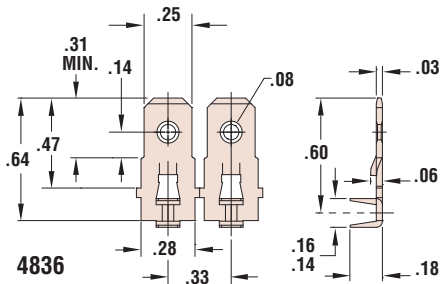

Dual Connection Tabs

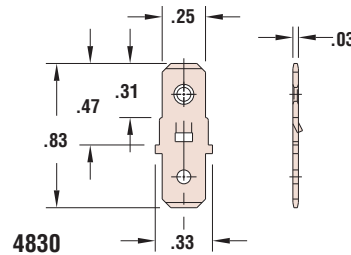
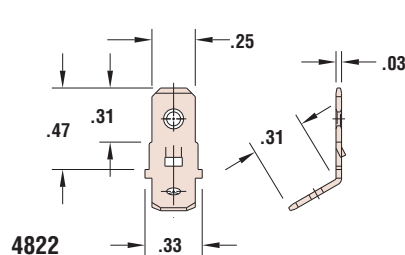

Materials

Alloy 260 Brass (70% Cu, 30% Zn. Higher Cu content resists dezincification)

Tin-Pl = Brass, Tin plated before or after stamping

*Quick
Specs*