



- Crimp all three terminals at once.
- Faster loading of plug molds.
- Reduce plug molding and cycle time.
- Reduce plug cost while improving plug quality.
- 7-Shape blades feature ledge to maintain position during overmolding.
- Pass elevated temperature pullout test with low cost PVC.
- Automated terminating equipment is available, see page 8-60.
- See page 8-60 for wire stripper information.
- DFARS Compliant

Heyco® Preassembled Cordset Components

For Heyco Application Equipment, see pages 8-59 and 8-60

Male Bridge–NEMA 5-15P

PART DATA			PART	APPLICATION TOOLING*				CRIMP DIMENSIONS																			
Type	Color	AWG Range		Die	Feeds	Crimp Punch	Anvil	A in.	B in.																		
5-15P Male Bridge	Black	18-14	S7560	Z360	Semi-Auto*	Z318, Z408	Z302	.26	.40																		
	Natural	18-14	S7561																								
	Clear	18-14	S7596																								
5-15P Male Bridge Tinned	Black	18-14	S7564							Z461	Semi-Auto*	Z446, Z454, Z444, Z453	Z445	.30	.44												
	Natural	18-14	S7599																								
	Clear	18-14	S7598																								
5-15P Male Bridge 7-Shape	Black	18-14	S7563													Z461	Semi-Auto*	Z446, Z454, Z444, Z453	Z445	.30	.44						
	Natural	18-14	S7581																								
	Clear	18-14	S7581																								
5-15P Male Bridge 7-Shp Tinned	Black	18-14	S7583																			Z461	Semi-Auto*	Z446, Z454, Z444, Z453	Z445	.30	.44
	Natural	18-14	S7585																								
	Clear	18-14	S7584																								
5-15P Male Bridge 7-Shape Nickel Plated**	Black	18-14	S7567	Z461	Semi-Auto*	Z446, Z454, Z444, Z453	Z445	.30	.44																		
5-15P Male Bridge	Black	12-10	S7590																								
	Natural	12-10	S7592																								
	Clear	12-10	S7597																								
5-15P Male Bridge Tinned	Black	12-10	S7594							Z461	Semi-Auto*	Z446, Z454, Z444, Z453	Z445	.30	.44												
	Natural	12-10	S7577																								
	Clear	12-10	S7576																								
5-15P Male Bridge 7-Shape	Black	12-10	S7591													Z461	Semi-Auto*	Z446, Z454, Z444, Z453	Z445	.30	.44						
	Natural	12-10	S7593																								
	Clear	12-10	S7589																								
5-15P Male Bridge 7-Shp Tinned	Black	12-10	S7595																			Z461	Semi-Auto*	Z446, Z454, Z444, Z453	Z445	.30	.44
	Natural	12-10	S7579																								
	Clear	12-10	S7578																								

NEW!

NEW!

NEW!

NEW!

7-Shape Blades feature a retention ledge to maintain position during overmolding (mold stop).

*Semi-Automatic Terminating Equipment is available, see below and page 8-58.

**For harsh environments.



Heyco Male Bridge Machine (see page 8-60)

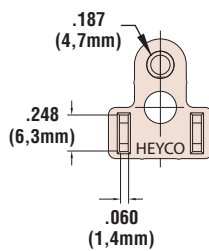

S7560

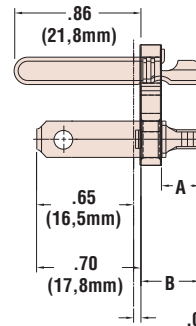

.050 REC. OVERMOLD THICKNESS ON FACE

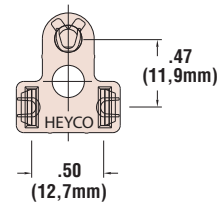

Quick Specs

Materials	Alloy 260 Brass (70% Cu, 30% Zn. Higher Cu content resists dezincification) Black and Natural - 6/6 Nylon, Clear - Polycarbonate
Certifications	Recognized Component under UL File E164169 (Component Blades only)
Standards	Certified by the Canadian Standards Association File 91824 NEMA 5-15P