

*NE BE*

# W-526-1

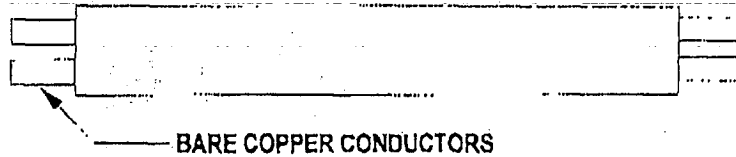
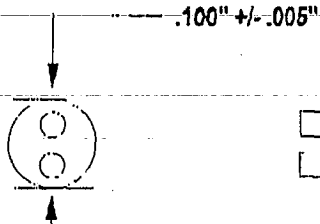

## SPECIFICATIONS:

- NO. OF CONDUCTORS: 2
- AWG: 28
- STRANDING: SOLID
- INSULATION TYPE: P.V.C.
- COND. MATERIAL: COPPER
- PLATING: N/A
- OUTER DIA: .100" +/- .005"
- MANUFACTURER: N.E.E.W.
- MAN. P/N: N31-28B-100
- VIT RATING: N/A
- INS. COLOR: -1 WHITE
- VENDOR: N.E.E.W.
- VENDOR P/N: N31-28B-100

*NE-N31-28B-100*

**BetaTHERM CORP.**  
 818 TURNPIKE RD.  
 SHREWBURY, MA, 01548

THE INFORMATION CONTAINED IN THIS DOCUMENT IS CONFIDENTIAL AND MUST NOT BE DISCLOSED EXCEPT AS AUTHORIZED IN WRITING BY BETATHERM CORPORATION.

TOL				REVISIONS				LEAD WIRE			
REV	DATE	BY		REV	DATE	BY		SCALE	DATE	DRAWN BY	MATERIAL
A				B	10/8/97	SH		NONE	10/3/97	RJL	NONE
C				D							
E				F							

*PLEASE ADVISE.*

*JM 9/22*

