

General ID Materials

BradyID.com



B-423 Polyester Material

Color: White Finish: Gloss

White polyester thermal transfer material with a glossy finish. Widely used for component identification, barcoding, asset and inventory tracking. UL rated for surfaces commonly used in solar panel manufacturing.



Performance Attributes:

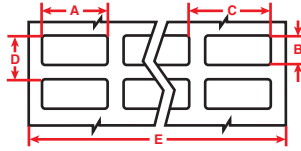

Figure 1

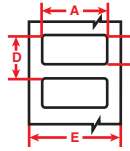

Figure 2

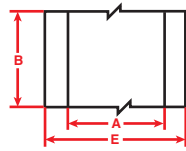

Figure 3

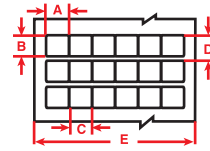

Figure 4

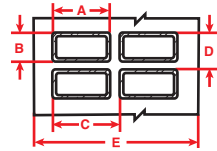

Figure 10

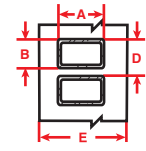

Figure 11

Diagram	Catalog #	Material	Color	Label Width A Inch (mm)	Label Height B Inch (mm)	Horiz. Repeat C Inch (mm)	Vert. Repeat D Inch (mm)	Web Width E Inch (mm)	Labels Per Row	Labels Per Pkg	Rec. Ribbon
Fig. 4	THT-11-423-10	Polyester	White	0.250 (6.4)	0.250 (6.4)	0.250 (6.4)	0.375 (9.5)	3.200 (81.3)	12	10,000	R6002
Fig. 1	THT-38-423-10	Polyester	White	0.375 (9.5)	0.375 (9.5)	0.437 (11.1)	0.475 (12.1)	3.200 (81.3)	7	10,000	R6002
Fig. 1	THT-12-423-10	Polyester	White	0.500 (12.7)	0.437 (11.1)	0.662 (16.8)	0.537 (13.6)	3.350 (85.1)	5	10,000	R6007
Fig. 1	THT-36-423-10	Polyester	White	0.500 (12.7)	0.200 (5.1)	0.625 (15.9)	0.300 (7.6)	3.200 (81.3)	5	10,000	R6002
Fig. 1	THT-14-423-10	Polyester	White	0.650 (16.5)	0.200 (5.1)	0.700 (17.8)	0.300 (7.6)	2.950 (74.9)	4	10,000	R6002
Fig. 2	THT-47-423-10	Polyester	White	0.650 (16.5)	0.200 (5.1)	-	0.300 (7.6)	0.850 (21.6)	1	10,000	R6011
Fig. 1	THT-57-423-10	Polyester	White	0.700 (17.8)	0.375 (9.5)	0.800 (20.3)	0.475 (12.1)	3.350 (85.1)	4	10,000	R6007
Fig. 1	THT-1-423-10	Polyester	White	0.750 (19.1)	0.250 (6.4)	0.800 (20.3)	0.350 (8.9)	3.350 (85.1)	4	10,000	R6007
Fig. 2	THT-46-423-10	Polyester	White	0.750 (19.1)	0.250 (6.4)	-	0.350 (8.9)	0.950 (24.1)	1	10,000	R6011
Fig. 1	THT-50-423-10	Polyester	White	0.750 (19.1)	0.750 (19.1)	0.800 (20.3)	0.875 (22.2)	3.350 (85.1)	4	10,000	R6007
Fig. 1	THT-2-423-10	Polyester	White	0.900 (22.9)	0.250 (6.4)	1.125 (28.6)	0.350 (8.9)	3.350 (85.1)	3	10,000	R6007
Fig. 2	THT-49-423-10	Polyester	White	0.900 (22.9)	0.250 (6.4)	-	0.350 (8.9)	1.100 (27.9)	1	10,000	R6006
Fig. 2	THT-103-423-10	Polyester	White	1.000 (25.4)	0.250 (6.4)	-	0.350 (8.9)	1.200 (30.5)	1	10,000	R6006
Fig. 1	THT-3-423-10	Polyester	White	1.000 (25.4)	0.375 (9.5)	1.075 (27.3)	0.475 (12.1)	3.350 (85.1)	3	10,000	R6007
Fig. 1	THT-41-423-10	Polyester	White	1.000 (25.4)	0.187 (4.8)	1.075 (27.3)	0.287 (7.3)	3.350 (85.1)	3	10,000	R6007
Fig. 2	THT-42-423-10	Polyester	White	1.000 (25.4)	0.187 (4.8)	-	0.287 (6.9)	1.200 (30.5)	1	10,000	R6006
Fig. 1	THT-51-423-10	Polyester	White	1.000 (25.4)	0.250 (6.4)	1.075 (27.3)	0.375 (9.5)	3.350 (85.1)	3	10,000	R6007
Fig. 1	THT-5-423-10	Polyester	White	1.000 (25.4)	0.500 (12.7)	1.075 (27.3)	0.600 (15.2)	3.350 (85.1)	3	10,000	R6007
Fig. 2	THT-59-423-10	Polyester	White	1.000 (25.4)	0.500 (12.7)	-	0.600 (15.2)	1.200 (30.5)	1	10,000	R6006
Fig. 1	THT-31-423-10	Polyester	White	1.100 (27.9)	0.380 (9.7)	1.200 (30.5)	0.500 (12.7)	2.500 (63.5)	2	10,000	R6002
Fig. 1	THT-13-423-10	Polyester	White	1.250 (31.8)	0.250 (6.4)	1.300 (33.0)	0.375 (9.5)	2.750 (69.9)	2	10,000	R6002
Fig. 1	THT-29-423-10	Polyester	White	1.250 (31.8)	0.375 (9.5)	1.300 (33.0)	0.475 (12.1)	2.750 (69.9)	2	10,000	R6002
Fig. 2	THT-43-423-10	Polyester	White	1.250 (31.8)	0.250 (6.4)	-	0.350 (8.9)	1.450 (36.8)	1	10,000	R6006
Fig. 10	THT-22-423-2	Polyester	White	1.250 (31.8)	0.750 (19.1)	1.650 (41.9)	1.125 (28.6)	3.350 (85.1)	2	2,000	R6002
Fig. 1	THT-40-423-10	Polyester	White	1.375 (34.9)	0.250 (6.4)	1.475 (37.5)	0.375 (9.5)	3.050 (77.5)	2	10,000	R6002
Fig. 2	THT-44-423-10	Polyester	White	1.375 (34.9)	0.250 (6.4)	-	0.350 (8.9)	1.600 (40.6)	1	10,000	R6000
Fig. 1	THT-28-423-10	Polyester	White	1.500 (38.1)	0.125 (3.2)	1.650 (41.9)	0.250 (6.4)	3.350 (85.1)	2	10,000	R6007
Fig. 1	THT-37-423-10	Polyester	White	1.500 (38.1)	0.500 (12.7)	1.650 (41.9)	0.600 (15.2)	3.350 (85.1)	2	10,000	R6007
Fig. 1	THT-4-423-10	Polyester	White	1.500 (38.1)	0.250 (6.4)	1.650 (41.9)	0.350 (8.9)	3.350 (85.1)	2	10,000	R6007
Fig. 2	THT-45-423-10	Polyester	White	1.500 (38.1)	0.250 (6.4)	-	0.350 (8.9)	1.700 (43.2)	1	10,000	R6000
Fig. 1	THT-6-423-10	Polyester	White	1.500 (38.1)	0.750 (19.1)	1.650 (41.9)	0.875 (22.2)	3.350 (85.1)	2	10,000	R6007
Fig. 3	THT-106-423	Polyester	White	2.000 (50.8)	300 ft. (91.4 m)	-	300 ft. (91.4 m)	2.200 (55.9)	1	1 Roll Cont.	R6000
Fig. 2	THT-15-423-2.5	Polyester	White	2.000 (50.8)	0.250 (6.4)	-	0.375 (9.5)	2.200 (55.9)	1	2,500	R6000
Fig. 2	THT-17-423-3	Polyester	White	2.000 (50.8)	1.000 (25.4)	-	1.125 (28.6)	2.200 (55.9)	1	3,000	R6000
Fig. 11	THT-23-423-2	Polyester	White	2.000 (50.8)	1.000 (25.4)	-	1.375 (34.9)	2.450 (62.2)	1	2,000	R6000
Fig. 2	THT-48-423-10	Polyester	White	2.000 (50.8)	0.250 (6.4)	-	0.350 (8.9)	2.200 (55.9)	1	10,000	R6000
Fig. 2	THT-53-423-3	Polyester	White	2.000 (50.8)	0.500 (12.7)	-	0.600 (15.2)	2.200 (55.9)	1	3,000	R6000
Fig. 2	THT-79-423-10	Polyester	White	2.000 (50.8)	0.400 (10.2)	-	0.500 (12.7)	2.200 (55.9)	1	10,000	R6000
Fig. 2	THT-142-423-2.5	Polyester	White	2.500 (63.5)	0.200 (5.1)	-	0.300 (7.6)	2.700 (68.6)	1	2,500	R6002
Fig. 11	THT-24-423-1	Polyester	White	2.750 (69.9)	1.750 (44.5)	-	3.200 (81.3)	-	1	1,000	R6002
Fig. 2	THT-7-423-3	Polyester	White	2.750 (69.9)	1.250 (31.8)	-	1.375 (34.9)	2.950 (74.9)	1	3,000	R6002
Fig. 2	THT-16-423-2.5	Polyester	White	3.000 (76.2)	0.250 (6.4)	-	0.375 (9.5)	3.200 (81.3)	1	2,500	R6002
Fig. 2	THT-18-423-3	Polyester	White	3.000 (76.2)	1.000 (25.4)	-	1.125 (28.6)	3.200 (81.3)	1	3,000	R6002
Fig. 2	THT-19-423-1	Polyester	White	3.000 (76.2)	2.000 (50.8)	-	2.125 (54.0)	3.200 (81.3)	1	1,000	R6002
Fig. 2	THT-184-423-1	Polyester	White	3.000 (76.2)	3.000 (76.2)	-	3.125 (79.38)	3.200 (81.28)	1	1,000	R6000
Fig. 2	THT-20-423-1	Polyester	White	3.000 (76.2)	5.000 (127.0)	-	5.125 (130.18)	3.200 (81.28)	1	1,000	R6000
Fig. 3	THT-21-423	Polyester	White	3.000 (76.2)	300 ft. (91.4 m)	-	300 ft. (91.4 m)	3.200 (81.3)	1	1 Roll Cont.	R6002
Fig. 2	THT-55-423-1	Polyester	White	4.000 (101.6)	2.000 (50.8)	-	2.125 (54.0)	4.200 (106.7)	1	1,000	R6007
Fig. 2	THT-161-423-1	Polyester	White	4.000 (101.6)	4.000 (101.6)	-	4.125 (104.8)	4.200 (106.7)	1	1,000	R6007
Fig. 2	THT-25-423-1	Polyester	White	4.000 (101.6)	6.000 (152.4)	-	6.125 (155.58)	4.200 (106.68)	1	1,000	R6000
Fig. 3	THT-107-423	Polyester	White	4.000 (101.6)	300 ft. (91.4 m)	-	300 ft. (91.4 m)	4.200 (106.7)	1	1 Roll Cont.	R6007
NOTICE BPP®12 PRINTER ONLY: The following part numbers ending with "-SC" are 1" Small Core Rolls for use in the BPP12 Printer only.											
Fig. 1	THT-5-423-5-SC	Polyester	White	1.000 (25.4)	0.500 (12.7)	1.075 (27.3)	0.600 (15.2)	3.350 (85.1)	3	5,000	R6013
Fig. 2	THT-15-423-2.5-SC	Polyester	White	2.000 (50.8)	0.250 (6.4)	-	0.350 (8.9)	2.200 (55.9)	1	2,500	R6013
Fig. 2	THT-17-423-1.5-SC	Polyester	White	2.000 (50.8)	1.000 (25.4)	-	1.125 (28.6)	2.200 (55.9)	1	1,500	R6013
Fig. 2	THT-18-423-1.5-SC	Polyester	White	3.000 (76.2)	1.000 (25.4)	-	1.125 (28.6)	3.200 (81.3)	1	1,500	R6013

THT Label Materials

General ID