



### One-Hole, Offset Floating Tongue Lug

For Use with Stranded Copper Code Conductors

#### Type CB

- Made from high strength electrolytic copper to provide premium electrical and mechanical performance
- Wide wire range-taking capability minimizes inventory requirements
- Internal pressure bar and V-bottom collar provide uniform clamping force on conductor to assure positive contact between conductor and connector
- Inspection window to visually assure full conductor insertion
- Plated steel set screw provides high strength, durable electrical contact between conductor and connector
- cULus Listed for use up to 600 V and temperature rated to 90°C where applicable

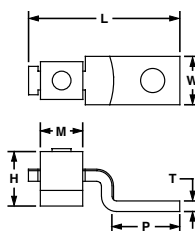

| Part Number | Conductor Size Range   | Current Rating (Amps) | Stud Hole Size (In.) | Hex Size (In.) | Figure Dimensions (In.) |      |      |      |      |      | Std. Pkg. Qty. |
|-------------|--|-----------------------|----------------------|----------------|-------------------------|------|------|------|------|------|----------------|
|             |  |                       |                      |                | L                       | W    | H    | T    | P    | M    |                |
| CB25-18-CY  | #14 AWG – #10 AWG  | 25                    | 1/8                  | **             | 1.00                    | 0.31 | 0.36 | 0.07 | 0.55 | 0.28 | 100            |
| CB35-36-CY  | #14 AWG – #6 AWG,<br>(2) #10 AWG,<br>(2) #12 AWG,<br>(2) #14 AWG,<br>(1) #10 AWG with<br>(1) #12 AWG,<br>(1) #12 AWG with<br>(1) #14 AWG | 50                    | 3/16                 | **             | 1.24                    | 0.39 | 0.49 | 0.07 | 0.59 | 0.43 | 100            |
| CBA70-14-CY | #14 AWG – #4 AWG   | 70                    | 1/4                  | **             | 1.31                    | 0.47 | 0.64 | 0.08 | 0.61 | 0.50 | 100            |
| CB70-14-CY  | #8 AWG – #2 AWG,<br>(1) #8 AWG with<br>(1) #4 AWG,<br>(1) #8 AWG with<br>(1) #6 AWG  | 90                    | 1/4                  | **             | 1.55                    | 0.47 | 0.64 | 0.08 | 0.80 | 0.50 | 100            |
| CB125-14-QY | #6 AWG – 1/0 AWG   | 125                   | 1/4                  | **             | 1.98                    | 0.62 | 0.88 | 0.10 | 1.02 | 0.60 | 25             |
| CB175-38-QY | #4 AWG – 3/0 AWG   | 175                   | 3/8                  | 3/16           | 2.20                    | 0.74 | 1.01 | 0.12 | 1.18 | 0.72 | 25             |
| CB225-56-QY | #2 AWG – 4/0 AWG   | 225                   | 5/16                 | 3/16           | 2.55                    | 0.99 |      | 0.12 |      | 0.94 | 25             |
| CB300-38-QY | 1/0 AWG – 350 kcmil  | 300                   | 3/8                  | 5/16           | 2.83                    | 0.99 | 1.39 | 0.12 | 1.33 | 1.23 | 25             |
| CB400-38-3Y | 1/0 AWG – 500 kcmil  | 400                   | 3/8                  | 5/16           | 4.09                    | 1.49 | 1.61 | 0.17 | 2.22 | 1.61 | 3              |
| CB650-12-3Y | 600 kcmil – 1000 kcmil   | 650                   | 1/2                  | 3/8            | 4.84                    | 2.00 | 2.32 | 0.25 | 2.44 | 1.85 | 3              |

\*\*Uses slotted head set screw.