



One-Hole, Straight Floating Tongue Lug

For Use with Stranded Copper Code Conductors

Type CS

- Made from high strength electrolytic copper to provide premium electrical and mechanical performance
- Wide wire range-taking capability minimizes inventory requirements
- Internal pressure bar and V-bottom collar provide uniform clamping force on conductor to assure positive contact between conductor and connector
- Inspection window to visually assure full conductor insertion
- Plated steel set screw provides high strength, durable electrical contact between conductor and connector
- cULus Listed for use up to 600 V and temperature rated to 90°C where applicable

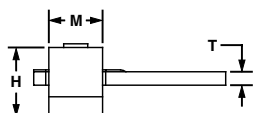
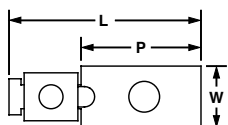

Part Number	Copper Conductor Size Range	Current Rating (Amps)	Stud Hole Size (In.)	Hex Size (In.)	Figure Dimensions (In.)						Std. Pkg. Qty.
					L	W	H	T	P	M	
CS25-18SL-CY	#14 AWG – #10 AWG	25	1/8	**	1.16	0.31	0.36	0.07	0.75	0.28	100
CS35-36SL-CY	#14 AWG – #6 AWG, (2) #10 AWG, (2) #12 AWG, (2) #14 AWG, (1) #10 AWG with (1) #12 AWG, (1) #12 AWG with (1) #14 AWG	50	3/16	**	1.14	0.38	0.49	0.07	0.60	0.43	100
CSA70-14-CY	#14 AWG – #4 AWG	70	1/4	**	1.30	0.50	0.64	0.08	0.81	0.50	100
CS70-14SL-CY	#12 AWG – #2 AWG, (1) #8 AWG with (1) #4 AWG, (1) #8 AWG with (1) #6 AWG	90	1/4	**	1.30	0.50	0.64	0.08	0.81	0.50	100
CS125-14SL-QY	#2 AWG – 1/0 AWG	125	1/4	**	1.94	0.62	0.88	0.11	1.00	0.60	25
CS175-38HK-QY	#4 AWG – 3/0 AWG	175	3/8	3/16	2.19	0.75	1.01	0.16	1.25	0.72	25
CS225-56HK-QY	#2 AWG – 4/0 AWG	225	5/16	3/16	2.38	0.99	1.13	0.12	1.19	0.94	25
CS300-38HK-QY	#1 AWG – 350 kcmil	300	3/8	5/16	3.19	0.99	1.39	0.12	1.63	1.23	25
CS400-38HK-3Y	1/0 AWG – 500 kcmil	400	3/8	5/16	3.88	1.50	1.61	0.18	2.19	1.41	3
CS650-12HK-3Y	600 kcmil – 1000 kcmil	650	1/2	3/8	5.13	2.00	2.32	0.25	2.82	1.85	3

**Uses slotted head set screw.