

Nylon Liquid Tight Strain Relief Fittings

90° Snap Elbow - PG/NPT/Metric Threads



Part Numbers				Cable Range	Thread Type & Size	Dimensions in Inches (mm)					
-40 °F to 212 °F (-40 °C to 100 °C)						A	B	C	D	E	F
Dome Fittings		Flex Fittings		Inches (mm)	See page 49 for thread specs	Clearance Hole	Body Length (Dome)	Body Length (Flex)	Height	Thread Length	Wrench Flats
								+ .01" (+.25 mm)			
ED09AA-BK	ED09AA-GY	EF09AA-BK	EF09AA-GY	.16 - .31 (4-8)	PG 9	.60 (15.2)	1.77 (45)	3.35 (85)	.91 (23)	.31 (8)	.75 (19)
ED09AR-BK	ED09AR-GY	EF09AR-BK	EF09AR-GY	.08 - .24 (2-6)							
ED11AA-BK	ED11AA-GY	EF11AA-BK	EF11AA-GY	.20 - .39 (5-10)	PG 11	.73 (18.5)	1.97 (50)	4.05 (103)	1.06 (27)	.31 (8)	.87 (22)
ED11AR-BK	ED11AR-GY	EF11AR-BK	EF11AR-GY	.11 - .28 (3-7)							
ED13AA-BK	ED13AA-GY	EF13AA-BK	EF13AA-GY	.24 - .47 (6-12)	PG 13 / 13.5	.80 (20.3)	2.24 (57)	4.69 (119)	1.20 (30.5)	.35 (9)	.94 (24)
ED13AR-BK	ED13AR-GY	EF13AR-BK	EF13AR-GY	.20 - .35 (5-9)							
ED16AA-BK	ED16AA-GY	EF16AA-BK	EF16AA-GY	.39 - .55 (10-14)	PG 16	.89 (22.5)	2.32 (59)	5.12 (130)	1.28 (32.5)	.39 (10)	1.06 (27)
ED16AR-BK	ED16AR-GY	EF16AR-BK	EF16AR-GY	.27 - .47 (7-12)							
ED21AA-BK	ED21AA-GY	EF21AA-BK	EF21AA-GY	.51 - .71 (13-18)	PG 21	1.12 (28.4)	2.87 (73)	6.14 (156)	1.57 (40)	.43 (11)	1.30 (33)
ED21AR-BK	ED21AR-GY	EF21AR-BK	EF21AR-GY	.35 - .63 (9-16)							
ED29AA-BK	ED29AA-GY	-	-	.71 - .98 (18-25)	PG 29	1.47 (37.3)	3.58 (91)	-	2.03 (51.5)	.43 (11)	1.65 (42)
ED29AR-BK	ED29AR-GY	-	-	.51 - .79 (13-20)							
ED09NA-BK	ED09NA-GY	EF09NA-BK	EF09NA-GY	.16 - .31 (4-8)	3/8" NPT	.68 (17.2)	1.77 (45)	3.35 (85)	.91 (23)	.59 (15)	.75 (19)
ED09NR-BK	ED09NR-GY	EF09NR-BK	EF09NR-GY	.08 - .24 (2-6)							
ED13NA-BK	ED13NA-GY	EF13NA-BK	EF13NA-GY	.24 - .47 (6-12)	1/2" NPT	.83 (21.1)	2.24 (57)	4.69 (119)	1.20 (30.5)	.51 (13)	.94 (24)
ED13NR-BK	ED13NR-GY	EF13NR-BK	EF13NR-GY	.20 - .35 (5-9)							
ED16NA-BK	ED16NA-GY	EF16NA-BK	EF16NA-GY	.39 - .55 (10-14)	1/2"-E NPT	.83 (21.1)	2.32 (59)	5.12 (130)	1.28 (32.5)	.51 (13)	1.06 (27)
ED16NR-BK	ED16NR-GY	EF16NR-BK	EF16NR-GY	.27 - .47 (7-12)							
ED21NA-BK	ED21NA-GY	EF21NA-BK	EF21NA-GY	.51 - .71 (13-18)	3/4" NPT	1.05 (26.7)	2.87 (73)	6.14 (156)	1.57 (40)	.51 (13)	1.30 (33)
ED21NR-BK	ED21NR-GY	EF21NR-BK	EF21NR-GY	.35 - .63 (9-16)							
ED29NA-BK	ED29NA-GY	-	-	.71 - .98 (18-25)	1" NPT	1.35 (34.3)	3.58 (91)	-	2.03 (51.5)	.75 (19)	1.65 (42)
ED29NR-BK	ED29NR-GY	-	-	.51 - .79 (13-20)							
ED16MA-BK	ED16MA-GY	EF16MA-BK	EF16MA-GY	.16 - .31 (4-8)	M16 x 1.5	.63 (16)	1.77 (45)	3.35 (85)	.91 (23)	.31 (8)	.75 (19)
ED16MR-BK	ED16MR-GY	EF16MR-BK	EF16MR-GY	.08 - .24 (2-6)							
ED20MA-BK	ED20MA-GY	EF20MA-BK	EF20MA-GY	.24 - .47 (6-12)	M20 x 1.5	.79 (20)	2.24 (57)	4.68 (119)	1.20 (30.5)	.35 (9)	.94 (24)
ED20MR-BK	ED20MR-GY	EF20MR-BK	EF20MR-GY	.20 - .35 (5-9)							
ED25MA-BK	ED25MA-GY	EF25MA-BK	EF25MA-GY	.51 - .71 (13-18)	M25 x 1.5	.98 (25)	2.87 (73)	6.14 (156)	1.57 (40)	.43 (11)	1.30 (33)
ED25MR-BK	ED25MR-GY	EF25MR-BK	EF25MR-GY	.35 - .63 (9-16)							
ED32MA-BK	ED32MA-GY	-	-	.71 - .98 (18-25)	M32 x 1.5	1.26 (32)	3.58 (91)	-	2.03 (51.5)	.43 (11)	1.65 (42)
ED32MR-BK	ED32MR-GY	-	-	.51 - .79 (13-20)							

*Note: VDE rating applies to Metric Dome Fittings.

Liquid Tight Elbow Strain Relief Fitting for space and time saving applications.

Swivel Elbow also available! Visit www.sealconusa.com for product information. (PG Thread)

Suggested Clearance Hole for Non-Threaded Mounting

O-Ring (PG & Metric Threads Only.)
Protection O-Ring: IP68, Buna-N.

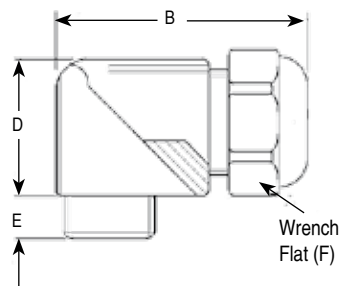

Optional Locking Nuts & Other Accessories starting on Page 28 - 39.

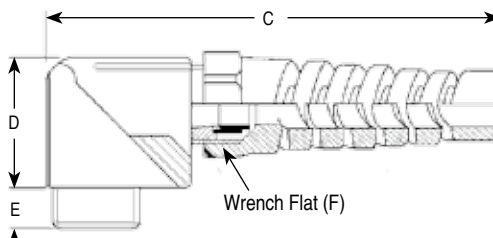

For Material Specifications and Approval Information, please refer to page 45.