

EPIC® HB 6 Standard Hoods

Single Lever Bolts

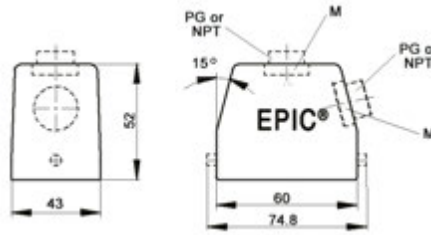

all dimensions are in mm.

Technical Data

Specifications:	DIN 43652	IP Protection Class:	NEMA 4, NEMA 12, IP65
Temperature Range:	-40°C to + 125°C	Material:	Powder-coated aluminum alloy

PG	Size of Entry		PG	Part Number		Complete the Installation: SKINTOP® Strain Relief			
	NPT	Metric		NPT	Metric	PG Plastic	PG Metal	Metric Plastic	Metric Metal
Top Entry									
13	1/2"	20	100110R	100110NP	19011000*	53015030	52015700	53111020	53112020
16	1/2"	25	100210	100210NP	19021000*	53015040	52015740	53111030	53112030
Side Entry									
13	1/2"	20	100120	100120NP	19012000	53015030	52015740	53111030	53112030
16	1/2"	25	100220	100220NP	19022000	53015040	52015740	53111030	53112030

* Metric top-entry hoods do not come with a neck.

Approvals



Complete the Installation

HB Dust Covers
page 419

EPIC® HB 6 High Profile Hoods

Single Lever Bolts

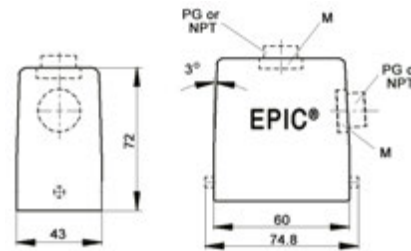

all dimensions are in mm.

Technical Data

Specifications:	DIN 43652	IP Protection Class:	NEMA 4, NEMA 12, IP65
Temperature Range:	-40°C to + 125°C	Material:	Powder-coated aluminum alloy

PG	Size of Entry		PG	Part Number		Complete the Installation: SKINTOP® Strain Relief			
	NPT	Metric		NPT	Metric*	PG Plastic	PG Metal	Metric Plastic	Metric Metal
Top Entry									
21	3/4"	25	700202	700202NP	79020200	53015050	52015750	53111030	53112030
29	1"	32	700204R	700204NP	79020400	53015060	52015760	53111040	53112040
Side Entry									
21	3/4"	25	700222	700222NP	79022200	53015050	52015750	53111030	53112030
29	1"	32	700224R	700224NP	79022400	53015060	52015760	53111040	53112040

* Metric hoods do not come with a neck.

Approvals



Complete the Installation

HB Dust Covers
page 419

Photographs are not to scale and are not true representations of the products in question. If not otherwise specified, all values relating to the product are nominal values. For current information go to our website.

EPIC® HB 6 Panel Mount Bases

Single Lever

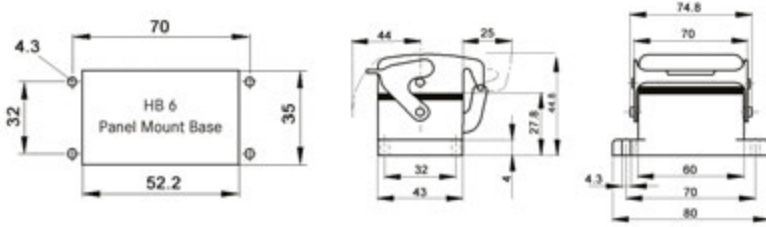

all dimensions are in mm.



Technical Data

Specifications:	DIN 43652	Protection Class:	NEMA 4, NEMA 12, IP65
Temperature Range:	-40°C to + 125°C	Material:	Powder-coated aluminum alloy

Description	Part Number
Panel Mount Base	100030C0
Panel Mount Base with Dust Cover	100040C0

Approvals



Complete the Installation



HB Dust Covers
page 419

EPIC® HB 6 Surface Mount Bases

Single Lever

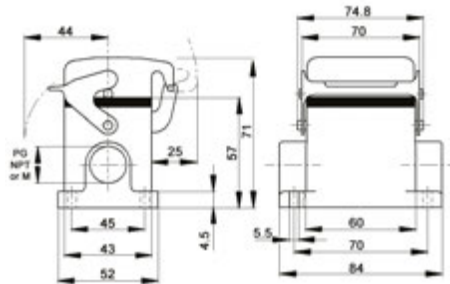

all dimensions are in mm.



Technical Data

Specifications:	DIN 43652	Protection Class:	NEMA 4, NEMA 12, IP65
Temperature Range:	-40°C to + 125°C	Material:	Powder-coated aluminum alloy

PG	Size of Entry		PG	Part Number		Complete the Installation: SKINTOP® Strain Relief			
	NPT	Metric		NPT	Metric	PG Plastic	PG Metal	Metric Plastic	Metric Metal
2 Entries									
16	1/2"	20	100060	100060NP	19006000	53015040	52015740	53111020	53112020
—	—	25	—	—	79006600	—	—	53111030	53112030
1 Entry									
16	1/2"	20	100050	100050NP	19005000	53015040	52015740	53111020	53112020
—	—	25	—	—	79005600	—	—	53111030	53112030
2 Entries with Dust Cover									
16	1/2"	20	100090	100090NP	19009000	53015040	52015740	53111020	53112020
—	—	25	—	—	79016600	—	—	53111030	53112030
1 Entry with Dust Cover									
16	1/2"	20	100070	100070NP	19007000	53015040	52015740	53111020	53112020
—	—	25	—	—	79015600	—	—	53111030	53112030

Approvals



Complete the Installation



HB Dust Covers
page 419

Photographs are not to scale and are not true representations of the products in question.
If not otherwise specified, all values relating to the product are nominal values. For current information go to our website.

EPIC® HB 6 High Profile Surface Mount Bases

Single Lever

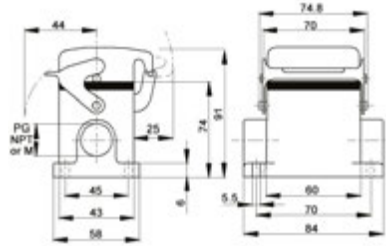

all dimensions are in mm.

Technical Data

Specifications:	DIN 43652	IP Protection Class:	NEMA 4, NEMA 12, IP65
Temperature Range:	-40°C to + 125°C	Material:	Powder-coated aluminum alloy

PG	Size of Entry		PG	Part Number		Complete the Installation: SKINTOP® Strain Relief			
	NPT	Metric		NPT	Metric	PG Plastic	PG Metal	Metric Plastic	Metric Metal
2 Entries									
21	3/4"	25	700062	700062NP	79006200	53015050	52015750	53111030	53112030
29	1"	32	-	-	79006400	-	-	53111040	53112040
1 Entry									
21	3/4"	25	700052	700052NP	79005200	53015050	52015750	53111030	53112030
29	1"	32	700054	700054NP	79005400	53015060	52015760	53111040	53112040
2 Entries with Dust Cover									
21	3/4"	25	700162	700162NP	79016200	53015050	52015750	53111030	53112030
29	1"	32	-	-	79016400	-	-	53111040	53112040
1 Entry with Dust Cover									
21	3/4"	25	700152	700152NP	79015200	53015050	52015750	53111030	53112030
29	1"	32	-	-	79015400	-	-	53111040	53112040

Approvals



Complete the Installation

HB Dust Covers
page 419

EPIC® HB 6 Cable Coupler Hoods

Single Lever



Standard Profile

High Profile

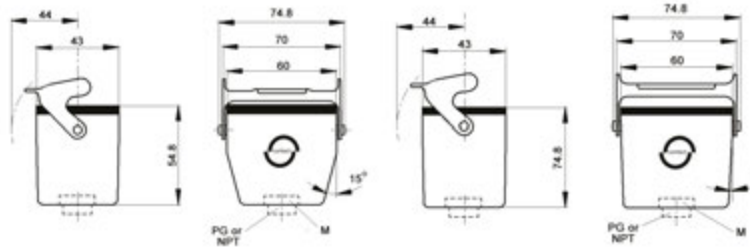

all dimensions are in mm.

Technical Data

Specifications:	DIN 43652	IP Protection Class:	NEMA 4, NEMA 12, IP65
Temperature Range:	-40°C to + 125°C	Material:	Powder-coated aluminum alloy

PG	Size of Entry		PG	Part Number		Complete the Installation: SKINTOP® Strain Relief			
	NPT	Metric		NPT	Metric*	PG Plastic	PG Metal	Metric Plastic	Metric Metal
Standard Profile									
13	1/2"	20	100140	100140NP	19014000	53015050	52015750	53111030	53112030
16	1/2"	25	100240	100240NP	19024000	53015060	52015760	53111040	53112040
High Profile									
21	3/4"	25	700102	700102NP	79010200	53015050	52015750	53111030	53112030
29	1"	32	700104	700104NP	-	53015060	52015760	-	-

* Metric hoods do not come with a neck.

Approvals



Complete the Installation

HB Dust Covers
page 419