

**NOTICE**

THIS DRAWING EMBODIES A CONFIDENTIAL PROPRIETARY DESIGN ORIGINATED BY G.W. LISK COMPANY, INC. AND ALL DESIGN, MANUFACTURING, REPRODUCTION, USE, AND SALE RIGHTS REGARDING THE SAME ARE EXPRESSLY RESERVED. IT IS SUBMITTED UNDER A CONFIDENTIAL RELATIONSHIP FOR A SPECIFIC PURPOSE, AND THE RECIPIENT AGREES BY ACCEPTING THIS DRAWING NOT TO SUPPLY OR DISCLOSE ANY INFORMATION REGARDING IT TO ANY UNAUTHORIZED PERSON, OR TO INCORPORATE IN OTHER PROJECTS ANY SPECIAL FEATURES PECULIAR TO THIS DESIGN. ALL PATENT RIGHTS HERETO ARE EXPRESSLY RESERVED BY G.W. LISK COMPANY, INC., CLIFTON SPRINGS, NEW YORK.

**REVISIONS**

REV	DESCRIPTION	DATE	APPROVED
A	62.5 WAS 58.50 62.0 58.00 J.MILLIMAN 02JUN17	02JUN17	J. TRICKEY
P.A.D. U FINAL U NEXT HLA U PART NUMBER U		3	

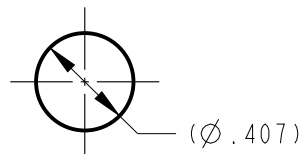
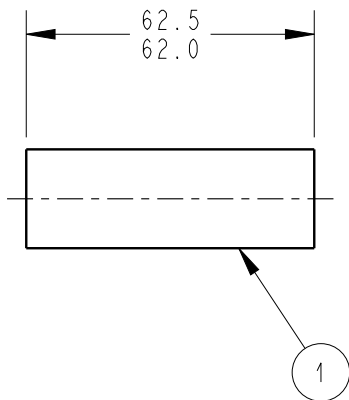

**CONTROLLED PROCESSING PER PWI 04.01.03  
NO MODIFICATIONS PERMITTED WITHOUT  
AUTHORIZATION BY THE QUALITY ENGINEER.**

**Q.E.** J. STANDARD 06JUN17

1	VY2-4073	WIRE SLEEVE - BULK	A/R
ITEM	PART NUMBER	DESCRIPTION	QTY

**UNLESS OTHERWISE SPECIFIED**

~~93 Ra FINISH ALL OVER  
SMOOTH FINISH FOR APPEARANCE ONLY  
RUNOUT BETWEEN COAXIAL DIAMETERS NOT TO EXCEED .005 FULL INDICATOR MOVEMENT  
BREAK ALL SHARP EDGES .010 MAX ALL MACHINED INSIDE CORNERS R. .010 MAX  
RADIUS OR CHAMFER ACCEPTABLE~~

DIMENSIONS ARE IN INCHES  
INTERPRET DIM AND TOL PER ASME Y14.5-2009  
THIRD ANGLE PROJECTION

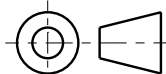

DRAWN	
R. STRANG	29JAN16
CHECK	
J. TRICKEY	01FEB16
ENGINEER	
J. TRICKEY	01FEB16
NEXT ASSY	
TBD	
JOB NO	
TBD	

**G. W. LISK CO., INC.**  
CLIFTON SPRINGS, NEW YORK

**WIRE SLEEVE**

SIZE	CAGE CODE	DWG NO.	REV
<b>A</b>	<b>81983</b>	<b>VY2-4093</b>	<b>A</b>
DO NOT SCALE	1.000	WEIGHT	SHEET 1 OF 1