

# Bundling and Securing

## Clamps

### In-Line Ratchet P-Clamp

#### Oval Fir Tree Mount - 7 x 12 mm

The In-line Ratchet P-Clamp family offers versatility when managing wires, cables and hoses. Built-in attachments include round and oval fir trees and adhesive mounts, so no additional hardware is needed for securing to a hole or panel. The robust design and durable materials make it ideal for heavy duty applications, both indoors and out. The adjustable clamp can be closed by hand to the desired diameter. The release feature allows easy and nondestructive removal of cables simply by using a flat-head screwdriver. In this way, the clamp can be reused or serviced without removing it from the mounting surface. The clamp is offered in four sizes to accommodate bundles from 0.25" to 2" in diameter.

#### Features and Benefits

- One-piece ratchet closure allows for easy installation during pre- or final assembly.
- Easy release feature simplifies quick adjustments and maintenance.
- Impact modified, heat and UV stabilized PA66 provides long-term durability, indoors and out.
- High-performing oval fir trees ensure anti-rotational routing in existing or stamped oval or rectangular holes with no additional hardware required.



<b>MATERIAL</b>	Polyamide 6.6 high impact modified, heat and UV stabilized (PA66HIRHSUV)
<b>Operating Temperature</b>	-40°F to +257°F (-40°C to +125°C)
<b>Flammability</b>	UL 94 HB
<b>Color</b>	Black (BK)

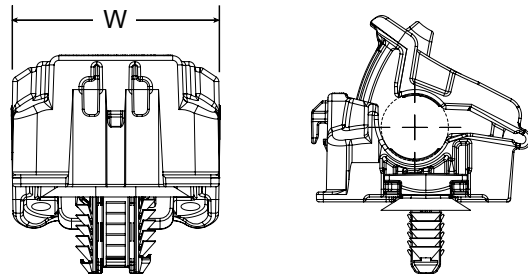

PART NO.	TYPE	Min. Bundle Diameter in. (mm)	Max. Bundle Diameter in. (mm)	Min. Tensile Strength lbs. (N)	Mounting Hole Dia. in. (mm)	Panel Thickness in. (mm)	Fixation Method	Width (W) in. (mm)	Pkg. Qty.
156-02618	IRCAFTOVAL	0.2 (6.1)	0.5 (13.7)	100.0 (445.0)	0.28 x 0.47 (7.0 x 12.0)	0.02 - 0.27 (0.6 - 6.8)	Fir Tree for oval holes	1.4 (34.9)	250
156-02710		0.2 (6.1)	0.5 (13.7)	100.0 (445.0)	0.28 x 0.47 (7.0 x 12.0)	0.02 - 0.27 (0.6 - 6.8)	Fir Tree for oval holes	1.4 (34.9)	25
156-02628	IRCBFTOVAL	0.5 (12.7)	0.8 (19.6)	100.0 (445.0)	0.28 x 0.47 (7.0 x 12.0)	0.02 - 0.27 (0.6 - 6.8)	Fir Tree for oval holes	1.4 (34.9)	250
156-02711		0.5 (12.7)	0.8 (19.6)	100.0 (445.0)	0.28 x 0.47 (7.0 x 12.0)	0.02 - 0.27 (0.6 - 6.8)	Fir Tree for oval holes	1.4 (34.9)	25
156-02638	IRCCFTOVAL	0.8 (19.3)	1.4 (36.0)	100.0 (445.0)	0.28 x 0.47 (7.0 x 12.0)	0.02 - 0.27 (0.6 - 6.8)	Fir Tree for oval holes	1.4 (34.9)	250
156-02712		0.8 (19.3)	1.4 (36.0)	100.0 (445.0)	0.28 x 0.47 (7.0 x 12.0)	0.02 - 0.27 (0.6 - 6.8)	Fir Tree for oval holes	1.4 (34.9)	25
156-02648	IRCDFTOVAL	1.4 (36.0)	2.0 (50.8)	100.0 (445.0)	0.28 x 0.47 (7.0 x 12.0)	0.02 - 0.27 (0.6 - 6.8)	Fir Tree for oval holes	1.4 (34.9)	200
156-02713		1.4 (36.0)	2.0 (50.8)	100.0 (445.0)	0.28 x 0.47 (7.0 x 12.0)	0.02 - 0.27 (0.6 - 6.8)	Fir Tree for oval holes	1.4 (34.9)	25

Dimensions are approximate and subject to technical changes. Use Part No. for ordering and Type for specification purposes.