

CSA Teck 90 Control Cable

1000 V Multiconductor, Teck 90 Cable
14-10 AWG, XLP insulation
Aluminum Interlocked Armor
Inner and Outer PVC jackets
Rated HL (Hazardous Locations)

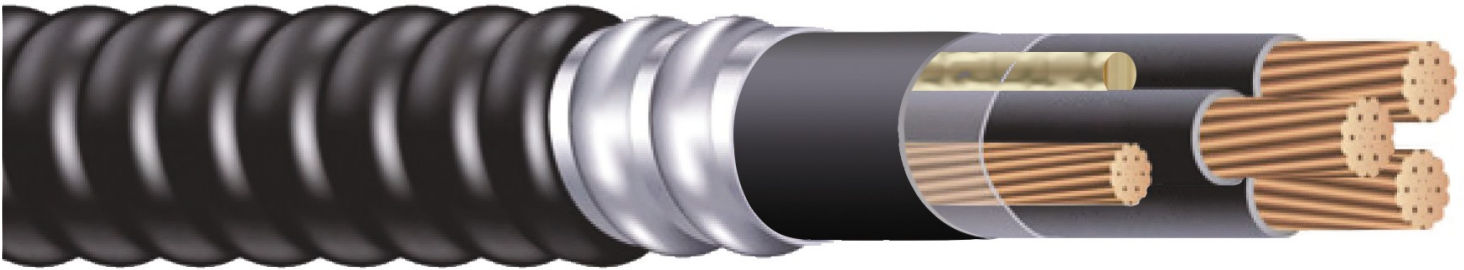

HOW IT'S USED

For exposed or concealed wiring in wet or dry locations. For use in ventilated, non-ventilated and ladder type cable troughs and ventilated flexible cableway in wet or dry locations. Cable is sunlight resistance. Typical applications are for power, lighting and control circuits in: pulp and paper mills, steel mills, food processing plants, commercial centers, mines, generating stations, refineries, industrial plants and chemical plants.

HOW IT'S MADE

- **CONDUCTOR:** Class B stranded, bare, soft copper
- **INSULATION:** Cross-Linked Polyethylene (XLP) as approved by CSA on Types RW90 XLP -40°C per CSA C22.2, No. 131; LL90458, color code: 2/C black, white; 3/C red, black, blue; 4/C red, black, blue, white; more than 4/C numbered
- **GROUNDING CONDUCTOR:** An uninsulated Class B stranded grounding conductor is included in the cable assembly
- **ASSEMBLY:** Multiple conductor cables are assembled with suitable fillers and binder tape
- **INNER JACKET:** Polyvinyl Chloride (PVC) heat, flame and moisture-resistant jacket, rated -40°C
- **ARMOR:** Aluminum interlocking armor
- **OVERALL JACKET:** Polyvinyl Chloride (PVC) heat, flame and moisture-resistant jacket, rated -40°C, the standard color is black but colored jackets will be provided on request meets Flame Test in accordance with Ontario Hydro Spec. L-891 SM-77, meets Flame Test in IEEE 383 and FT-4 or better. Sunlight Resistant.
- **AMPACITY:** Based on not more than three conductors in raceway or cable at an ambient temperature of 30°C per Table 2, Column 4 of the Canadian Electrical Code, these ampacities are also based on a minimum one cable O.D. spacing between adjacent cables, (for a four conductor cable the fourth conductor is considered to be the neutral of a three-phase, 4-wire-system)
- **TEMPERATURE:** -40°C to 90°C
- **VOLTAGE:** 1000 V

HOW IT'S CERTIFIED

Southwire's Teck 90 Control Cable meets CSA C22.2, No. 131.

CSA Teck90 Control Cable

Stock Number	Size	No. Of Conds.	Ground Wiring	Approx. Diameter Inner Jacket (in.)	Approx. Diameter Armor (in)	Approx. Diameter Outer Jacket (in)	Amcapacity 30°C Ambient (amps)			Approx. Wt. lb/1,000 ft
							60°C	75°C	90°C	
562239	14	2	14	0.361	0.571	0.651	15	15	15	187
561780	14	3	14	0.382	0.592	0.672	15	15	15	215
561781	14	4	14	0.415	0.625	0.705	15	15	15	240
561788	14	5	14	0.452	0.662	0.742	15	15	15	265
562248	14	6	14	0.490	0.700	0.781	15	15	15	293
561789	14	7	14	0.490	0.700	0.781	15	15	15	310
562254	14	8	14	0.561	0.771	0.851	15	15	15	360
562258	14	10	14	0.650	0.860	0.940	15	15	15	423
561790	14	12	14	0.671	0.881	0.961	15	15	15	465
562263	14	15	14	0.742	0.952	1.032	15	15	15	537
561791	14	19	14	0.780	1.100	1.180	15	15	15	675
562269	14	20	14	0.820	1.140	1.220	15	15	15	703
561778	14	25	14	0.949	1.269	1.350	15	15	15	874
561792	12	2	12	0.396	0.606	0.686	20	20	20	218
561793	12	3	12	0.420	0.630	0.710	20	20	20	252
561794	12	4	12	0.457	0.667	0.747	20	20	20	290
563506	12	10	12	0.720	0.930	1.011	20	20	20	529
561796	12	12	12	0.744	0.954	1.034	20	20	20	589
563511	12	15	12	0.865	1.185	1.266	20	20	20	788
563515	12	20	12	0.953	1.273	1.354	20	20	20	950
561797	10	3	12	0.470	0.680	0.761	30	30	30	314
561798	10	4	12	0.514	0.724	0.804	30	30	30	367