

1. CONDUCTOR

Material: Heavy Tin Plated Copper
 Construction: 22 AWG 19/34
 Diameter: 0.031"

2. INSULATION

Material: Crosslinked Polyethylene
 Wall thickness: See Table 1
 Diameter: See Table 1
 Color: Black
 Marking: Extruded White Stripe on Center Leg (G)

3. PHYSICAL CHARACTERISTICS

Temperature rating: 135°C
 Voltage rating: 50 V DC
 Weight: 15.3 lbs per 1000 ft

4. PERFORMANCE PROPERTIES

INSULATION

Mechanical – SAE J1128 Type TXL

Tensile Strength

Unaged 1500 psi, min

Aged (168 hrs @ 165°C) 80% retention, min

Elongation

Unaged 150%, min

Aged (168 hrs @ 165°C) 50% retention, min

Crosslinking Core Not Visible

Customer Processing

Sections must separate without exposing conductor

Electrical - SAE J1128

Dielectric Strength 1000V, 60 Hz, 60 Sec

Spark Test 3000V_{ac}

Conductor (ASTM B3)

DC Resistance 15.0 Ohms per 1000 ft

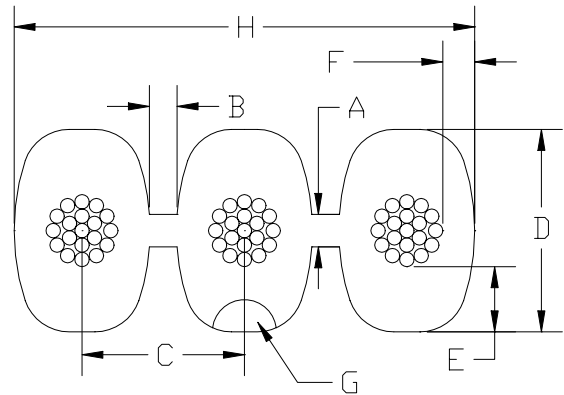

PERFORMANCE PROPERTIES (cont'd)

Thermal - SAE J1128

Flame Resistance 70 Sec Burn, Max

Chemical - SAE J1128

Fluid Compatibility O.D. Change, max

Engine Oil (IRM 902) 15%

Gasoline (Ref. Fuel C) 15%

Ethanol / Ref. Fuel C Mixture 15%

Diesel Fuel 15%

Power Steering (IRM 903) 30%

Auto Trans. (Dexron III) 25%

Engine Coolant 50/50 15%

Battery Acid (sp. Gr. ~ 1.26) 5%

Solderability

Mil-Std-202 Method 208 Cat 2 Complies

5. REFERENCE SPECIFICATION

Society Automotive Engineers – J1128

Table 1

| Insulation (See Schematic) | | | | | | | | |
|----------------------------|--------|--------------------|--------------------|--------|--------|--------|--------|--------------------|
| A, nom | B, nom | C | D | E | | F | | H |
| | | | | Min | Nom | Min | Nom | Nom |
| 0.014" | 0.011" | 0.070" ± 0.005" | 0.087" ± 0.005" | 0.018" | 0.028" | 0.008" | 0.015" | 0.197" ± 0.005" |



JUDD WIRE INC.
 124 Turnpike Road
 Turners Falls, MA 01376
 (413) 863-4357

| Date | Rev | By | Appr'd | ECN |
|--------------------|-----|-----|--------|--------|
| 06/23/05 | -- | GBM | EJK | |
| 06/24/10 | A | EJK | ARJP | 10-801 |
| 08/10/10 | B | EJK | ARJP | 10-815 |
| Customer Approval: | | | | |

Description:
3/C, PARALLEL, 22 AWG, XLPE, TXL

Specification Number:
P02608

Page:
 1 of 1