



## Rigid and Flexible Stranded Metric Conductor, One-Hole, Standard Barrel with Window Lug, 45° Angle



For use with Class 2R Rigid Strand and Flexible Strand Class 5F and 6F Copper Conductors

### Type LCMA-H

- Inspection window to visually assure full conductor insertion
- Tin-plated to inhibit corrosion
- UL Listed and CSA Certified to 35 kV\*\* and temperature rated to 90°C when crimped with Panduit tools and dies
- Approved for Marine use by American Bureau of Shipping
- Class 2r, Class 5f and Class 6f wire sizes and stud hole size marked on connector for selection and installation
- Rounded tongue for use in tight spaces
- Internally beveled wire entry for fast and easy installation
- Meets EN61238-1:2003/IEC 61238-1-2003 Class B for 4mm<sup>2</sup>-240mm<sup>2</sup> Class 2r wire sizes
- CE compliant sizes 4mm<sup>2</sup>-240mm<sup>2</sup> Class 2r wire sizes

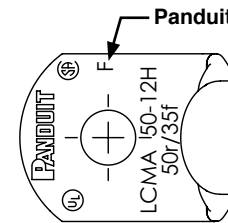
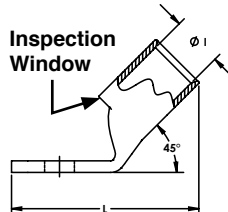
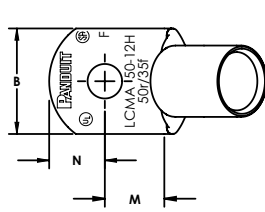

Rigid and Flexible Stranded Conductor Sizes Marked on Part

Part Number	Copper Conductor Size Class 2r (mm <sup>2</sup> )	Copper Conductor Size class 5f/6f <sup>^</sup> (mm <sup>2</sup> )	Stud Hole Size (mm)	Figure Dimensions					Std. Pkg. Qty.
				ØI	B	M	N	L	
LCMA10-5H-C	10	—	M5	4.5	11	9.8	6	27.6	100
LCMA10-6H-C	10	—	M6	4.5	11	9.8	6	27.6	100
LCMA10-8H-C	10	—	M8	4.5	13	8.5	8	27.7	100
LCMA10-10H-C	10	—	M10	4.4	14.5	8.5	8	28	100
LCMA16-5H-C	16	10	M5	5.5	13	10.3	6.5	30.4	100
LCMA16-6H-C	16	10	M6	5.5	13	10.3	6.5	30.4	100
LCMA16-8H-C	16	10	M8	5.5	13	10.3	6.5	30.3	100
LCMA16-10H-C	16	10	M10	5.5	15	10.2	8	32.3	100
LCMA25-6H-C	25	16	M6	6.9	14	10	8	31.8	100
LCMA25-8H-C	25	16	M8	6.9	15.5	10	8	31.8	100
LCMA25-10H-C	25	16	M10	6.9	15.5	10	8	31.7	100
LCMA35-6H-C	35	25	M6	8.2	15.5	12.3	8.5	36.7	100
LCMA35-8H-C	35	25	M8	8.2	15.5	12.3	8.5	36.7	100
LCMA35-10H-C	35	25	M10	8.2	15.5	12.3	8.5	36.7	100
LCMA35-12H-C	35	25	M12	8.2	21.5	14.5	11.5	42.1	100
LCMA50-6H-L	50	35	M6	9.8	18	11.5	10	40.1	50
LCMA50-8H-L	50	35	M8	9.8	18	11.5	10	40.1	50
LCMA50-10H-L	50	35	M10	9.8	18	11.5	10	40.1	50
LCMA50-12H-L	50	35	M12	9.8	23	14	11	43.1	50

Visit [www.panduit.com/tools](http://www.panduit.com/tools) for tool and die information.

<sup>^</sup>Class 5f conductor only.

\*\*Consult cable manufacturer for voltage stress relief instructions with applications greater than 2000 V.

<sup>^</sup>Not CE compliant and not tested to EN 61238-1:2003/IEC 61238-1:2003 for terminations with metric Class 5f or Class 6f flexible stranded conductor.

Continues on next page

**Rigid and Flexible Stranded Metric Conductor, One-Hole,  
Standard Barrel with Window Lug, 45° Angle (continued)**

Part Number	Copper Conductor Size Class 2r (mm <sup>2</sup> )	Copper Conductor Size class 5f/6f <sup>^</sup> (mm <sup>2</sup> )	Stud Hole Size (mm)	Figure Dimensions					Std. Pkg. Qty.
				ØI	B	M	N	L	
LCMA70-6H-L	70	50	M6	11.5	20.8	14.5	11.5	46.8	50
LCMA70-8H-L	70	50	M8	11.5	20.8	14.5	11.5	46.8	50
LCMA70-10H-L	70	50	M10	11.5	20.8	14.5	11.5	46.8	50
LCMA70-12H-L	70	50	M12	11.5	20.8	14.5	11.5	46.7	50
LCMA95-8H-L	95	70	M8	13.5	24.5	15	13.5	52.6	50
LCMA95-10H-L	95	70	M10	13.5	24.5	15	13.5	52.6	50
LCMA95-12H-L	95	70	M12	13.5	24.5	15	13.5	52.6	50
LCMA95-16H-L	95	70	M16	13.5	24.5	15	13.5	52.5	50
LCMA120-8H-L	120	95	M8	15.2	27.5	15.5	14.5	56.6	50
LCMA120-10H-L	120	95	M10	15.2	27.5	15.5	14.5	56.6	50
LCMA120-12H-L	120	95	M12	15.2	27.5	15.5	14.5	56.6	50
LCMA120-16H-L	120	95	M16	15.2	27.5	15.5	14.5	56.6	50
LCMA150-8H-X	150	120	M8	16.5	30.5	18	16.5	64.7	10
LCMA150-10H-X	150	120	M10	16.5	30.5	18	16.5	64.7	10
LCMA150-12H-X	150	120	M12	16.5	30.5	18	16.5	64.7	10
LCMA150-16H-X	150	120	M16	16.5	30.5	18	16.5	64.6	10
LCMA150-20H-X	150	120	M20	16.5	30.5	22	16.5	68.3	10
LCMA185-10H-X	185	150	M10	18.6	33.5	16.5	17.5	66	10
LCMA185-12H-X	185	150	M12	18.6	33.5	16.5	17.5	66	10
LCMA185-16H-X	185	150	M16	18.6	33.5	16.5	17.5	66	10
LCMA185-20H-X	185	150	M20	18.6	33.5	21	17.5	70.5	10
LCMA240-10H-X	240	185	M10	20.8	37.5	21	19.5	79.3	10
LCMA240-12H-X	240	185	M12	20.8	37.5	21	19.5	79.3	10
LCMA240-16H-X	240	185	M16	20.8	37.5	21	19.5	79.3	10
LCMA240-20H-X	240	185	M20	20.8	37.5	21	19.5	79.3	10
LCMA300-10H-5	300	240	M10	23.5	42.5	22	20	85.5	5
LCMA300-12H-5	300	240	M12	23.5	42.5	22	20	82.5	5
LCMA300-16H-5	300	240	M16	23.5	42.5	22	20	85.5	5
LCMA300-20H-5	300	240	M20	23.5	42.5	22	20	85.4	5
LCMAX300-10H-5 <sup>^</sup>	–	300*	M10	26.2	48	26.5	23.5	98.4	5
LCMAX300-12H-5 <sup>^</sup>	–	300*	M12	26.2	48	26.5	23.5	98.4	5
LCMAX300-16H-5 <sup>^</sup>	–	300*	M16	26.2	48	26.5	23.5	98.4	5
LCMAX300-20H-5 <sup>^</sup>	–	300*	M20	26.2	48	26.5	23.5	98.4	5

Visit [www.panduit.com/tools](http://www.panduit.com/tools) for tool and die information.

<sup>^</sup>Class 5f conductor only.

\*\*Consult cable manufacturer for voltage stress relief instructions with applications greater than 2000 V.

<sup>^</sup>Not CE compliant and not tested to EN 61238-:2003/IEC 61238-1:2003 for terminations with metric Class 5f or Class 6f flexible stranded conductor.