

Locating Bushes

• Helashrink 1760, 1790, 1820 Series

This product style provides location, cushioning, shimming and protection on cable runs through bulk head or enclosure entry points. Available in a range of materials and adhesives for most applications.



1793-1 supplied / fully recovered.

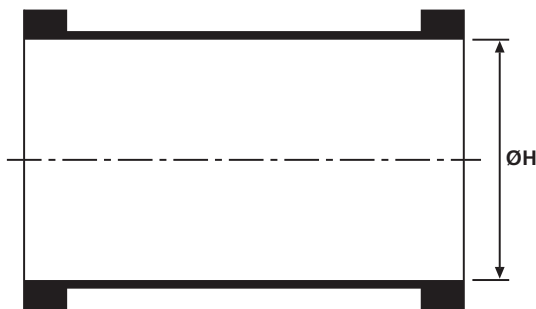

a: Expanded form (supplied)

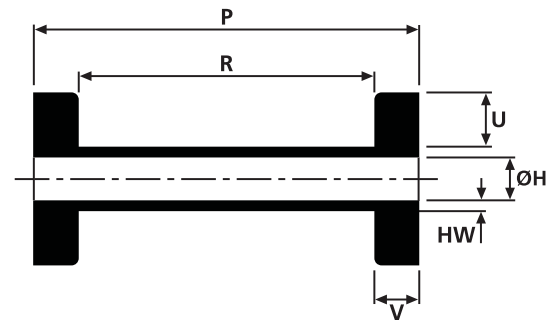

b: Fully recovered form (after heating)

Sizes and Type Table

Type	ØH min. a	ØH max. b	R ± 10%	P ± 10%	HW ± 20%	V ± 10%	U ± 20%
1793-1	20.0	9.5	25.0	35.0	1.5	5.0	3.0
1794-1	30.0	18.0	25.0	35.0	2.0	5.0	3.0
1795-1	26.0	12.7	25.0	35.0	2.0	5.0	3.0
1796-1	15.0	6.4	24.0	29.0	1.5	2.5	2.0
1822-1	12.0	5.9	24.0	30.0	6.1	3.0	2.0
1823-1	16.0	7.8	24.0	32.0	6.2	4.0	2.0

All dimensions in mm. Subject to technical changes.

For Material / Adhesive selection and other information please refer to page 10.

Combinations "On request"

Adhesive	Material				
	B7	G	J	H	L
WM250	√	√	√	√	-
W8	√	√	√	√	-
W24	√	√	√	√	√
V9500	√	√	√	√	-
HMT200A	√	√	√	√	-
W21	√	√	√	√	-
Without Adhesive	√	√	√	√	√

Standard combinations

Article-No.	Type
417-93001	1793-1-G
417-94002	1794-1-L
417-95001	1795-1-G
417-96001	1796-1-G
418-22001	1822-1-G
418-23001	1823-1-G