

VIEW CC  
BOOT REMOVED

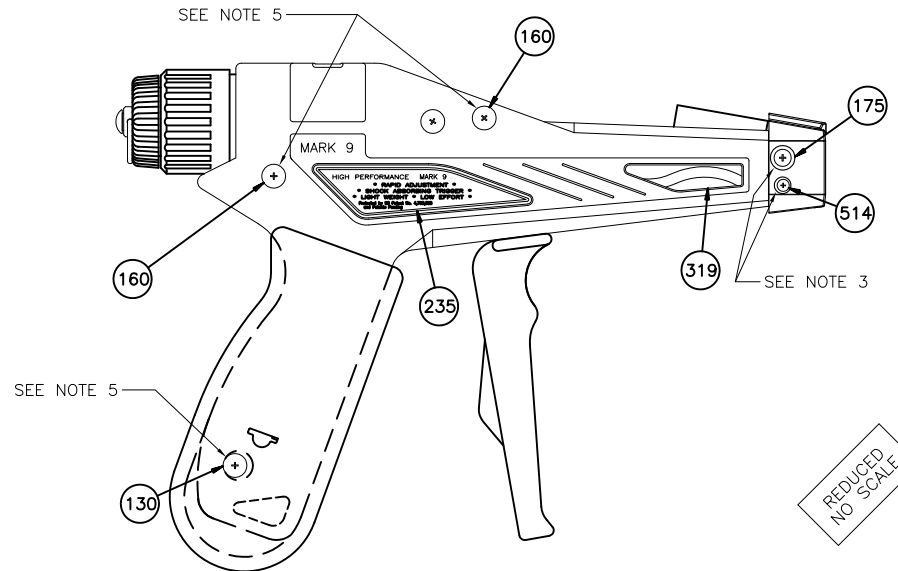
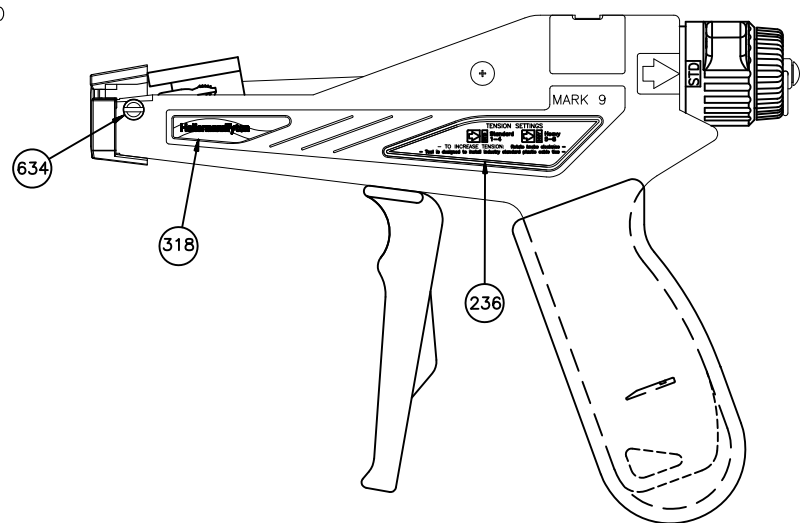

PART NUMBER	DESCRIPTION	REQ.
MK7-318	LABEL TYTON COVER SIDE	1
MK7-319	LABEL TYTON BASE SIDE	1
MK7-457	RETURN SPRING	1
MK7P-130	SCREW HANDLE NO.4-40 X 1/2 FH PHIL	1
MK7P-175	#4-40 X 5/8 FH PHIL	1
MK9-208	BOOT	1
MK9-213	CUTOFF CAM	2
MK9-223	PAWL COVER	1
MK9-225	SHAFT FRONT ROLLER	1
MK9-227	SHAFT REAR ROLLER	1
MK9-235	INFORMATION LABEL BASE	1
MK9-236	TENSION LABEL COVER	1
MK9-237	LENS	1
MK9-255	SA LABEL/CARRIER	1
MK9-257	SA PAWL LINK	1
MK9-258	SA TENSION KNOB	1
MK9-262	SA HOUSING BASE	1
MK9-263	SA HOUSING COVER	1
MK9-289	SLIDING CO CAM SHAFT	1
MK9-309	RED HANDLE GRIP	1
MK9-514	SCR LOWER NOSE #2-56 X 1/4 FH PHIL MAX NYLON PATCH	1
MK9-556	SA TRIGGER	1
MK9-634	INNER LOCKNUT	1
MK9SS-142	SA BLADE LINK	1
MK9SS-160	SCREW BODY NO.4-40 X 7/8 FH PHIL	2
MK9SS-182	FRONT SLIDER BLOCK	2
MK9SS-183	REAR SLIDER BLOCK	2
MK9SS-193	CAPTURED CO CAM SHAFT	1
904-00188	NOSEPIECE	1
904-00189	BLADE SHARPENED	1

REDUCED  
NO SCALE

**HellermannTyton**

ALL PROPRIETARY RIGHTS IN THE SUBJECT MATTER SHOWN ON THIS DRAWING ARE EXCLUSIVE PROPERTY OF HELLERMANNTYTON

name	date	city, state

- NOTES**
- 1) APPLY A LIGHT COATING OF LOCTITE 380 (BLACK MAX) TO THE TRIGGER AS SHOWN PER CROSS HATCHED AREA TO SECURE THE BLACK HANDLE GRIP.
  - 2) APPLY A LIGHT COATING OF OIL OR GREASE TO ALL FRICTION SURFACES.
  - 3) APPLY LOCTITE 222MS TO MK9-514 & MK7P-175 SCREW IN ASSEMBLED NOSEPIECE.
  - 4) A SMALL AMOUNT OF OIL OR GREASE MAY BE APPLIED TO MK9-289 SHAFT WHEN ASSEMBLING INTO HOLES OF U-BRACKET MK9-222 AND TO MK9SS-193 CAPTURE SHAFT WHEN ASSEMBLING THE TRIGGER AND BLADE LINK.
  - 5) A SMALL AMOUNT OF OIL MAY BE APPLIED TO MK9SS-160(2) & MK7P-130(1) SCREWS BEFORE ASSEMBLING INTO THE HOUSING.

**REVISION**

level	02
date	01/26/10
by	AAC
ECN #	011474
part level	-

**DIMENSIONS**

UNLESS OTHERWISE SPECIFIED  
units

**PART**

number	110-09980	phase	PRODUCTION
name	FINAL ASSEMBLY MK9RC ROUND CUT		
material	SEE INDIVIDUAL DRAWINGS		

**DRAWING**

FORMAT C version L	CAD	ACAD	scale	1X
computer file number	TS\ASM\2018661_02	previous number		
date	A.A.C.	W.K.L.	approved	
	10/12/07	01/26/10		
type	ASSEMBLY		sheet	1 of 1
number	TS2018661ASM			