

# MAX<sup>®</sup> MODULES TOOL-LESS

The tool-less MAX module provides category 5e system performance and user-friendly installation features. Our tool-less termination allows all eight conductors to be terminated simultaneously when the termination cap is pressed into place. The compact size provides high-density connectivity in the work area and telecommunications room.



**PATENTED**

WORK AREA

A smoke-color tint increases visual identification of the termination cap details



No termination tools required, minimizing termination time

Icons tabs available in 13 colors for color-coding

Slim design allows outlet to be side-stackable to provide high-density solutions

Outlet opening is compliant with IEC 60603-7 standard

Patented multi-planar<sup>™</sup> pair balancing technology

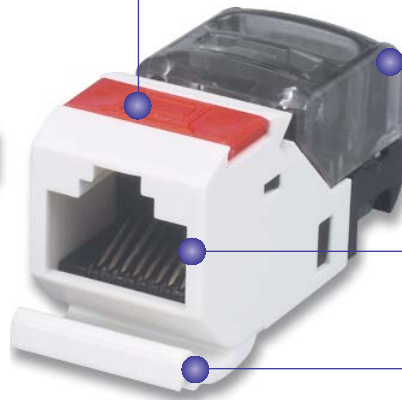

Flexible mounting tab allows installation from front or rear of faceplate and secures module into the faceplate with or without the use of the protective rubber door



MAX 5e modules are now available in many new colors, ideal for color-coding

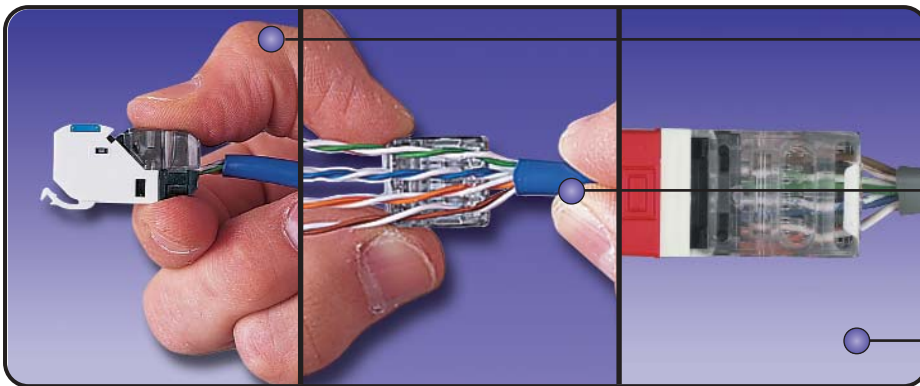

Mass terminate all eight conductors by hand or use a single-position S110<sup>®</sup> termination tool in the MAX termination cap

Conductors can be sequentially placed into termination cap, minimizing cable pair untwist and simplifying termination

The termination cap has a large window for viewing terminations

# ORDERING INFORMATION

WORK AREA

## Tool-Less MAX® Modules

### Angled Max modules:

The angled MAX modules provide a "gravity-feed" style design and minimal rear clearance, ideal for modular furniture, raceways and other installations.

MX-C5-(XX) .....  
Angled module with T568A/B wiring



### Flat Max modules:

The flat MAX modules are a flush-mount module suitable for work area or telecommunications room applications.

MX-F-C5-(XX) .....  
Flat module with T568A/B wiring



### Keystone Max modules:

The keystone MAX module provides a solution for installations where a standard keystone-style opening exists.

MX-K-C5-(XX) .....  
Keystone module with T568A/B wiring



Use (XX) to specify color: 01 = black, 02 = white, 03 = red, 04 = gray, 05 = yellow, 06 = blue, 09 = orange, 20 = ivory, 25 = bright white, 80 = light ivory, 82 = alpine white  
Add "-D" for optional door for angled and flat versions.

Door color is white for red, yellow, blue, and orange flat modules; clear for angled.

ⓑ Add "B" to end of part number for bulk project pack of 100 modules

Flat and angled modules include one color-matching, one red and one blue icon.

Note: Keystone version is designed for integration with various international mounting products and is not compatible with MAX mounting hardware.

### MAX Outlet Blanks and Doors:

Blank inserts for unused ports and future growth and doors to protect outlets from outside contaminants.

MX-BL-(XX) ..... Blank module, bag of 10  
MX-FD-(XX) ..... Door assembly for flat 6- or 8-position outlets, bag of 20  
MX-AD-(XX) ..... Door assembly for angled 6- or 8-position outlets, bag of 20



Use (XX) to specify color: 01 = black, 02 = white, 04 = gray, 20 = ivory, 25 = bright white, 80 = light ivory

### Accessories:

CT-ICON-(XX) ..... 25 colored icon tabs (phone on one side, computer on reverse)  
TAB-(XX) ..... 25 colored blank tabs  
CT-ICON-LBL\* ..... 10 label sheets for clear tabs that will fit any standard 8.5 x 11 printer, 168 labels per sheet

Use (XX) to specify color: 00 = clear (TAB-XX only), 01 = black, 02 = white, 03 = red, 04 = gray, 05 = yellow, 06 = blue, 07 = green, 08 = violet, 09 = orange, 20 = ivory, 25 = bright white, 60 = brown, 80 = light ivory

ⓑ Add "-B" for bulk pack of 100 icons or tags.

\*Visit our web site or contact our Technical Support Department for labeling software



Because we are continuously improving our products, The Siemon Company reserves the right to change specifications and availability without prior notice.

MAX®, S110® and Multi-planar™ are trademarks of The Siemon Company

### For related product information request Spec Sheet(s):

MAX Series Modular Faceplates (PROD-SS-MXF)  
MAX Series Patch Panels (PROD-SS-MXP)  
Termination Tools (PROD-SS-S78)

**The Americas**  
Watertown, CT USA  
Phone (1) 860 945 4200

**Europe/Middle East/Africa**  
Surrey, England  
Phone (44) 0 1483 480040

**Asia/Pacific**  
Shanghai, P.R. China  
Phone (86) 21 6390 6778

WWW.SIEMON.COM

ISO 9001  
CERTIFIED

ISO 14001  
CERTIFIED

