



This document contains proprietary and confidential information of Northwire, Inc. (and its subsidiary) and shall not be used, disclosed or reproduced, in whole or in part, for any purpose without the prior written consent of Northwire, Inc. (and its subsidiary).

Disclaimer: The technical data that is made part of this document may be subject to the International Traffic in Arms Regulation (ITAR) and the Export Administration Regulations (EAR). Disclosure of technical data to Foreign Persons in the course of employment with U.S. contractors is considered an export and is subject to the ITAR and EAR export licensing requirements/regulations.

DESC: 16/1 LEAD WIRE 80C 300V

CUSTOMER: IEWC

CUST. P/N: SEE PAGE 2

NWI P/N: SEE PAGE 2

DRAWN: DP LANGER

UNITS: IN

SCALE: 24:1

DWG NO: 46531A-1

DATE: 10/18/2013

REV: B

ITEM	SPECIFICATIONS
A.	16 GAUGE 26x30BC BUNCHED
B.	WATER BLOCKING TAPE/RIBBON SEPARATOR
C.	40 MIL PRESSURED TPU JACKET 80C 300V 35 MIL MIN. POLYLURETHANE JACKET RODENT REPELLENT ADDITIVE IN JACKET NO AGENCY APPROVALS
	SEE PAGE 2 FOR JACKET COLORS
	ROHS COMPLIANT MATERIALS TO EU DIRECTIVE 2011/65/EU

CORE DIMENSIONS FOR INTERNAL USE ONLY

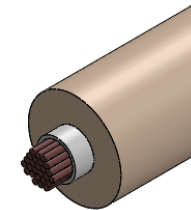
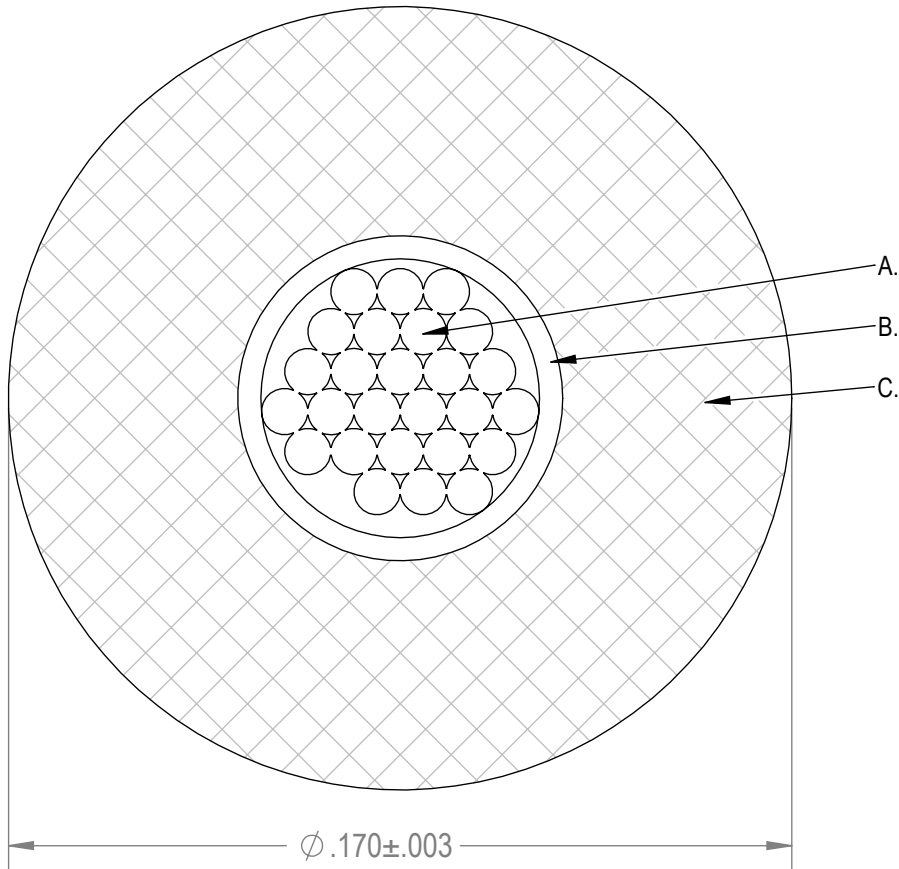

ISOMETRIC VIEW FOR REFERENCE ONLY

LEGEND SPECIFICATIONS NO LEGEND ON CABLE



This document contains proprietary and confidential information of Northwire, Inc. (and its subsidiary) and shall not be used, disclosed or reproduced, in whole or in part, for any purpose without the prior written consent of Northwire, Inc. (and its subsidiary).

Disclaimer: The technical data that is made part of this document may be subject to the International Traffic in Arms Regulation (ITAR) and the Export Administration Regulations (EAR). Disclosure of technical data to Foreign Persons in the course of employment with U.S. contractors is considered an export and is subject to the ITAR and EAR export licensing requirements/regulations.

DESC: 16/1 LEAD WIRE 80C 300V

UNITS: IN

SCALE: 60:1

ELECTRICAL REQUIREMENTS

CUSTOMER: IEWC

NWI P/N: SEE PAGE 2

DWG NO: 46531A-1

NONE SPECIFIED

CUST. P/N: SEE PAGE 2

DRAWN: DP LANGER

DATE: 10/18/2013

REV: B

IEWC PART NO:	NWI PART NO:	JACKET COLOR
PU16B26-1	FCAB161-036	RED
PU16B26-0	FCAB161-037	BLACK
PU16B26-3	FCAB161-038	BLUE
PU16B26-4	FCAB161-039	YELLOW



MECHANICAL REQUIREMENTS

NONE SPECIFIED

CHANGED TO NEW DRAWING FORMAT; ADDED FCAB161-037 TO -039	B	4/1/14	DPL
INITIAL RELEASE	A	10/18/13	DPL
REVISION RECORD	REV.	REV DATE	APR
REVISIONS			