

PROPRIETARY RIGHTS ARE CLAIMED FOR THE MATERIAL DISCLOSED IN THIS DRAWING.

PART NO. 1360-104				
TITLE Red Battery Cable Boot				
CUSTOMER STANDARD				
ENGLISH (IN)				SCALE 1:1
REV #	REVISION	DATE	BY	APPROVE
X0	INITIAL RELEASE	11-21-2012		

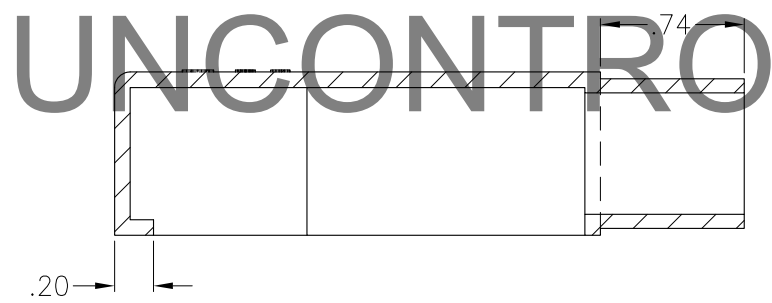
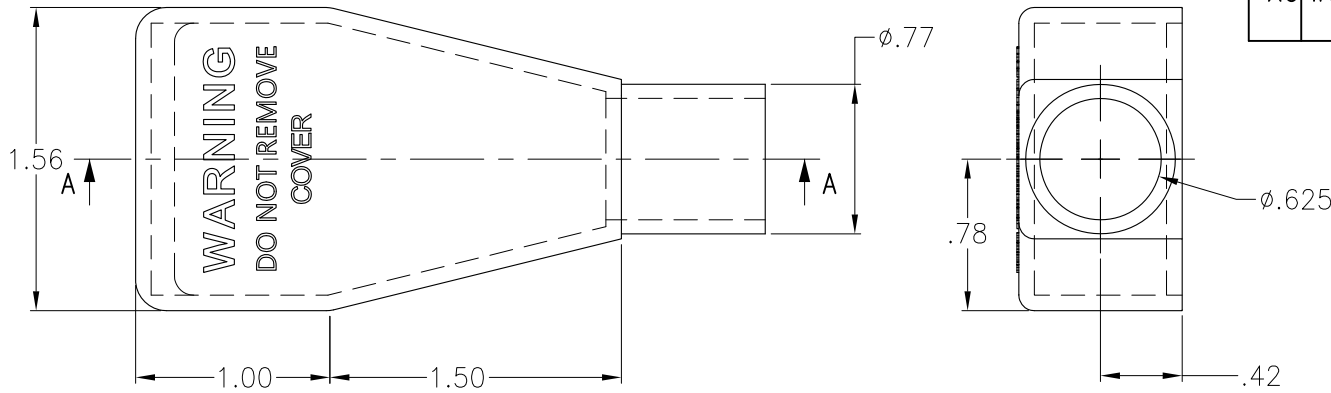

SECTION A-A

UNCONTROLLED DOCUMENT

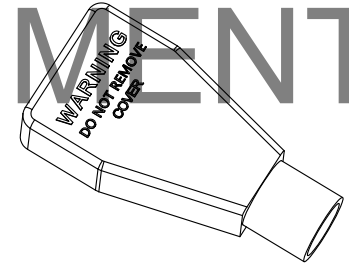

VTE Material Part No: 1101650102.  
 Material: RED PVC;  
 Material Part No: 9812-65-RED683  
 Max. Operating Temp: 105 C  
 Shore Durometer: "A" 10 SEC. 67/63  
 Specific Gravity: 1.34  
 Ult. Elongation %: 475  
 Brittle Temp: -44 C  
 Tensile Strength PSI: 1547 PSI  
 Dielectric Strength v./ml: 540  
 U.L. Rating: 94 V2  
 MEETS: FMVSS.302

TOLERANCE UNLESS OTHERWISE SPECIFIED:  $\pm 0.030$ " /  $\pm 0.8$ mm  
 RADIAL DIAMETERS TO BE MEASURED OVER MANDRELS,  
 RING GAGES OR PIN GAGES OF SUITABLE SIZE.



CONFIDENTIAL — The information contained in this document is the property of GEP Power Products. It is not for public disclosure. Possession of the information does not convey any right to loan, sell or disclose the information. Unauthorized reproduction or use of the information is prohibited. This document is to be returned to GEP Power Products upon completion of the purpose for which it is loaned or upon request.

COPYRIGHT — GEP Power Products  
 This is an unpublished work. The disclosure of this work is limited to a select personnel. Further dissemination or disclosure to the public is PROHIBITED. This unpublished work is protected by Federal Copyright law and all rights thereunder are reserved by GEP Power Products.

TOLERANCES UNLESS OTHERWISE SPECIFIED	
METRIC TOL	ENGLISH TOL
1 PL DEC.= $\pm .25$	2 PL DEC.= $\pm .01$
2 PL DEC.= $\pm .13$	3 PL DEC.= $\pm .005$

THIRD ANGLE PROJECTION
ANGULAR TOL= $\pm 2^\circ$ FRACTION TOL= $\pm 1/64$ IN