

## 3Gbit SDI to HDMI Converter

- Supports SDI video inputs up to 3Gbit/s (1080p60)
- Automatic input standard and format detection
- Fiber input and output option
- HDMI video output with embedded audio
- Analog and AES audio outputs
- Select audio from 16 input channels
- Balanced professional analog audio outputs or unbalanced line level audio outputs
- Selectable Timecode burn in windows
- Selectable Metadata indication
- 16 channel on screen audio metering
- Video and Audio present LED indication

The CDH 1811 is a versatile, compact SDI to HDMI converter designed to combat a host of monitoring and display applications in Broadcast, Post Production and Pro A/V markets.

Convert any SDI video signal into a standard HDMI signal for monitoring and display. Optional fiber interface allows the module to be used for monitoring fiber connections and also function as a SDI to fiber converter. The HDMI output displays the native input resolution therefore no scaling artifacts are introduced.

Two channels of audio can be de-embedded from the incoming video signal and provided as digital AES outputs and analog audio signals. Balanced audio outputs have selectable full scale range presets. The two selected audio channels can also be embedded into the HDMI output, or 8 channels selected from the input signal (channels 1-8 or channels 9-16).

A selectable time-code burn in window and 16 on screen audio meters makes the module ideal for editing and monitoring applications, with a mode to also indicate key metadata information as well as AFD code on screen.

### Option

**OH-OTR-1 Fiber Transceiver Stick** - Provides fiber input and re-clocked fiber loop output up to 10Km (6.2 miles) @ 3Gbits/s



### Technical Specifications

<b>SDI Input</b>	1 x SDI video on 75 Ohm BNC connector SMPT E 424M, SMPT E 292M, SMPT E 259M Multi-standard operation from 270Mbit/s to 3Gbit/s SDTV (525/625) 720p and 1080p (23.98/24/25/29.97/30/50/59.94/60 Hz) 1080psf (23.98/24/25/29.97/30 Hz) 1080i (50/59.94/60 Hz) Return Loss: > 15dB to 1.5GHz and > 10dB up to 3GHz Automatic cable EQ (Belden 1694A cable) 250m @ 270Mbit/s, 140m @ 1.5Gbit/s, 80m @ 3Gbit/s
<b>Optical Input</b>	1 x fiber optic input. Singlemode (OH OTR 1 option) LC/PC fiber connection (wavelength 1310nm). RX Sensitivity -19dBm SMPT E 297M - 2006
<b>SDI Output</b>	1 x SDI video on 75 Ohm BNC connector SMPT E 424M, SMPT E 292M, SMPT E 259M Multi-standard operation from 270Mbit/s to 3Gbit/s
<b>Optical Output</b>	1 x fiber optic output. Singlemode (OH OTR 1 option) LC/PC fiber connection (wavelength 1310nm). TX Power -3dBm SMPT E 297M - 2006 Max. distance 10Km (6.2 miles) @ 3Gbit/s (Singlemode)
<b>HDMI Output</b>	Version 1.4 (deep color) type A connector 24 bit (3X8bit) and 30bit (3x10bit) deep color (R,G,B / Y,Cr,Cb / X,Y,Z) 2 or 8 channel audio embedding (selectable)
<b>AES Output</b>	AES3id on 75 Ohm BNC, 2 channels (selectable)
<b>Audio Output</b>	Left and right analog audio using 1/4 inch Jack plugs Balanced mode with 24,22,20,18,15,12 dBu full scale (selectable) Unbalanced mode with (line level) at -10 dBV 1/4 inch Jack Plug to RCA connection adapters supplied
<b>Power</b>	+12VDC power supply (included)
<b>Size</b>	105mm x 40mm x 22mm (4.13" x 1.57" x 0.86")
<b>Model #</b>	CDH 1811
<b>Includes</b>	Module, power supply, RCA adapters, HDMI cable and mounting brackets

Specifications subject to change

## Timecode and Metadata Overlay

Overlay timecode burn-in windows, 16 audio level meters plus display of the presence of key metadata parameters in the incoming SDI stream. Modes are OFF (no overlay on image), Timecode ON (display of timecode only), Metadata ON (Metadata only) or both ON - (both modes ON is shown below). **Note.** Overlay is only present on the HDMI output.

SDI Input format, resolution and bit depth

Timecode Burn-in. (The module can detect and display the following Timecode formats: ATC-VITC, ATC-LTC and DVI-TC Timecode. Only the formats present in the SDI input will be displayed).

AFD code display (if present)



G1-G4 Audio presence detection and audio meters (16 channel)  
(G = SDI audio group = 4 channels)

WSS (Wide Screen Signal), VI, AFD and CC (Closed Captions)  
Highlighted if present

## OH OTR 1 - Fiber Transceiver Option

This option allows the module to be used with an electrical SDI input or a fiber input signal. (selected via dip switch), the module will provide both a fiber and electrical SDI output of the selected input signal. Fiber outputs can be transmitted up to 10km (6.2miles) @ 3Gbit/s. Signal flow is shown below:

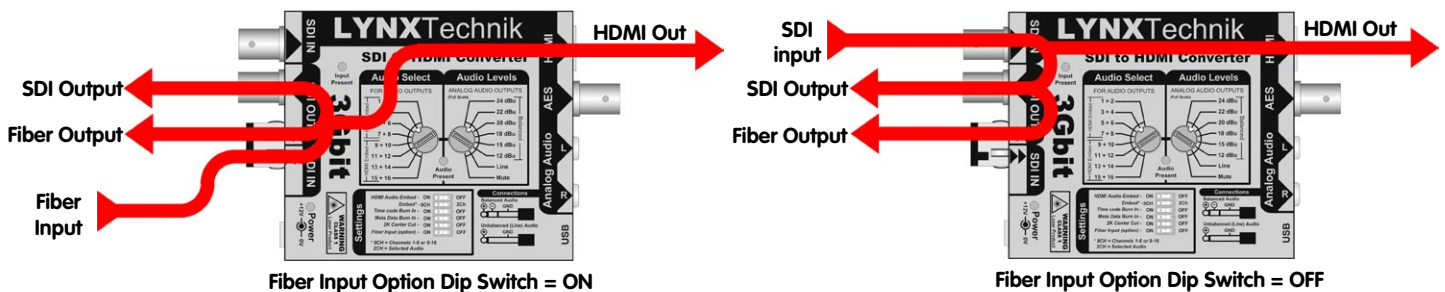

## Fiber Application Using CDH 1811 SDI to HDMI Converter

Sample application using two CDH 1811 modules for SDI fiber optic transmission up to 10km (6.2 miles) @3Gbit/s with integrated HDMI signal confidence monitoring at each end.

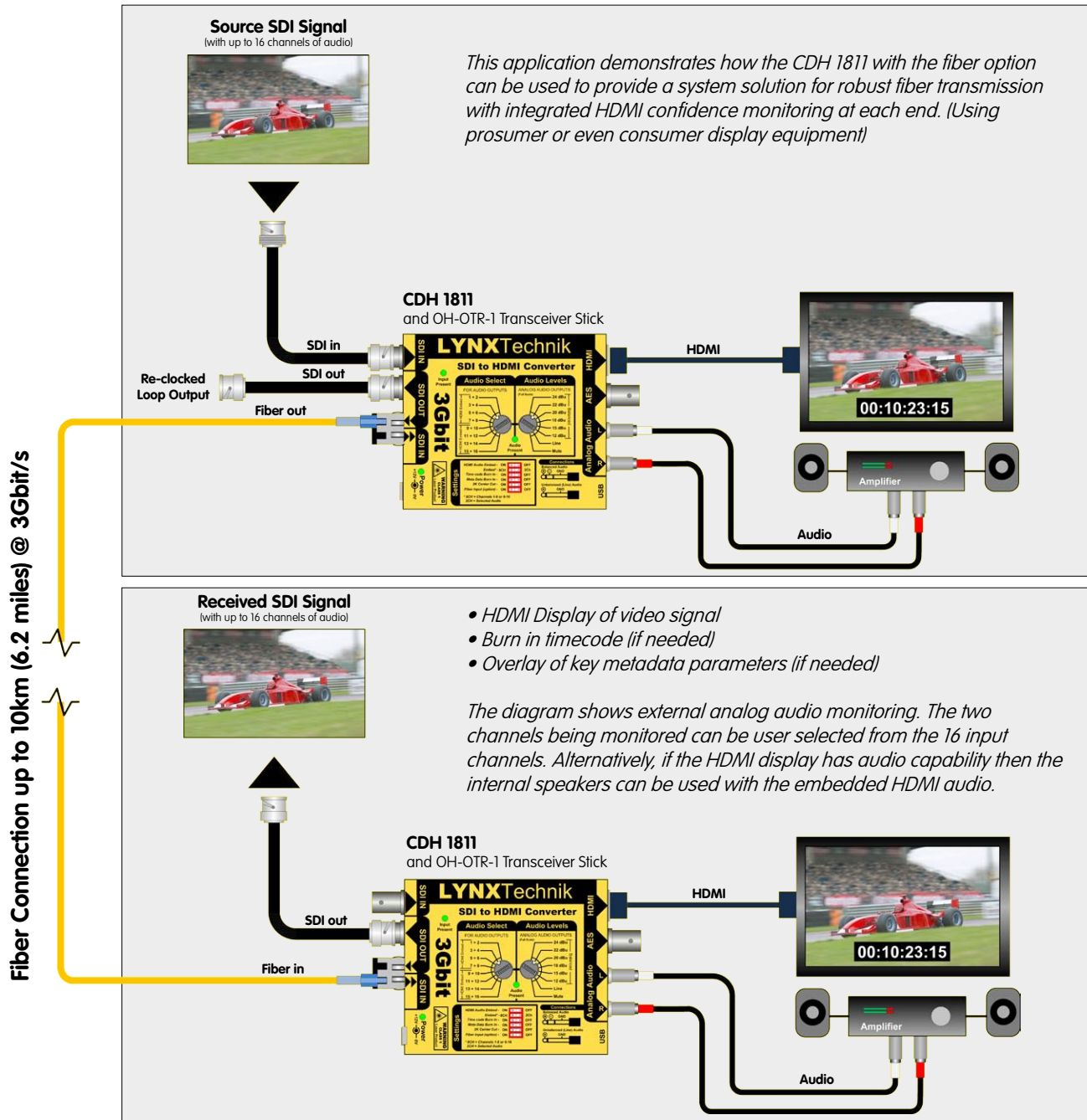

## Application Using CDH 1811 SDI to HDMI Converter

Typical application for the CDH 1811 module. Module is "looped" into an SDI signal path providing a HDMI monitoring output.

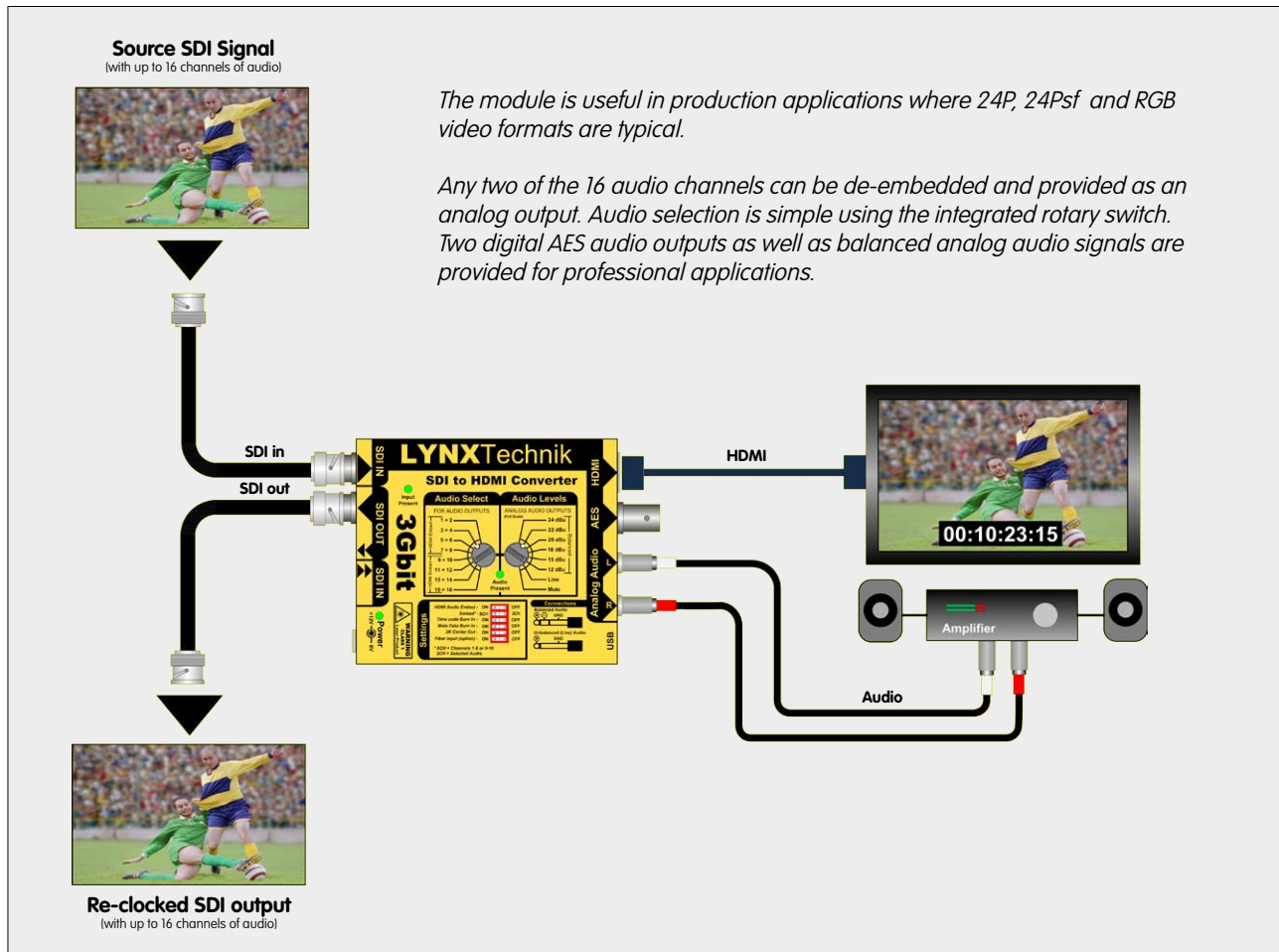

### Ordering Information



#### CDH 1811 - SDI to HDMI Converter

The CDH 1811 yellobrik is supplied in its own plastic transport case and includes the following items:

- CDH 1811 yellobrik Module
- Power Supply
- HDMI cable
- Module mounting brackets
- 2 x Phono to RCA audio adapters
- Quick reference guide
- 3 year warranty registration card

### Option



#### OH-OTR-1

Fiber Optic Transceiver Stick