

NAC3MX-W

Locking male cable connector, screw terminals

The powerCON TRUE1 is a locking waterproof 16 A true mains connector. It replaces appliance couplers wherever a very rugged solution in combination with a locking device is needed in order to guarantee a safe power connection.

The powerCON TRUE1 is a connector with breaking capacity (CBC), i.e. it can be connected or disconnected under load or live.



Features & Benefits

- True mains connector with breaking capacity (CBC)
- Lockable 16 A single phase connector (USA: 20 A)
- Dust and water resistant according to IP65 in mated condition
- Easy and reliable twist lock system
- Extremely robust and reliable
- Unique Neutrik cable retention
- ENEC certified according to IEC 60320
- UL recognized components

Image gallery

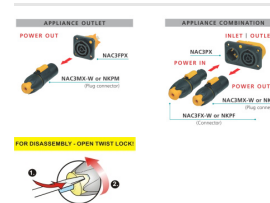

Technical Information [hide](#)

Product	
Title	NAC3MX-W
Electrical	
Contact resistance	≤ 3 mΩ
Dielectric strength	4 kVdc / 2.8 kVac
Insulation resistance	0,1 GΩ (after damp heat test IEC 68-2-30)
Number of electrical contacts	2 + PE
Rated current per contact	16 A rms (USA: 20 A)
Rated voltage	250 V ac
Mechanical	
Cable O.D.	6 - 12 mm
Lifetime	> 5000 mating cycles
Wiresize	1.0 - 2.5 mm ²
Wiresize	12 AWG
Material	
Contact plating	2 μm Ag
Contacts	CuNi1Si0.2
Insert	Polyamide (PA 6.6 30 % GR)
Locking element	ZuAl4Cu1

Shell	Polyamide (PA 6.6 30 % GR)
Strain relief	Polyacetal (POM)
Environmental	
Flammability	UL 94 V-0
Protection class	IP 65 (mated)
Temperature range	-30 °C - +80 °C

Accessories

HTAC

