

Dealing with foreign products?
Is connecting a challenge?
Well, look no further!

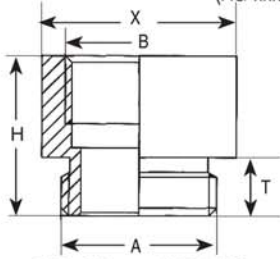
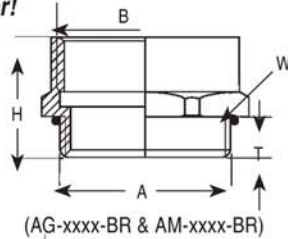

(AF-xxxx-BR, AP-xxxx-BR & AG-xxxx-AL)

More custom parts available online at www.sealconusa.com or upon request!

Operating Temperature (Nickel Plated Brass Adapters with O-Ring):
-40 °C to 100 °C (-40 °F to 212 °F)

Thread Adapters: NPT to PG Threads*

Part Numbers	Threads		Dimensions in Inches (mm)		
	Male Thread A	Female Thread B	W	T	H
			Wrench Flat	Thread Length	Height
					
AN-1407-BR	1/4" NPT	PG 7	.75 (19)	.59 (15)	.98 (25)
AN-1209-BR	1/2" NPT	PG 9	.98 (25)	.79 (20)	1.18 (30)
AN-1211-BR	1/2" NPT	PG 11	.98 (25)	.79 (20)	1.18 (30)
AN-1213-BR	1/2" NPT	PG 13 / 13.5	.98 (25)	.79 (20)	1.18 (30)
AN-1221-BR	1/2" NPT	PG 21	1.30 (33)	.79 (20)	1.26 (32)
AN-3421-BR	3/4" NPT	PG 21	1.30 (33)	.67 (17)	1.22 (31)
AN-1029-BR	1" NPT	PG 29	1.61 (41)	.98 (25)	1.57 (40)
AN-5429-BR	1-1/4" NPT	PG 29	1.69 (43)	.94 (24)	1.34 (34)

*Note: O-Ring not Included

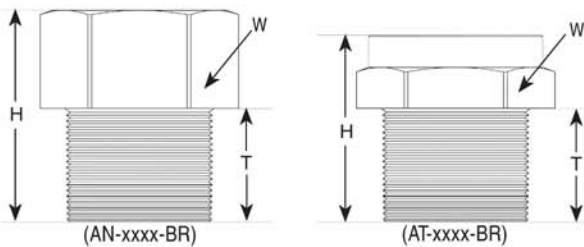

Thread Adapters: NPT to Metric Threads*

Part Numbers	Threads		Dimensions in Inches (mm)		
	Male Thread A	Female Thread B	W	T	H
			Wrench Flat	Thread Length	Height
					
AT-1216-BR	1/2" NPT	M16 x 1.5	.98 (25)	.79 (20)	1.18 (30)
AT-1220-BR	1/2" NPT	M20 x 1.5	.98 (25)	.79 (20)	1.18 (30)
AT-1225-BR	1/2" NPT	M25 x 1.5	1.26 (32)	.79 (20)	1.18 (30)
AT-3425-BR	3/4" NPT	M25 x 1.5	1.24 (31.6)	.75 (19)	1.18 (30)
AT-1032-BR	1" NPT	M32 x 1.5	1.50 (38)	.98 (25)	1.61 (41)
AT-5432-BR	1-1/4" NPT	M32 x 1.5	1.67 (42.5)	.59 (15)	1.30 (33)

*Note: O-Ring not Included

Thread Adapters: PG to NPT Threads

Part Numbers		Threads		Dimensions in Inches (mm)		
Nickel Plated Brass w/ Buna-N O-Ring	Aluminum	Male Thread A	Female Thread B	W	T	H
				Wrench Flat	Thread Length	Height
AG-0912-BR*	AG-0912-AL*	PG 9	1/2" NPT	.94 (24)	.24 (6)	.94 (24)
AG-1112-BR	-	PG 11	1/2" NPT	.94 (24)	.24 (6)	.89 (22.7)
AG-1312-BR	-	PG 13 / 13.5	1/2" NPT	.94 (24)	.26 (6.5)	.93 (23.5)
AG-1612-BR	-	PG 16	1/2" NPT	.94 (24)	.26 (6.5)	.91 (23)
AG-2112-BR	-	PG 21	1/2" NPT	1.18 (30)	.28 (7)	.59 (15)
AG-2134-BR	-	PG 21	3/4" NPT	1.18 (30)	.28 (7)	.94 (24)
AG-2910-BR	-	PG 29	1" NPT	1.57 (40)	.31 (8)	.79 (20)

*Note: O-Ring not Included

Thread Adapters: PG to Metric Threads*

Part Numbers	Threads		Dimensions in Inches (mm)		
	Male Thread A	Female Thread B	X	T	H
			Outer Diameter	Thread Length	Height
					
AP-0916-BR	PG 9	M16 x 1.5	.79 (20)	.24 (6)	.65 (16.5)
AP-1120-BR	PG 11	M20 x 1.5	.87 (22)	.26 (6.5)	.75 (19)
AP-1320-BR	PG 13/13.5	M20 x 1.5	.87 (22)	.26 (6.5)	.75 (19)
AP-1625-BR	PG 16	M25 x 1.5	1.06 (27)	.26 (6.5)	.83 (21)

*Note: O-Ring not Included

Thread Adapters: Metric to PG Threads*

Part Numbers	Threads		Dimensions in Inches (mm)		
	Male Thread A	Female Thread B	X	T	H
			Outer Diameter	Thread Length	Height
					
AF-1609-BR	M16 x 1.5	PG 9	.79 (20)	.24 (6)	.65 (16.5)
AF-2011-BR	M20 x 1.5	PG 11	.87 (22)	.26 (6.5)	.75 (19)
AF-2013-BR	M20 x 1.5	PG 13 / 13.5	.87 (22)	.26 (6.5)	.75 (19)
AF-2016-BR	M20 x 1.5	PG 16	.94 (24)	.26 (6.5)	.75 (19)
AF-2516-BR	M25 x 1.5	PG 16	1.10 (28)	.26 (6.5)	.75 (19)
AF-2521-BR	M25 x 1.5	PG 21	1.18 (30)	.26 (6.5)	.83 (21)
AF-3229-BR	M32 x 1.5	PG 29	1.54 (39)	.28 (7)	.91 (23)

*Note: O-Ring not Included

Thread Adapters: Metric to NPT Threads

Part Numbers	Threads		Dimensions in Inches (mm)		
	Male Thread A	Female Thread B	W	T	H
			Wrench Flat	Thread Length	Height
					
AM-1612-BR	M16 x 1.5	1/2" NPT	.94 (24)	.24 (6)	.91 (23)
AM-2012-BR	M20 x 1.5	1/2" NPT	.94 (24)	.24 (6)	.91 (23)
AM-2512-BR	M25 x 1.5	1/2" NPT	1.18 (30)	.28 (7)	.59 (15)
AM-2534-BR	M25 x 1.5	3/4" NPT	1.18 (30)	.28 (7)	1.07 (26)
AM-3210-BR	M32 x 1.5	1" NPT	1.57 (40)	.31 (8)	1.30 (33)
AM-3254-BR	M32 x 1.5	1-1/4" NPT	1.81 (46)	.31 (8)	1.30 (33)

See page 49 for thread specifications.

Nylon Strain Relief
Nickel Plated Brass
PVDF / Steel
Accessories
Adapter, Reducer, Enlarger
Conduit System
Technical Information
Other Products / Index